

New 700er Light shaft

New light shaft

Load and installation

Load during the installation

- ❖ Light shaft installed 2 screws
- ❖ Grating is in the correct position
- ❖ Fill the Excavation in layers with gravel
- ❖ Compression pressure 2.000 kg

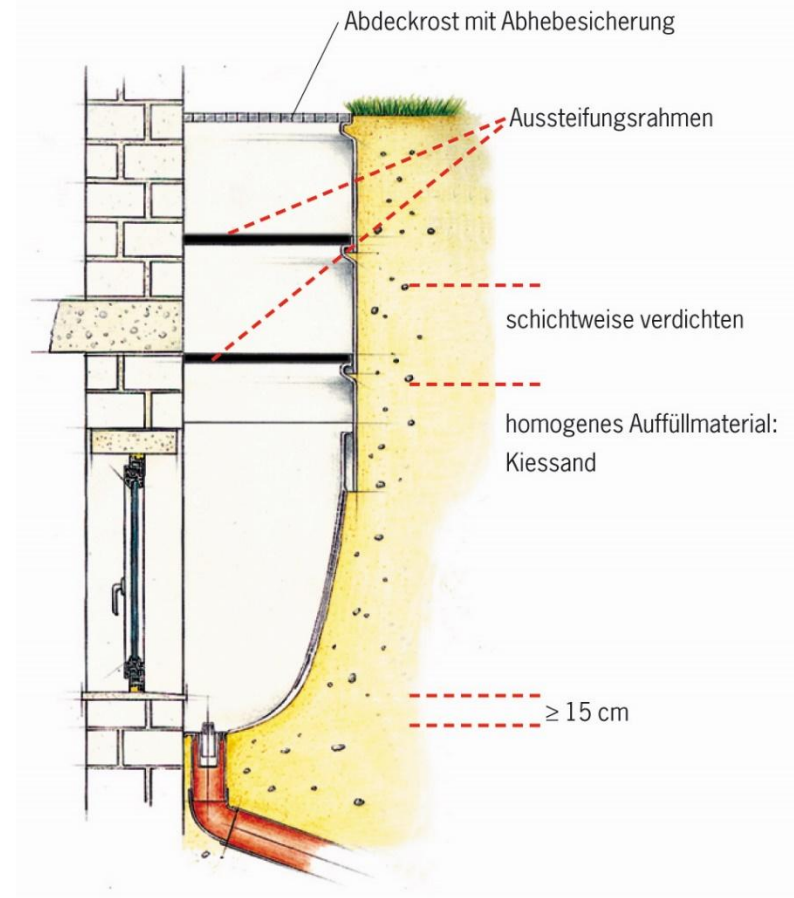

New light shaft

Load and installation

Load: **walk able**

Test:

⇒ Load 200kg in the middle of the grating
on a test block 200x200mm

These is the first FEA Test.

- ❖ Light shaft installed but no gravel around
- ❖ Grating in position

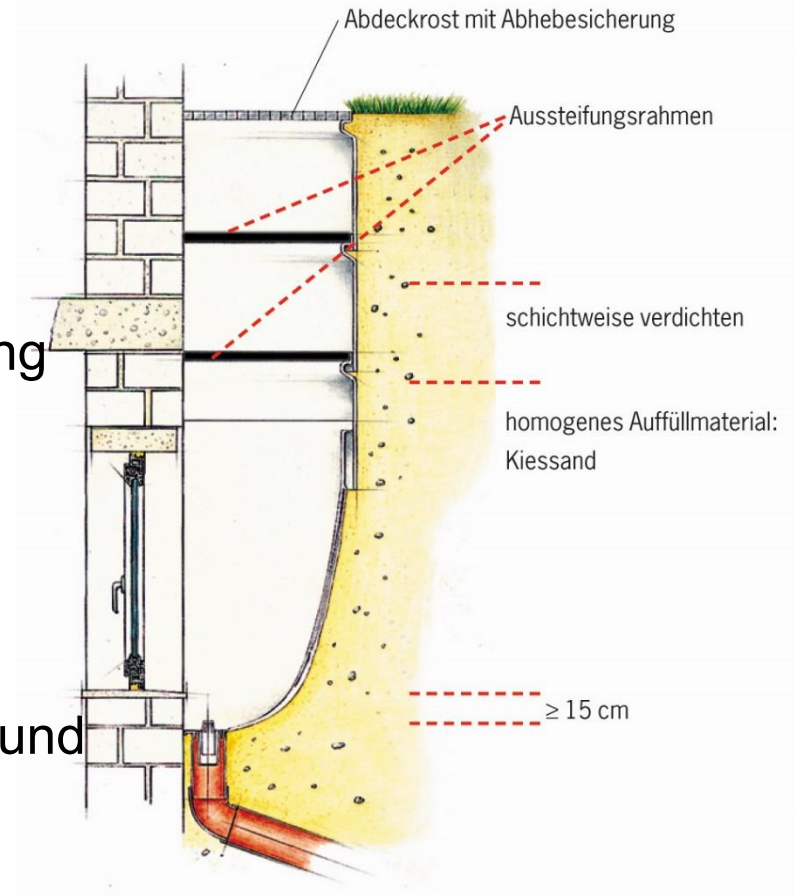

New light shaft

Load and installation

Load: **water load**

Test:

⇒ Load: water level 540mm above grate support, measure the deflection with the water load after 5min, 1 hour, 12 hours and 24 hours.

These is the second FEA Test.

⇒ on the photo you see only the light shaft without extension elements

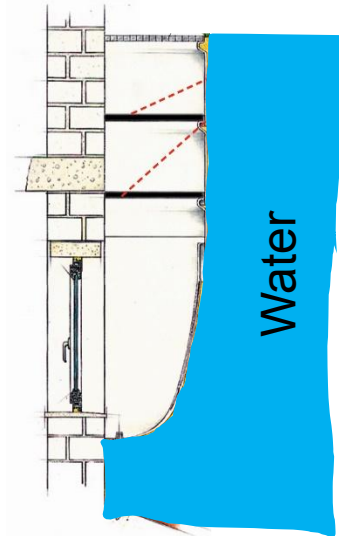

New light shaft

Load and installation

Load: **water load**

Test:

- ❖ Light shaft installed in a concrete basin but no gravel around, 2 fix extension elements installed water tight.
- ❖ No grating
- ❖ Lightshaft in front of an opening that it is possible to measure the deflection.

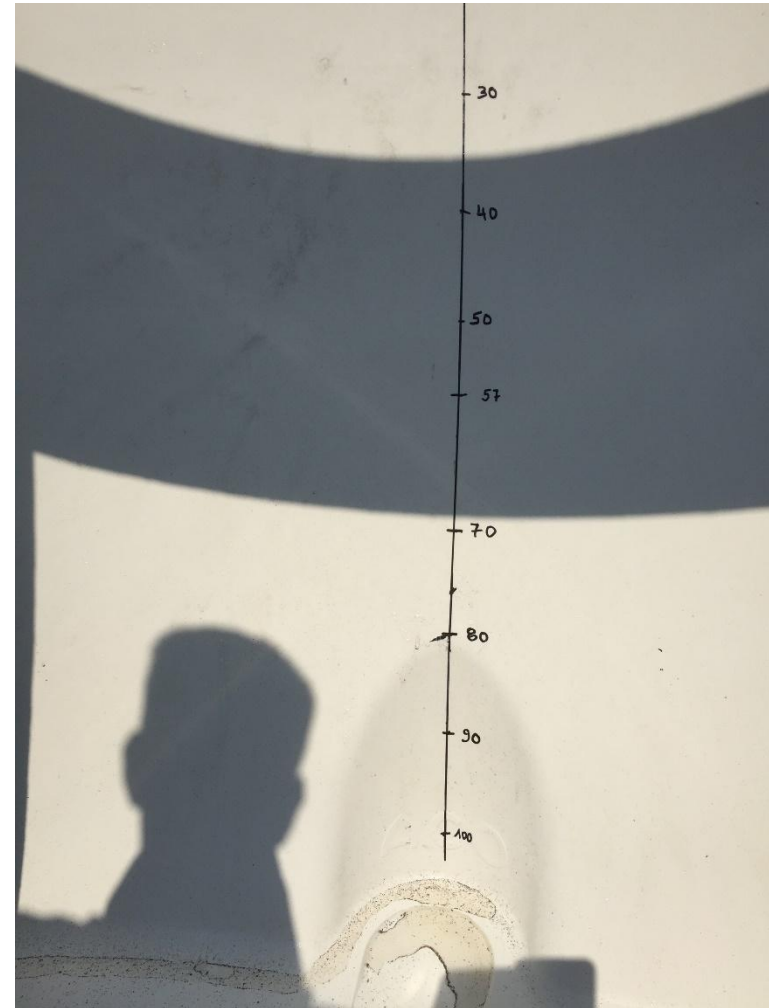

New light shaft

Load and installation

Load: **drive able**

Test 1:

⇒ Load 1000kg in the middle of the grating on a test block 200x200mm

❖ Light shaft installed but no gravel around

❖ Grating (drive able) in position

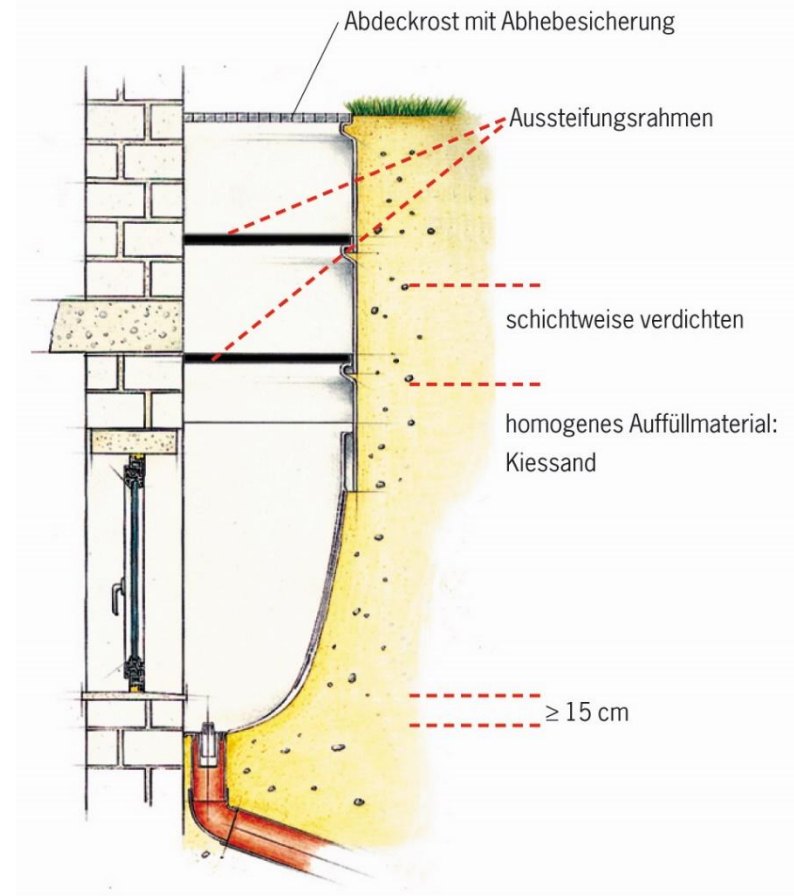

New light shaft

Load and installation

Load: **drive able**

Test 2:

⇒ Load 1000kg in the middle of the grating on a test block 200x200mm

❖ Light shaft installed with gravel around

❖ Grating (drive able) in position

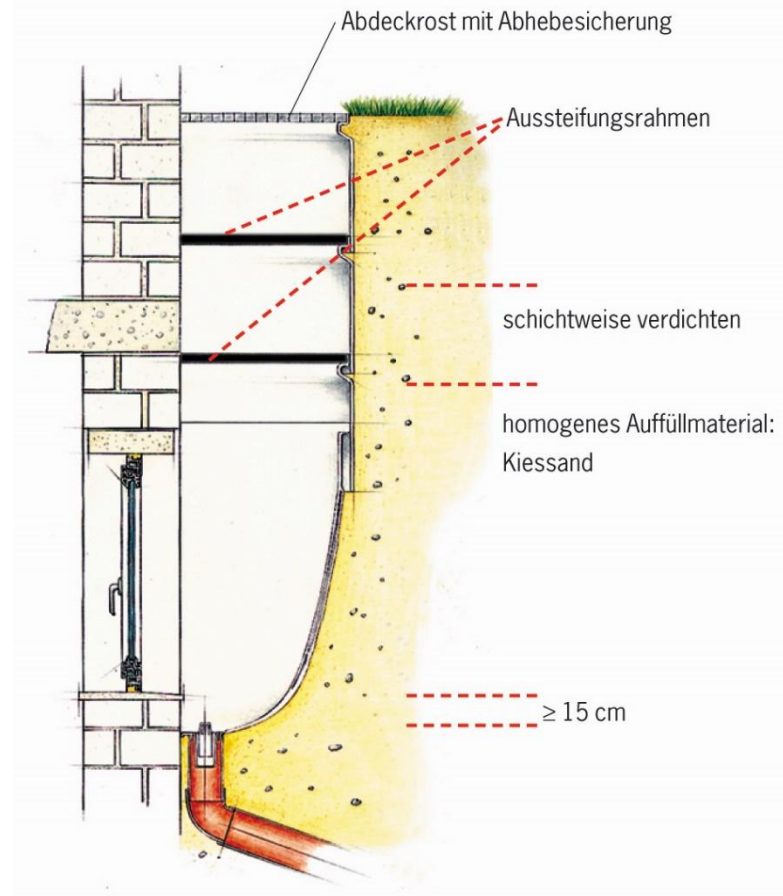

New light shaft

Load and installation

Load: **drive able**

Test 2:

⇒ Load 900kg just beside the grating in the middle of the light shaft on a test block 200x200mm

❖ Light shaft installed with gravel around

❖ Grating (drive able) in position

