

A major part of the joiners work in building a house is in the construction of the roof and leaving it ready for the roofers to fix the felt, lathes and slates

Ceiling joists at roof level



Joists supported by a steel beam



Joists supported on the wall plate



Ceiling joists with steel beam



Ceiling joists, roof joists and wall plate



Roof taking shape



Joist detail over end wall

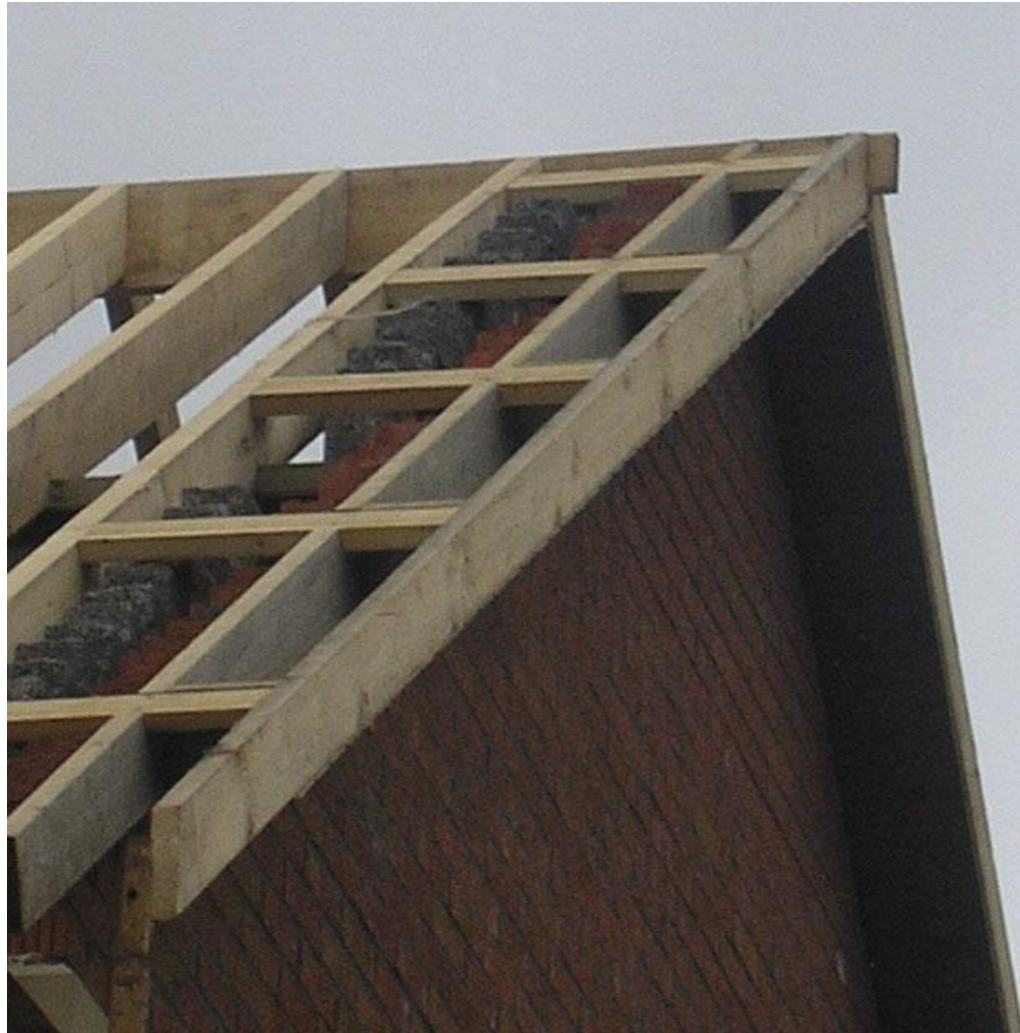

Bridging over an wall



Valley boards in position



Fixings to hold wall plate in position



Fixing the soffits boards



Soffit boards in position



Facia boards fitted



More detail at fascia boards



Ventilation aid behind fascia boards



Detail at a purlin



Hangers to support the ceiling joists



Fitting the barge boards



Bargeboard and soffit finished



Roof joists ready for slates



Roof stabiliser straps in position



Roof flashing in position



Skylight in position

