

Portfolio by Ilya Nemkov

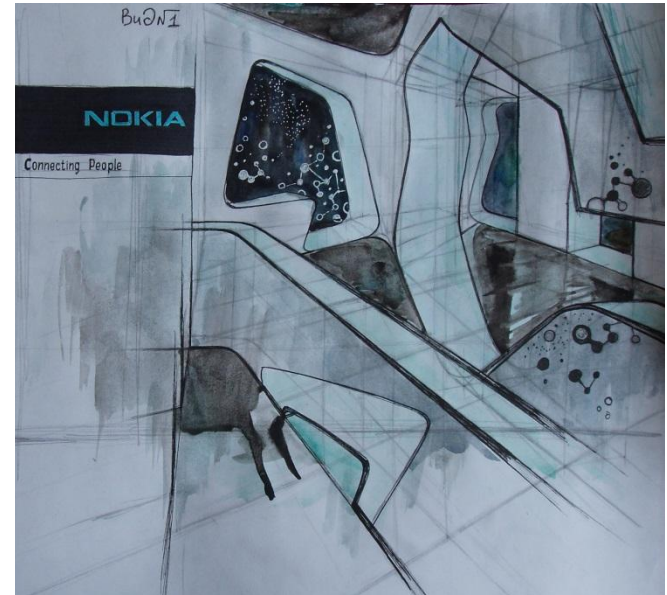

Interior Nokia's flagship salon on sale of cellular phones

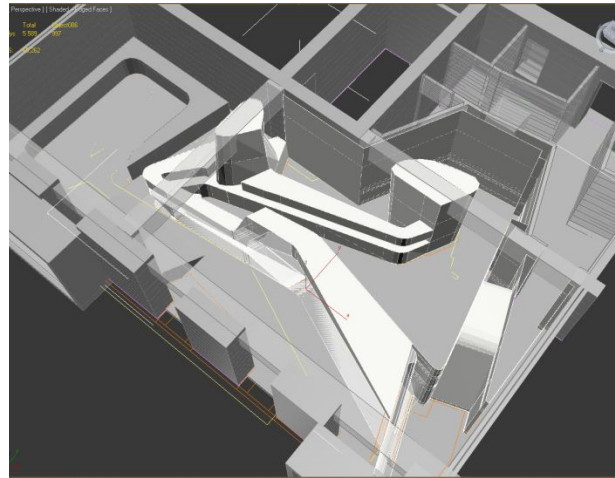

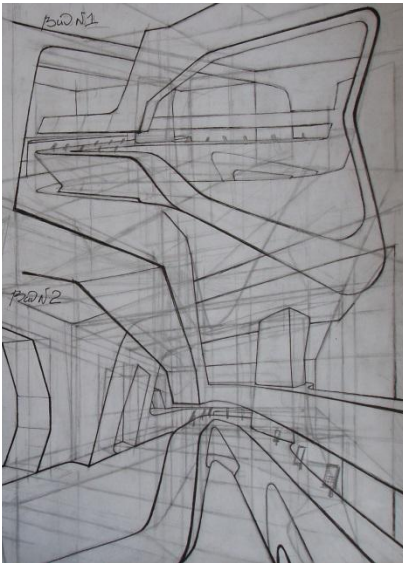
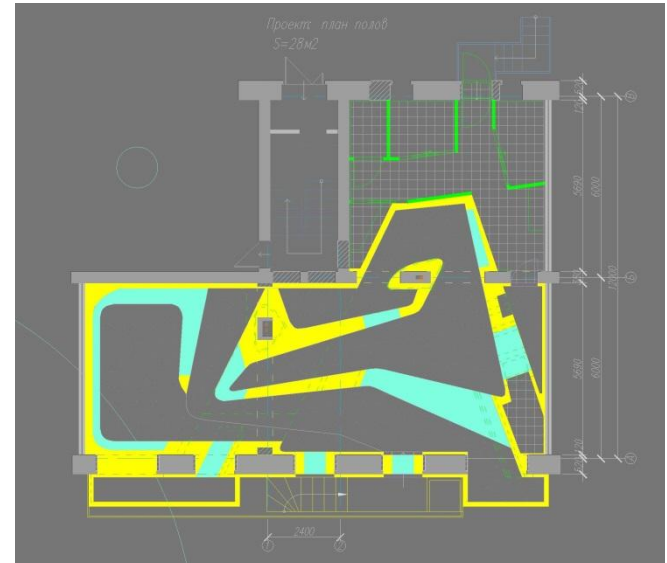
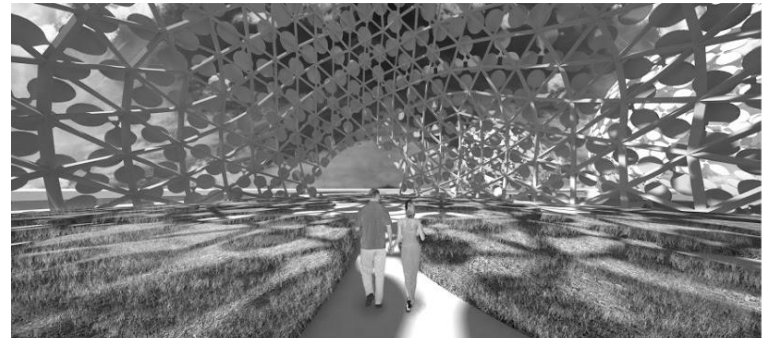
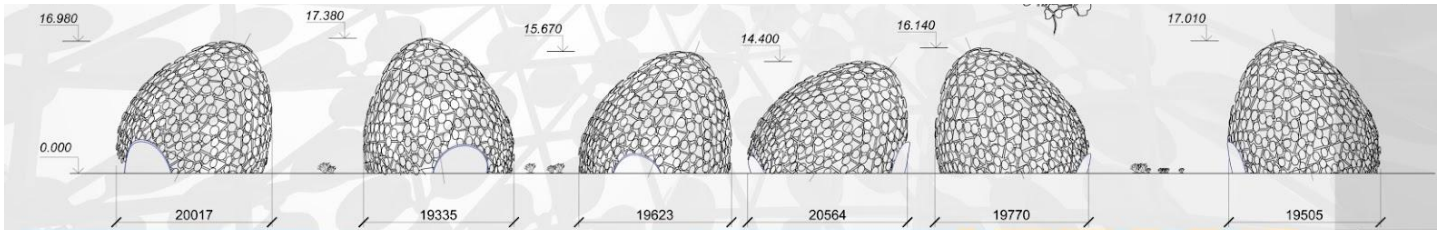
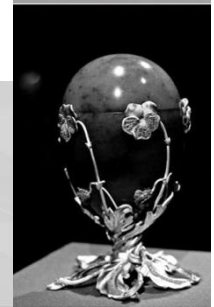
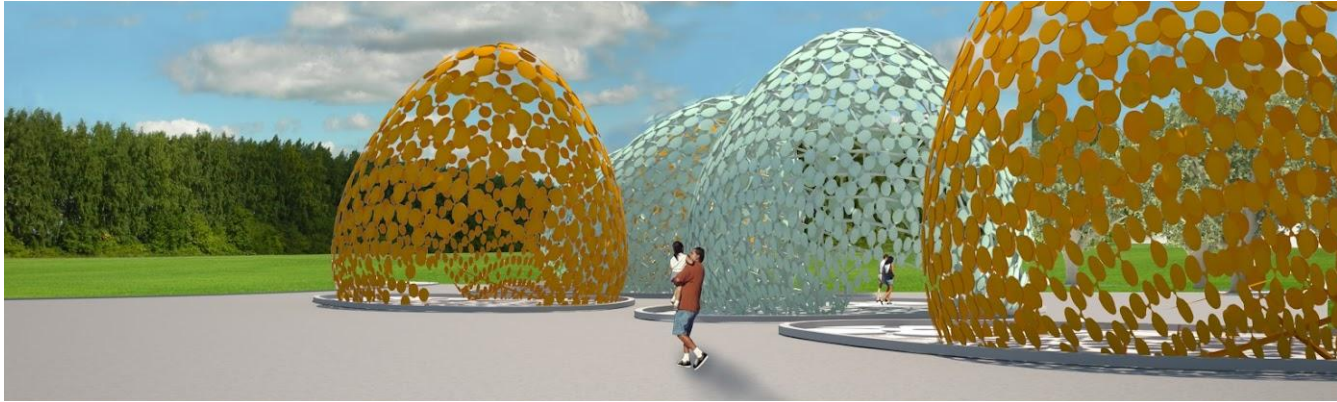



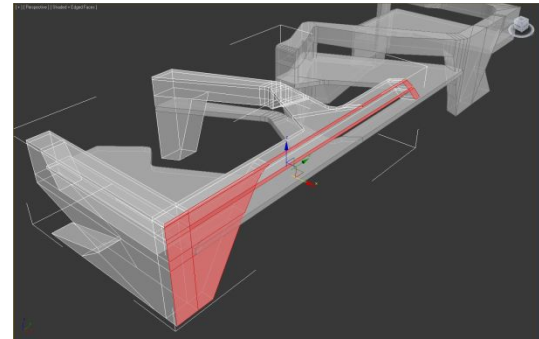
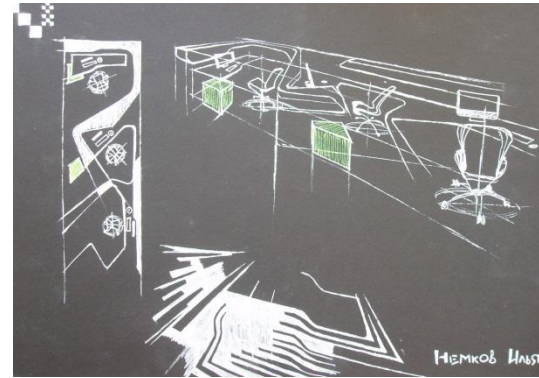
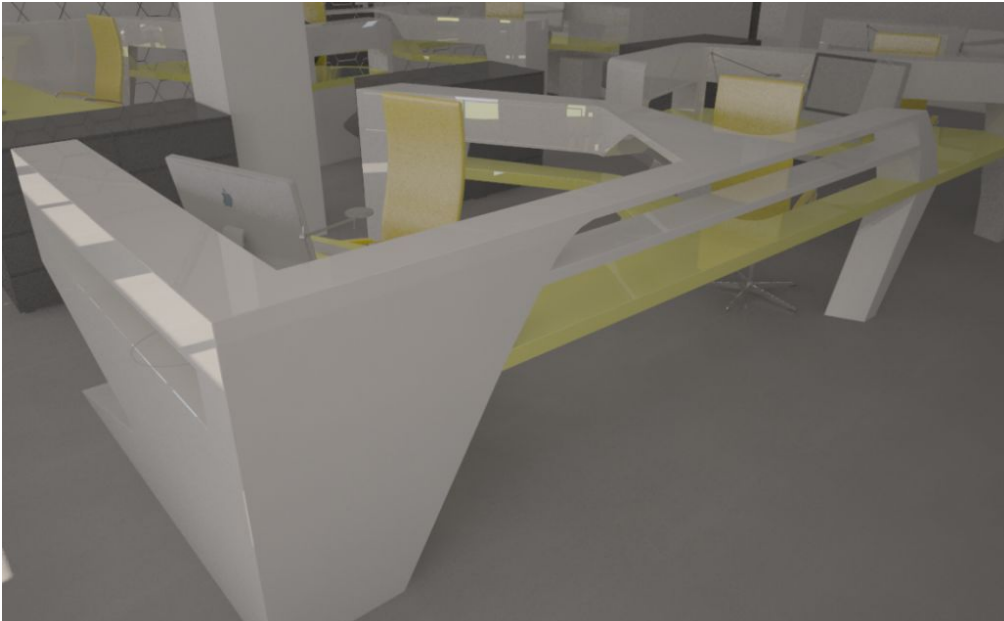
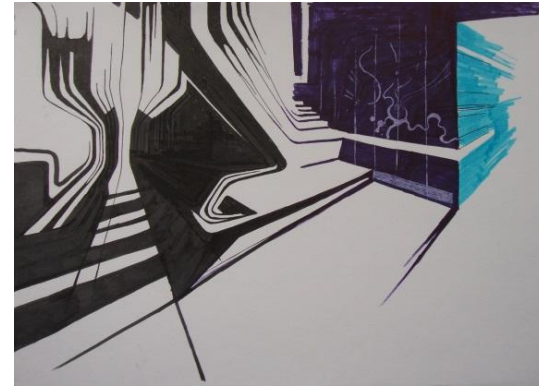
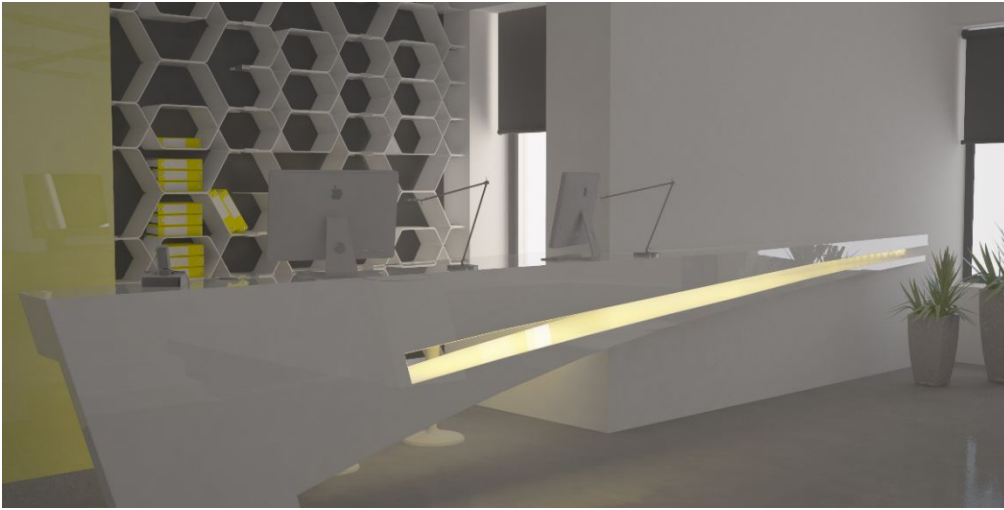

























The design concept of the complex Art Park





- Design of furniture for the interior of the bank "Raiffeisen"



 	<ul style="list-style-type: none">  классический гамбургер  классический чизбургер  чиз-чicken бургер  двойной гамбургер  двойной чизбургер 	<ul style="list-style-type: none">  классический хот-дог  салатный хот-дог  картофель фри  греческий салат  салат 'Особый'
 <p>круглосуточная сеть закусочных ЕДИМ Уникальный проект, который сочетает в себе формат быстрого и качественного питания. Это кафе, где активное обслуживание не влияет на качество вкуса. Это лучшее место как для тех, кто экономит свое время, так и для тех, кто ценит качественную кухню.</p> <p>адрес: ул. 9мая, 19 т.: +7(3912)20-00-00 эл.адрес: www.e.ru</p>	 <ul style="list-style-type: none">  пицца 'Чемпион'  пицца 'Пепперони'  пицца 'Пепперони-чили'  пицца 'Вегетарианец'  пицца 'Маргарита' 	 <ul style="list-style-type: none">  лимонный напиток  охлажденная вода  кофе 'Арабика'  черный и зеленый чай
		<p>www.e.ru круглосуточная сеть закусочных</p> <p>ул. 9мая, 19</p> 
 <p>круглосуточная сеть закусочных ЕДИМ адрес: г.Красноярск, ул. 9мая, 19 т.: +7(3912)20-00-00 эл.адрес: www.e.ru</p> <p>Буклет составил: ст.грАФ 08-42 Немков И.В. Проверила: Супрун Е.Г.</p>	 <p>www.e.ru круглосуточная сеть закусочных</p> <p>ул. 9мая, 19 т.: +7(3912)20-00-00 эл.адрес: www.e.ru</p> <p>Красноярск</p>	 <p>www.e.ru круглосуточная сеть закусочных</p> <p>ул. 9мая, 19 т.: +7(3912)20-00-00 эл.адрес: www.e.ru</p> <p>Красноярск</p>

Буклет круглосуточной сети закусочных "ЕДИМ"

Painting

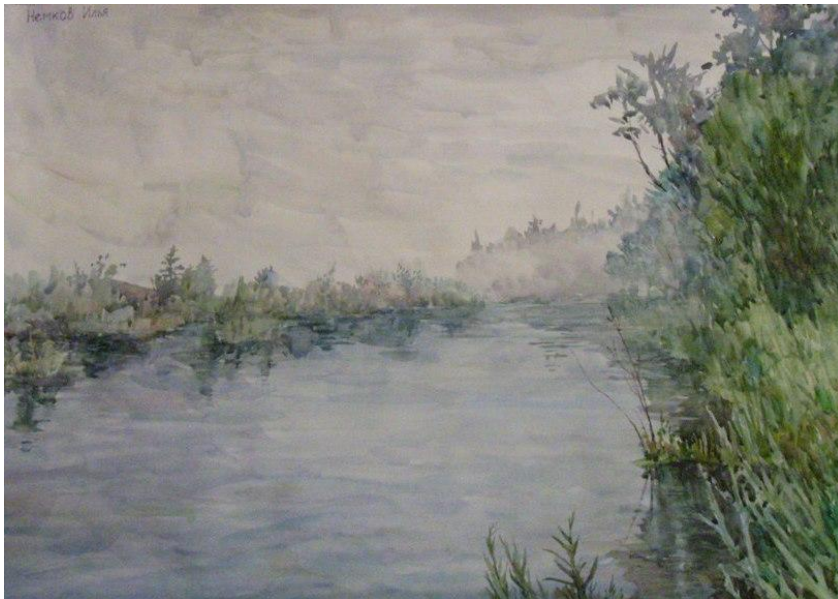

On the shore of the Molokov island. Krasnoyarsk. Watercolor



Kuznetsov compound. Krasnoyarsk. Watercolor



Nikolaevka. Krasnoyarsk. Watercolor, ink

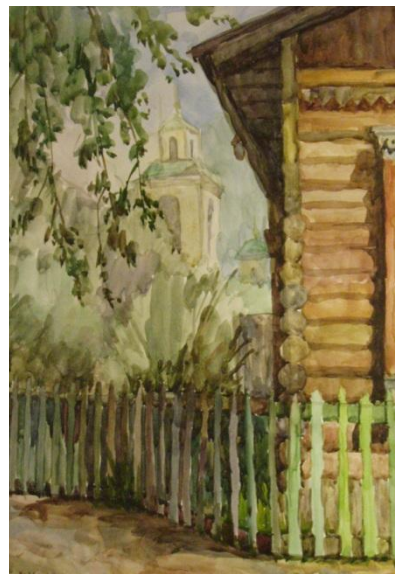

Kuznetsov compound. View of the Church. Krasnoyarsk. Watercolor



Tower of Red Square. Krasnoyarsk. Watercolor



Portrait of Marshal G.K. Zhukov. A copy of a painting by S. Prisekin "Marshal Zhukov". Gouache

Study project

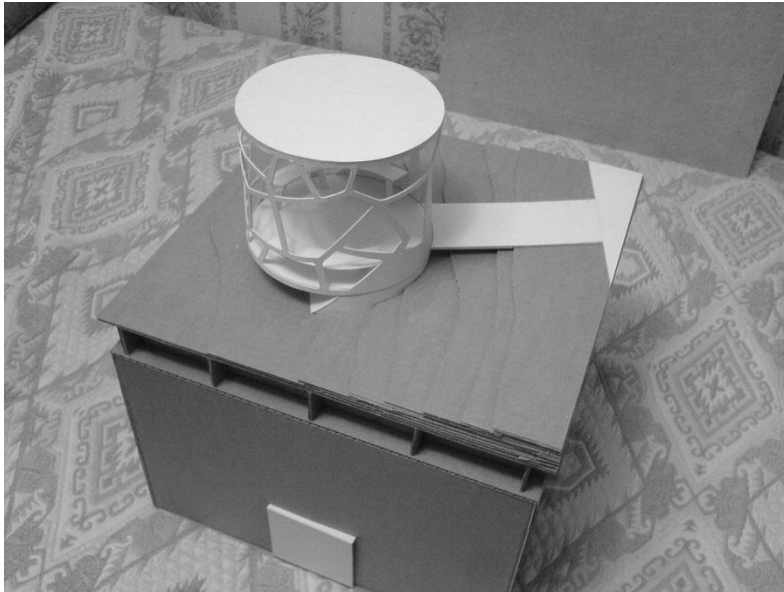

Model of gazebo for SFU. Material: cardboard, corrugated cardboard

Working project

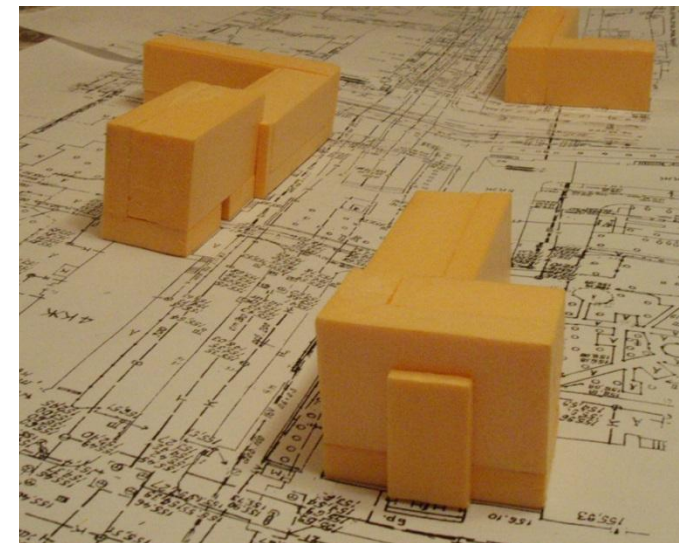
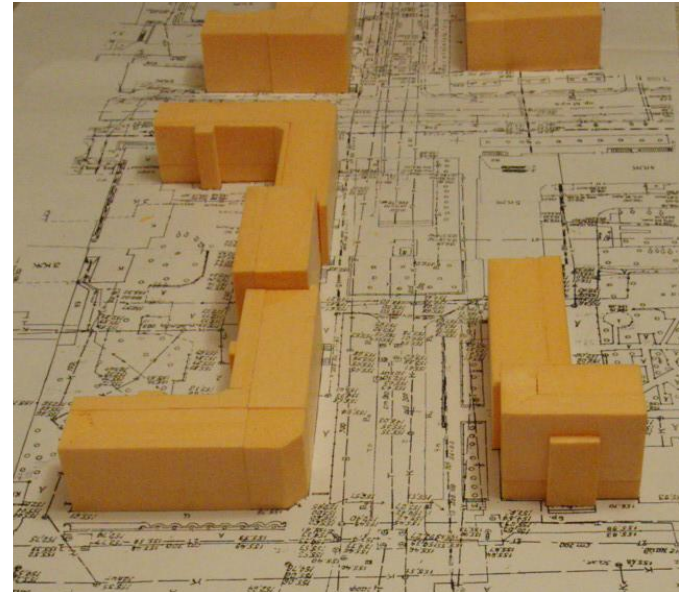

Creating a model of historic part of the city. Material: penoplex

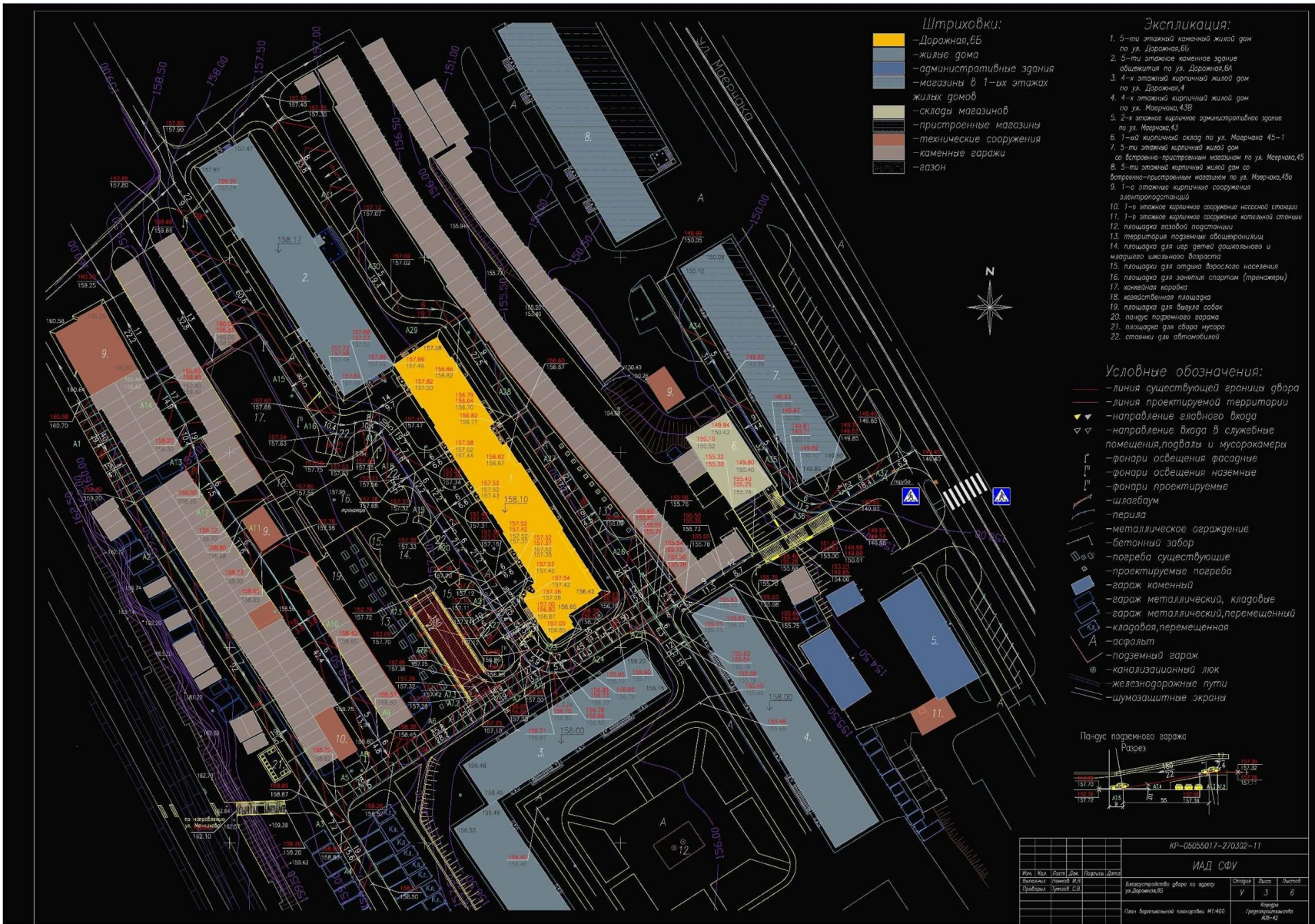

Engineering improvement of building surrounding grounds. Vertical planning



Разработка интерьера кафе для
СФУ



Разработка интерьера кафе для
СФУ

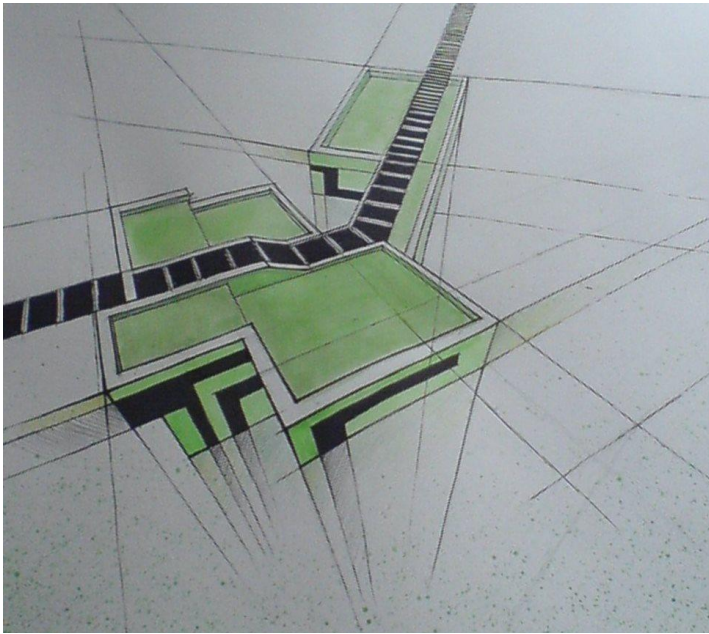

Cottage consists of two blocks and gallery passage between them.

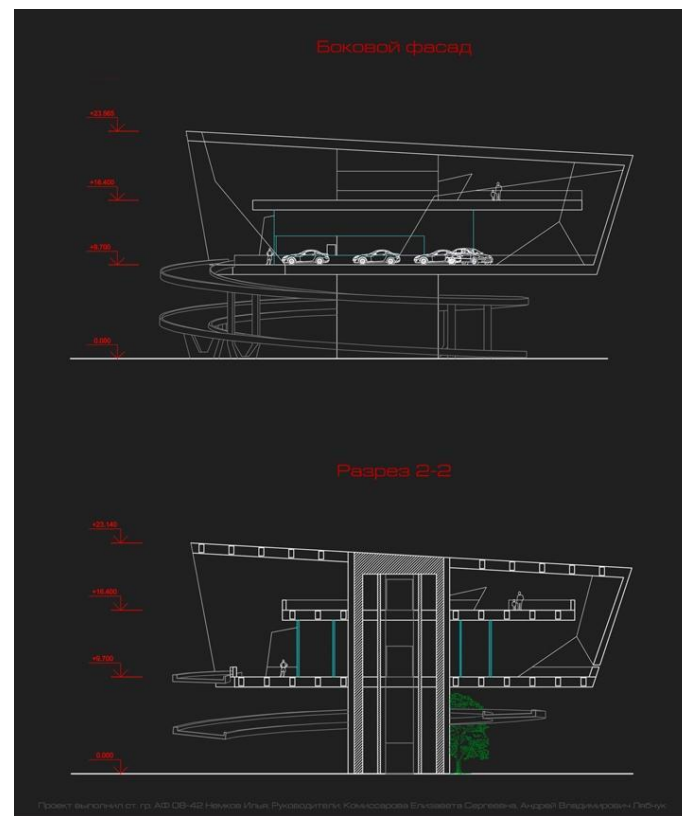
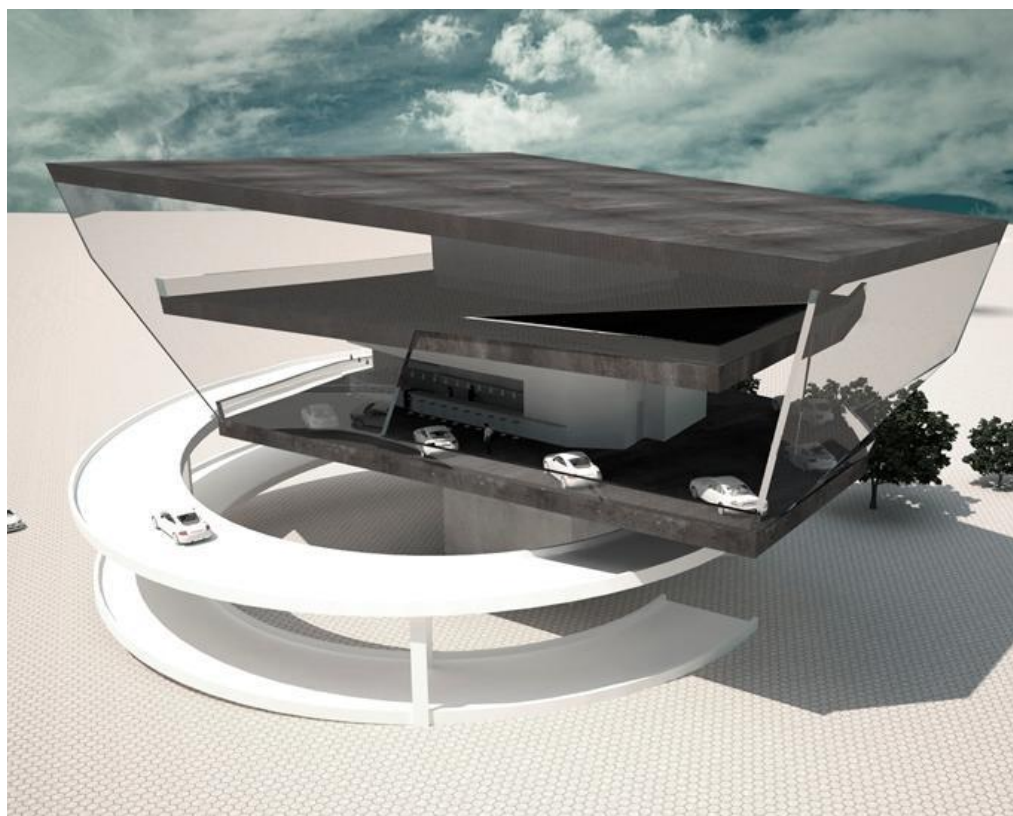
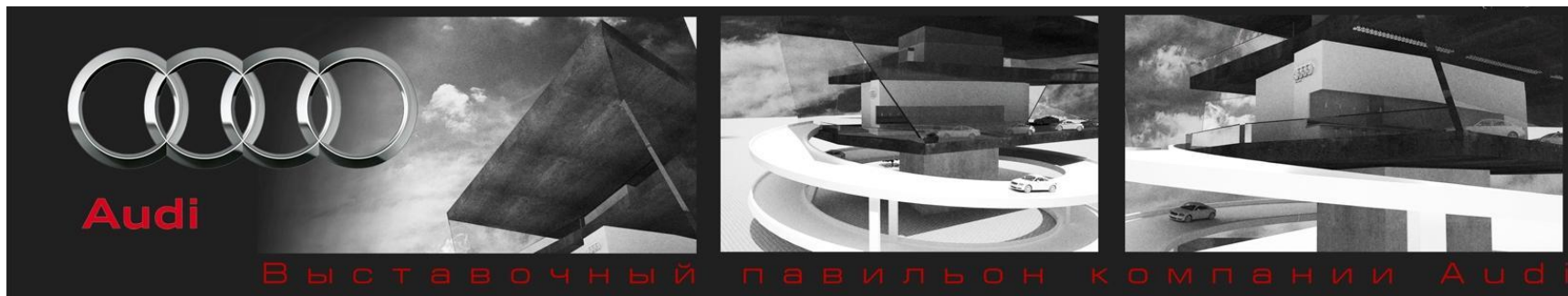

Exhibition pavilion of "Audi" company

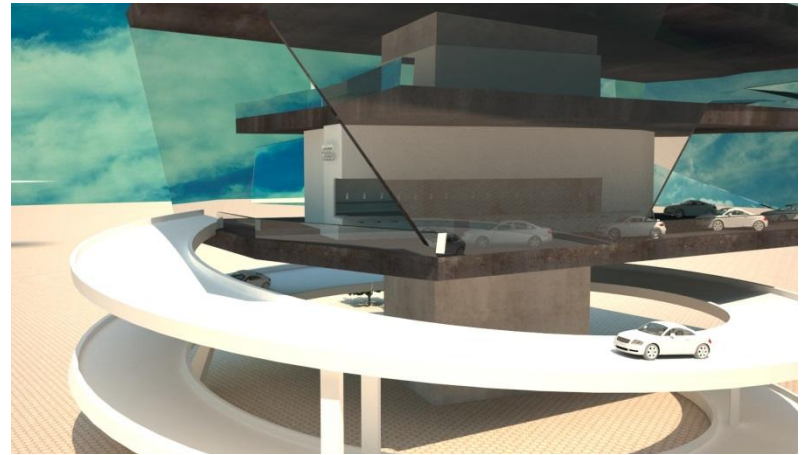
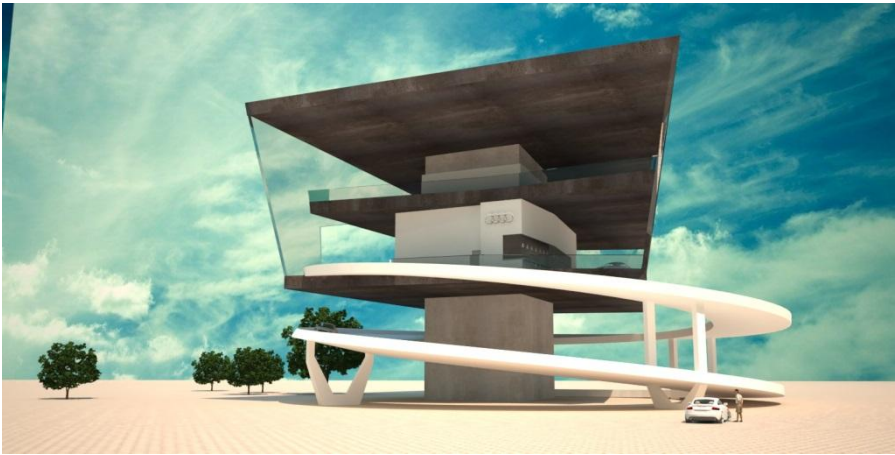

Exhibition pavilion of "Audi" company

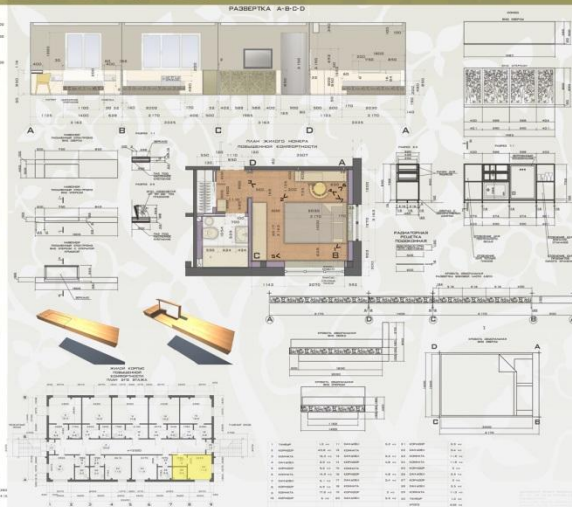
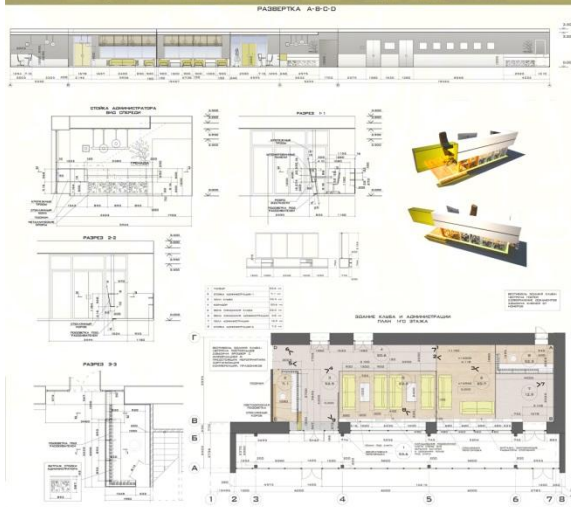

Санаторно-оздоровительный комплекс
"Гренада"

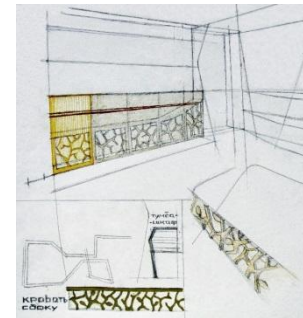
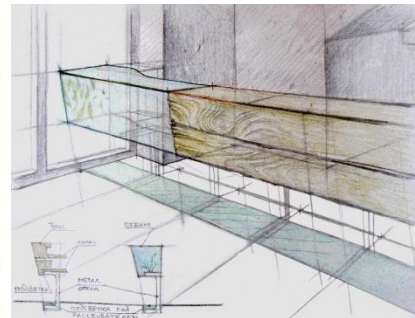
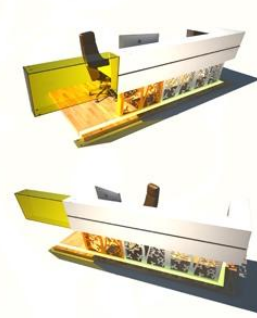

Sanatorium and Recreational Complex "Grenada"

ГРЕНАДА
САНАТОРНО-ОЗДОРОВИТЕЛЬНЫЙ КОМПЛЕКС

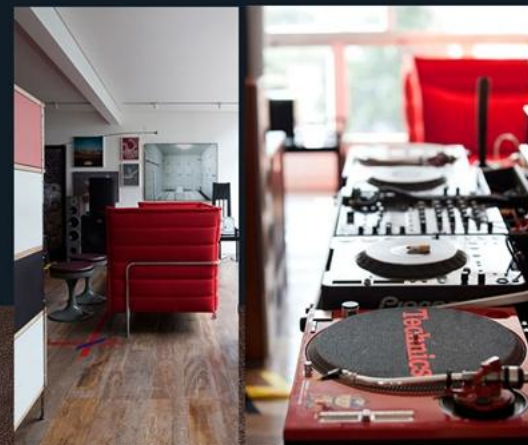
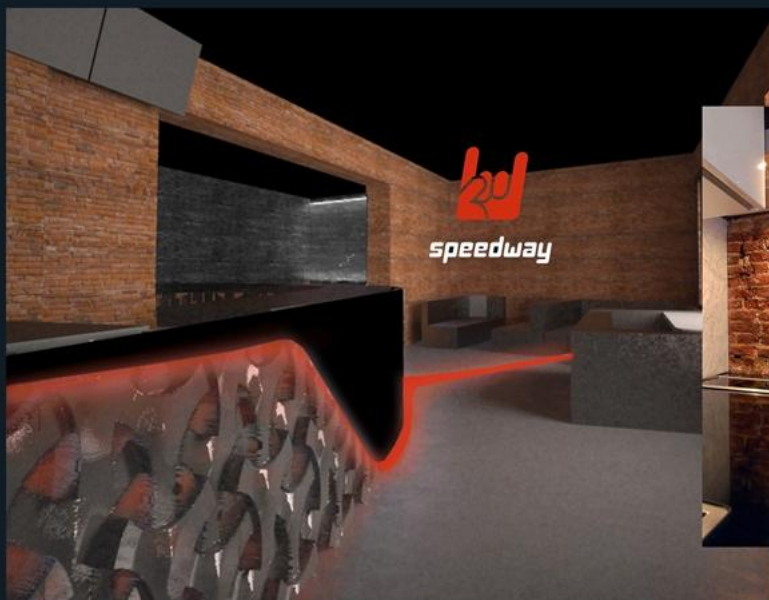

The bar-restaurant "Speedway". Ilya Nemkov, Alyona Ostapova, Alexey Aseev

Планировочный вариант №1

S общая = 6587 м²

0.000 - отметка пола от отметки перепада

Мойки в данный момент занимают угловые помещения на барной стойке. При их использовании бармены не препятствуют движению персонала. Проходы остаются максимально широкими.

Экспликация помещений

N п/п	Наименование	Площадь м ²			
1	Автомобиль, подвешенный к потолку	5,7	6	11	16
2	Главный зал	7	7	12	17
3	Помысловая площадка DU	8	8	13	18
4	Бар	9	9	14	19
5	Сцена	10	10	15	20

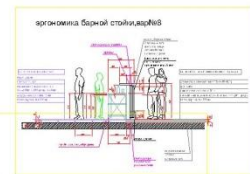
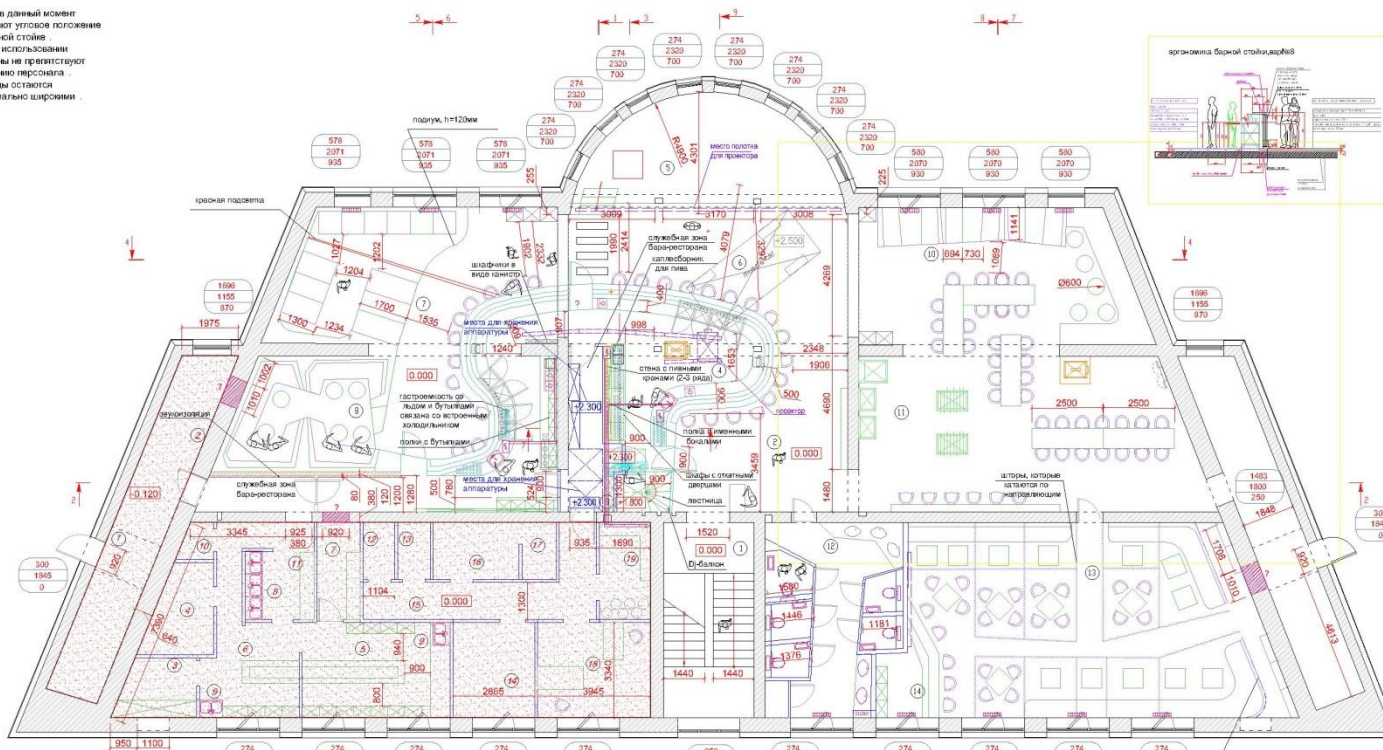

Экспликация

1	Барная стойка	9
2	Стол	11
3	Стол	12
4	Стол	13
5	Стол	14
6	Стол	15
7	Стол	16
8	Стол	17
9	Стол	18
10	Стол	19
11	Стол	20

Экспликация служебных помещений

N п/п	Наименование	Площадь м ²
1	Средний шеф-повар, раздатчик напитков	11
2	Помысловые помещения	12
3	Холодильные помещения	13
4	Склад продуктов	14
5	Гардеробная	15
6	Холодильный шкаф	16
7	Резачка	17
8	Мойка посудной посуды	18
9	Мойка столовой посуды	19
10	Комната уборочной инвентаря	20

S стол клетки = 5,7м²
 S стол клетки = 16м²

Объект по адресу ул. 040.
 Разработал интерьер.

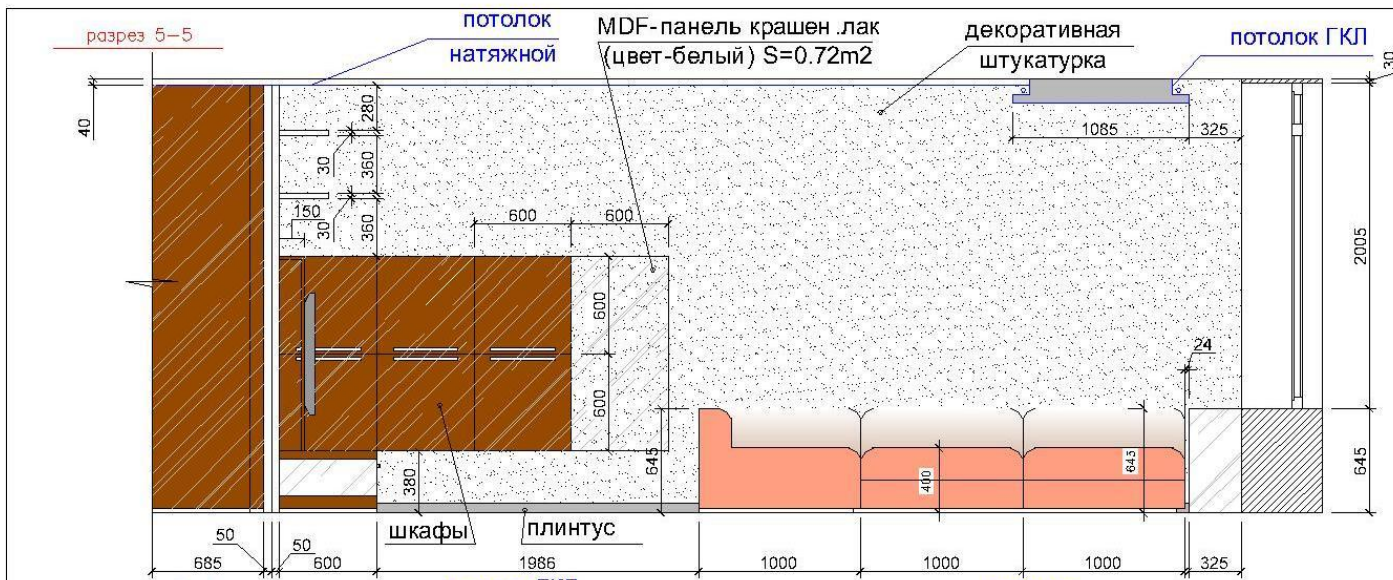

Квартира по адресу ул. Разработка интерьера	Стадия	Лист	Листов
	РП	19	30
	автор		G-DESIGN
	ФОРМАТ А4		
ГАП	Разработчик		

Квартира в жилом комплексе "Южный берег". Игорь Гошовский, Илья Немков

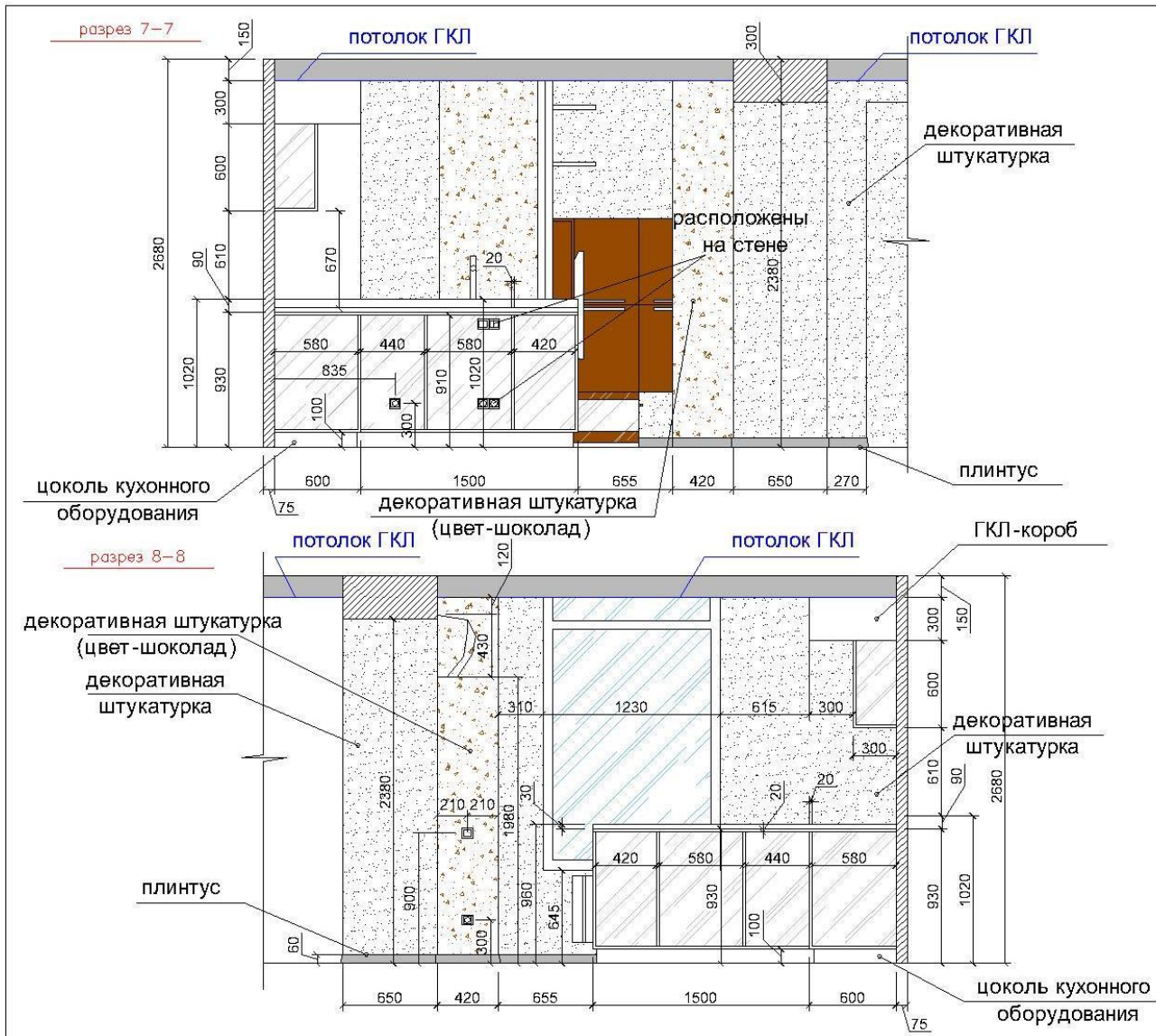

Квартира по адресу ул. Разработка интерьера	Лист	Листов
ГАП Разработчик	РП 20	30
G-DESIGN		форма
		ФОРМАТ А4

Квартира в жилом комплексе "Южный берег". Игорь Гошовский, Илья Немков

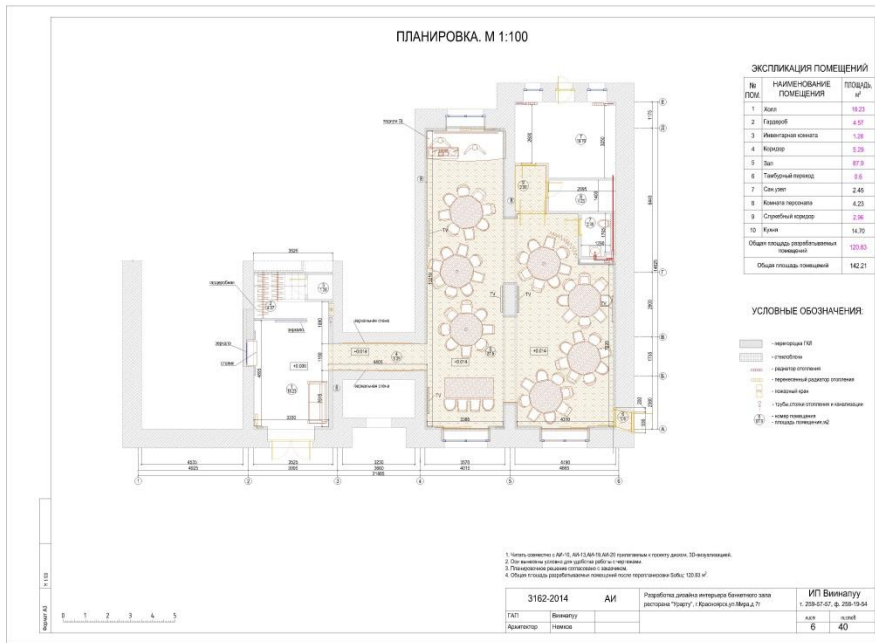

- For applying an entry to the banquet hall section of the wall under the window opening was demounted
- The space of the hall is formed by changing the existing situation by building up with laid brickwork and suturing by the plasterboard opening in the wall between the hall and the adjacent room. The flight of stairs, a wall of glass bricks and opening next to them are sutured by plasterboard. In the lobby of the partition is set for dressing and protecting the space under the stairs to the room inventory. The floors in the lobby stay as it is.
- The walls of the corridor between the hall and the hall are arranged mirror facets. The ceiling is formed by plasterboard boxes.
- The floor in the hallway and into the room of the PVC tiles (AI-13,14) is higher than in the lobby. Between the corridor and hall - transition nut. Plinth in all areas should be on the same level on the top edge.
- The hall is formed of two rooms, among which are projected the dismantled wall. The partition is added to create boundaries between the hall and office space. On the contour of the room sound insulation is laid. The ceiling ventilation ducts are sewn plasterboard. Important to note the ceiling will be suspended luminaries in addition to air conditioning, overhead projector, projector screen frames spotlights, mirror ball. For the walls in the room to be attached: TV, audio speakers and paintings. The hall should be formed podium to DJ equipment.

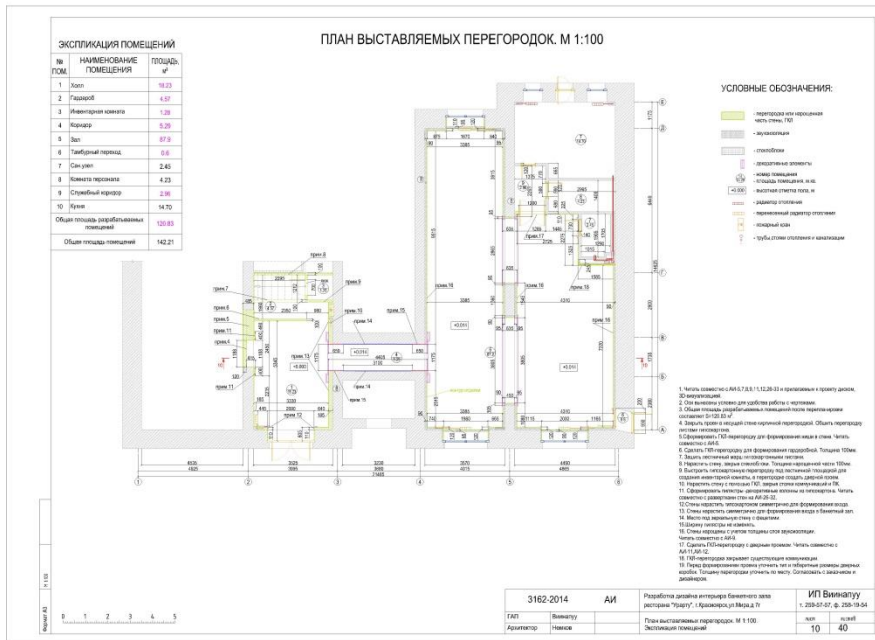

- Elaboration of drawings album for interior design of restaurant 'Urartu'. Krasnoyarsk.
- 40 sheets
- Chief architect: Viinapuu
- Architectural designer: Nemkov

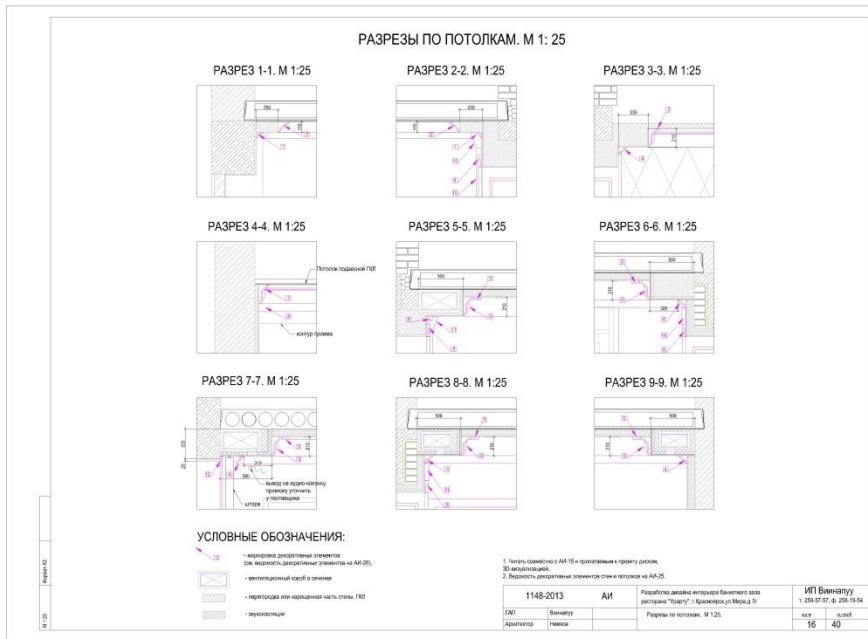

- Hall:
 - decorative column (pilasters), framing the mirror to the left of the entrance, formed by plasterboard and metal profiles. Deepening in pilasters made by superimposing two layers of plasterboard, in one of which rectangular hole is cutted. Decorative columns flanking the corridor between the hall and the dining-hall are invoiced (elevation of the walls on AI-26-32 and list of decorative elements on AI-25)
- The corridor between the hall and the dining-hall:
 - jumpers of openings in the corridor at the same level (overall section on AI-33);
- The dining-hall:
 - ceilings in the room to mount based insulation layer (ceiling plan and cuts across the ceiling to the AI-15, 16 and elevation of the walls of the AI-26-32, the general section of the hall on the AI-33);
 - the installation of plasterboard ceilings has to make with consideration of the location of ventilation, also important the box glued over decorative cornices (ceiling plan and cuts across the ceiling to the AI-15, 16 and elevations of the walls of the AI-26-32);
 - air conditioning and ventilation diffusers have, depending on the location of lighting fixtures, decorative elements, according to the scheme presented in the draft, if necessary, make adjustments, coordinating them with the designer;
 - in the walls under the windows are made with indents for "embedding" of radiators.
 - all the walls in the hall spliced by plasterboard. Between the plasterboard and the load-bearing walls is laid sound insulation.
- The walls and wall openings have decorative moldings and elements:
 - the cost estimate of the work should be guided by the number of finishing materials according to the statements of the walls and ceilings;
 - when ordering custom-made furniture, be sure to specify the dimensions of the place.

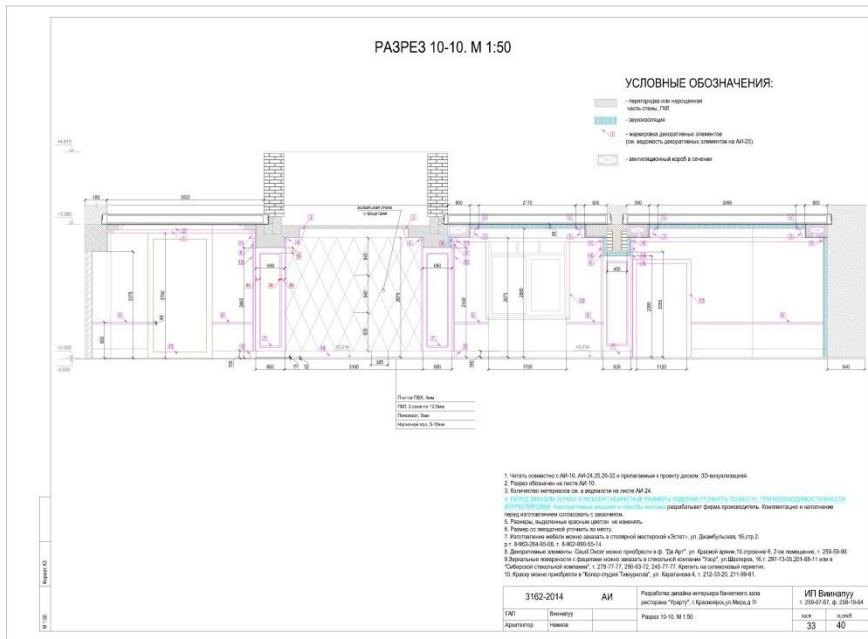

- Elaboration of drawings album for interior design of restaurant 'Urartu'. Krasnoyarsk.
- 40 sheets
- Chief architect: Viinapuu
- Architectural designer: Nemkov

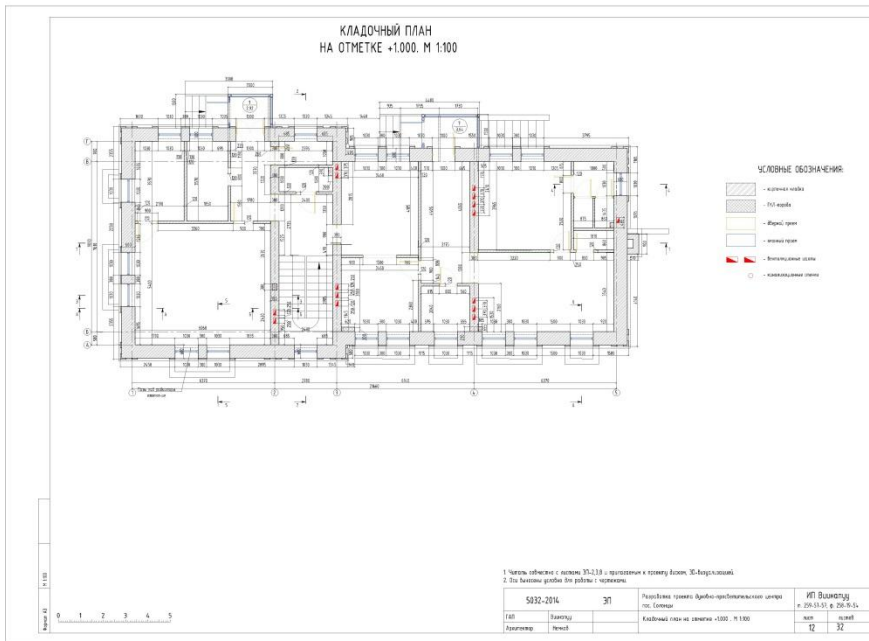
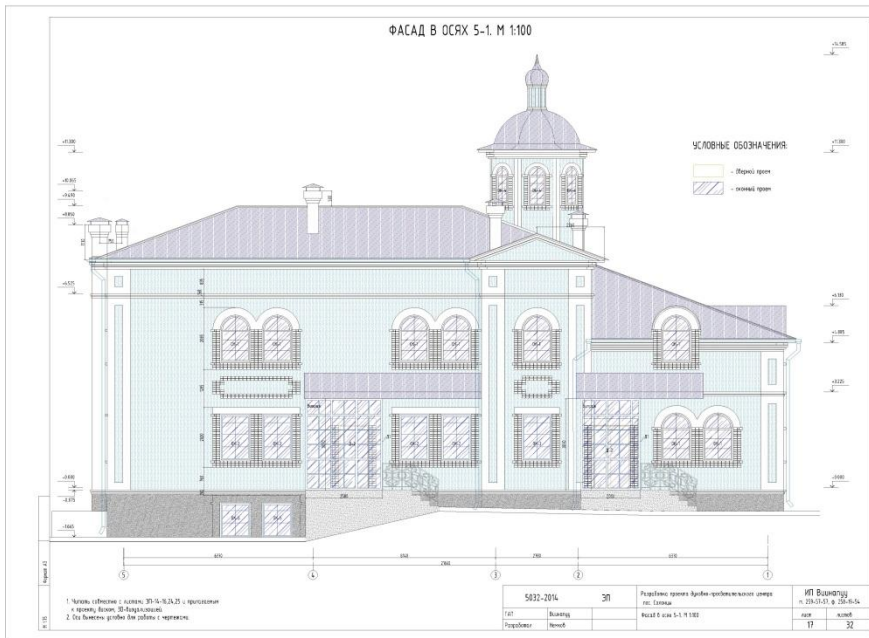

- • Structural system - frameless transverse load-bearing walls.
- • Communication between the basement, first and second floor is provided by the internal staircase.
- • The connection between the second floor and technical floor is provided by folding ladder.
- • TECHNICAL AND ECONOMIC PERFORMANCE
- Built-up area, taking into account the input of stairs -243.55 m²
- The total area of the premises, excluding a technical floor (attic) - 501.43 m²
- • The area of technical floor -112.94 m²

- Editing of design drawings album of spiritual outreach center in Krasnoyarsk, Solontsy.
- 32 sheets
- Chief architect: Viinapuu
- Architectural designer: Nemkov

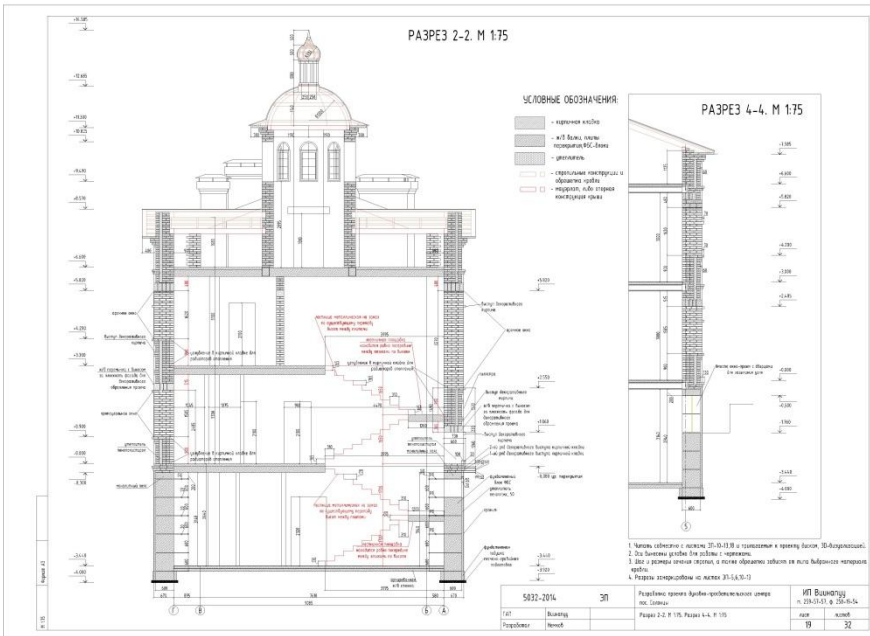
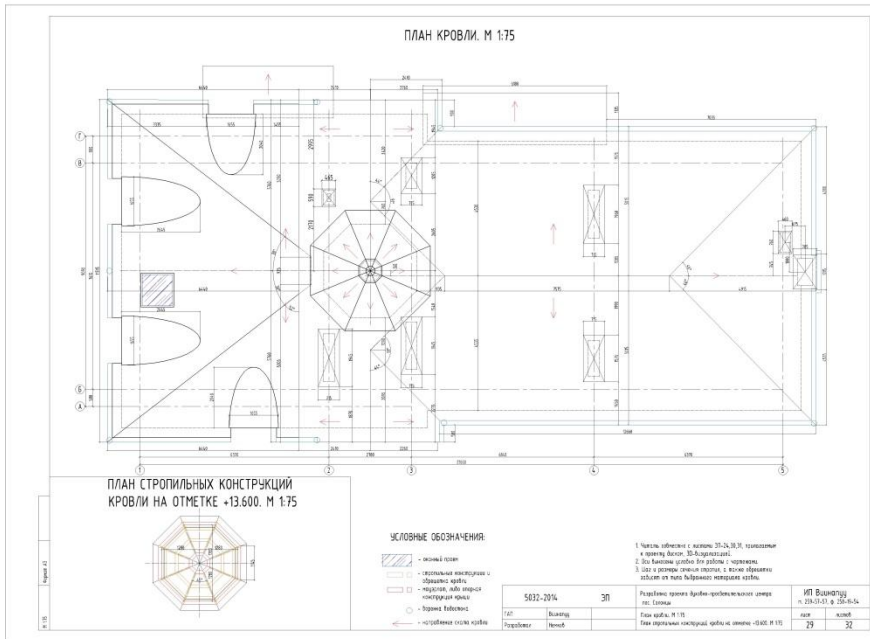

- FACADE:
- decorative elements are made by protrusion of particular bricks out of the facade plane
- decorative pilasters are made by bricks framing entrances, window openings, horizontal decorative belts
- the facade has two-tone coloring - selection of paint color to determine on site
- the plinth is faced with natural granite or artificial stone.

- Editing of design drawings album of spiritual outreach center in Krasnoyarsk, Solontsy.
- 32 sheets
- Chief architect: Viinapuu
- Architectural designer: Nemkov

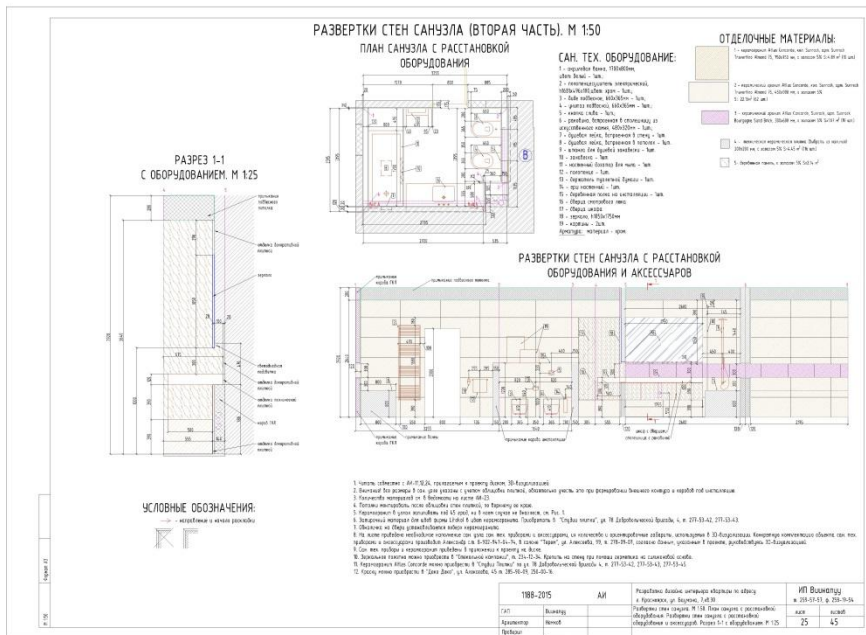
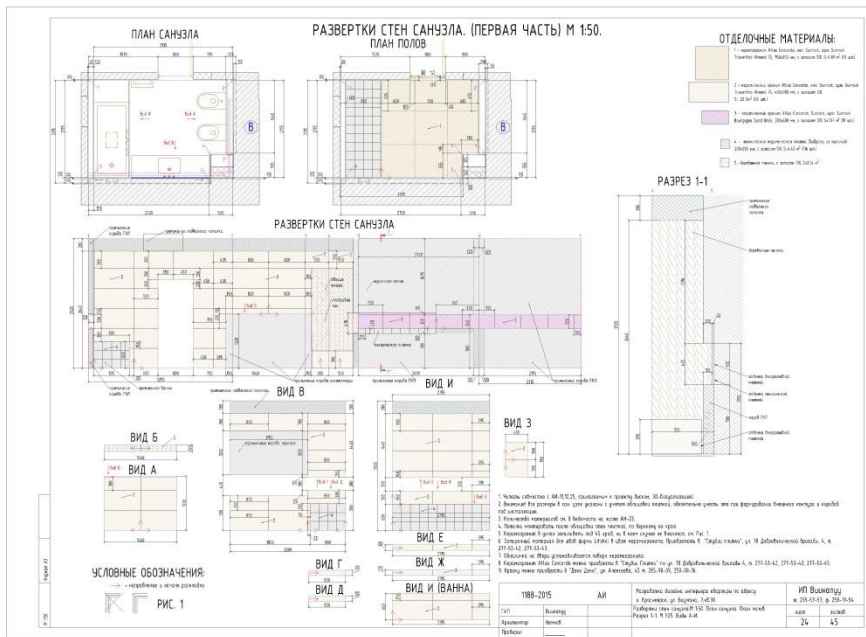

- All rooms except the living room and WC (in willing of customer) installed plasterboard ceilings, considering extending ventilation and niches curtains. Lighting is mainly achieved by built-in lamps. Also, the premises are false and overhead fixtures, lighting shelves, furniture. In bathrooms, in addition to the main lighting is provided illumination out of the mirror over the sink .Ventilation ducts, diffusers, air-conditioned place according to ventilation plans, taking into account the binding fixtures and built-in Speaker.

- Elaboration of drawings album for apartments interior design in Krasnoyarsk, Bauman street, 7.
- 45 sheets
- Chief architect: Viinapuu
- Architectural designer: Nemkov

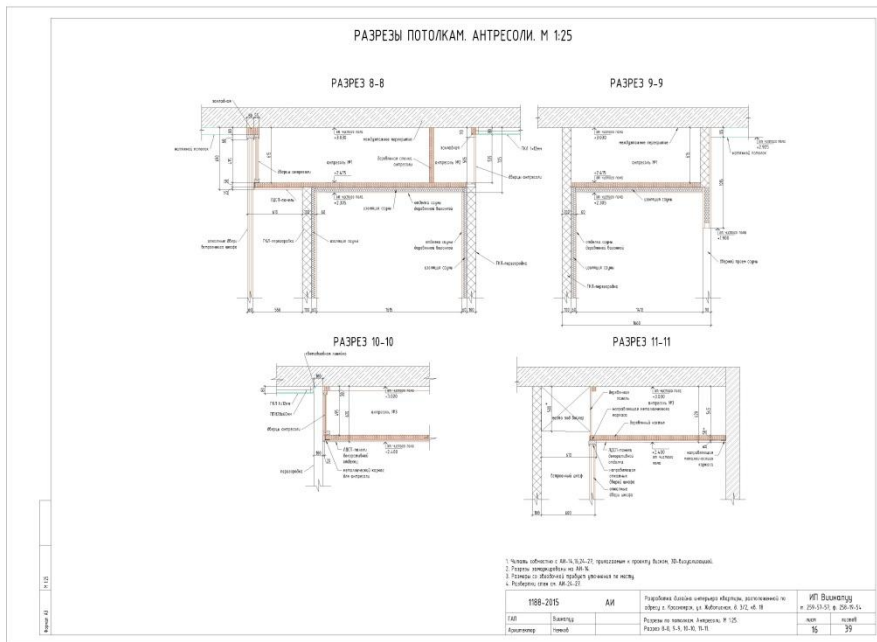
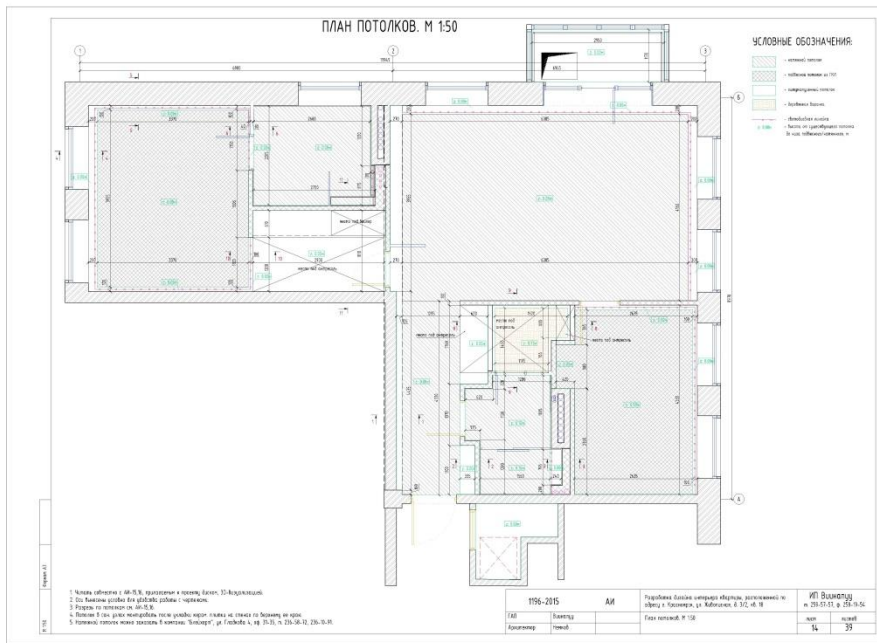

- Elaboration of drawings album for apartments interior design in Krasnoyarsk, village Udachnyi 39 sheets
- Chief architect: Viinapuu
- Architectural designer: Nemkov

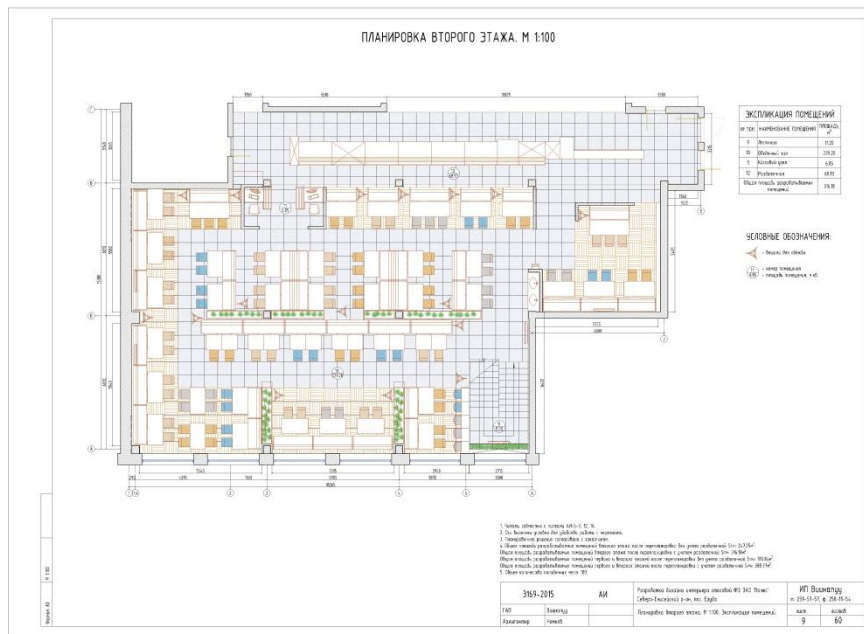
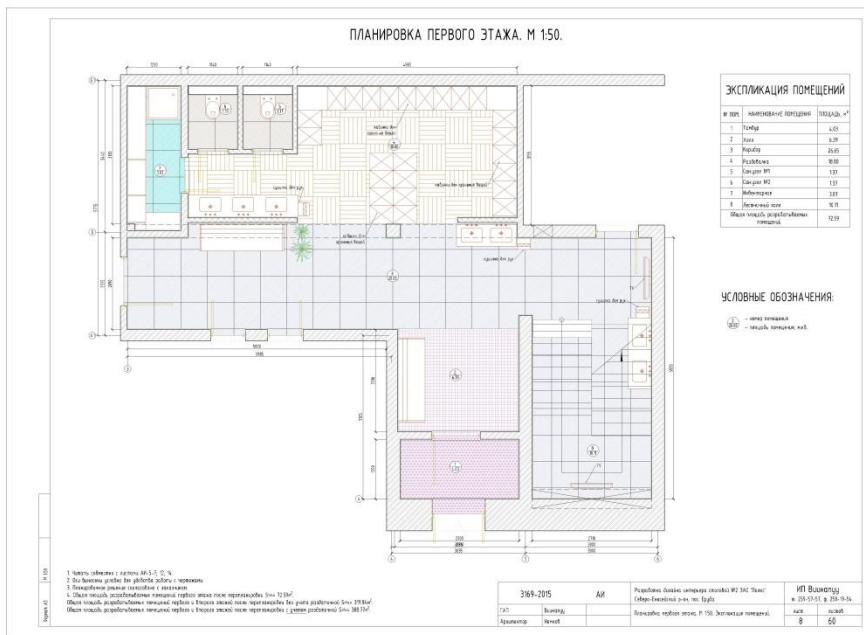

- Elaboration of drawings album of the interior design of the dining room №2 CJSC "Polyus"
- 60 sheets
- Chief architect: Viinapuu
- Architectural designer: Nemkov

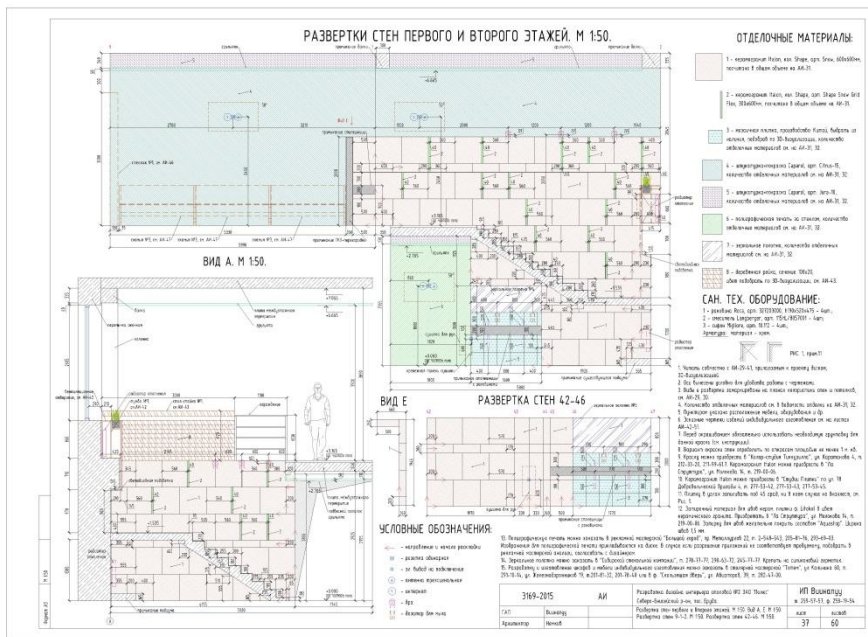
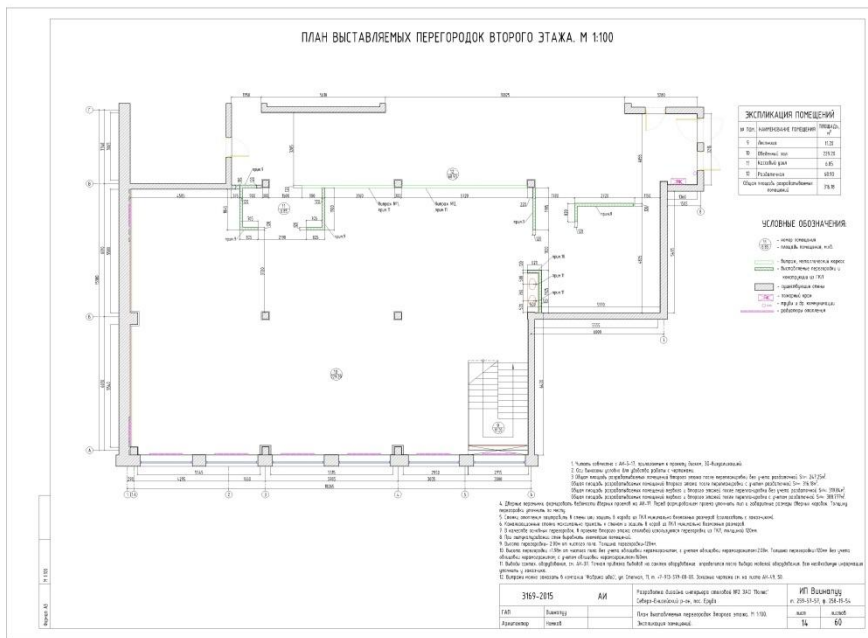

- Elaboration of drawings album of the interior design of the dining room №2 JSC "Polyus"
- 60 sheets
- Chief architect: Viinapuu
- Architectural designer: Nemkov

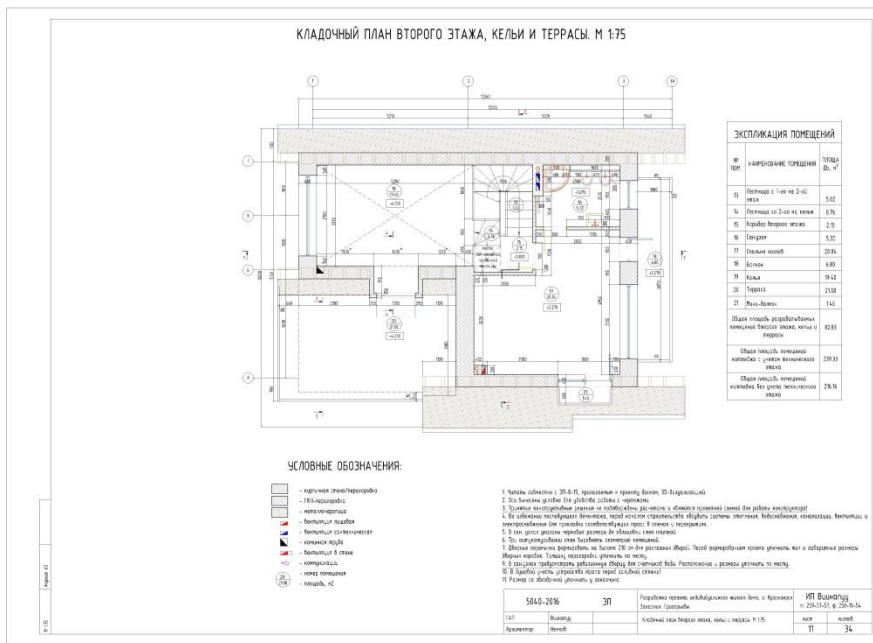
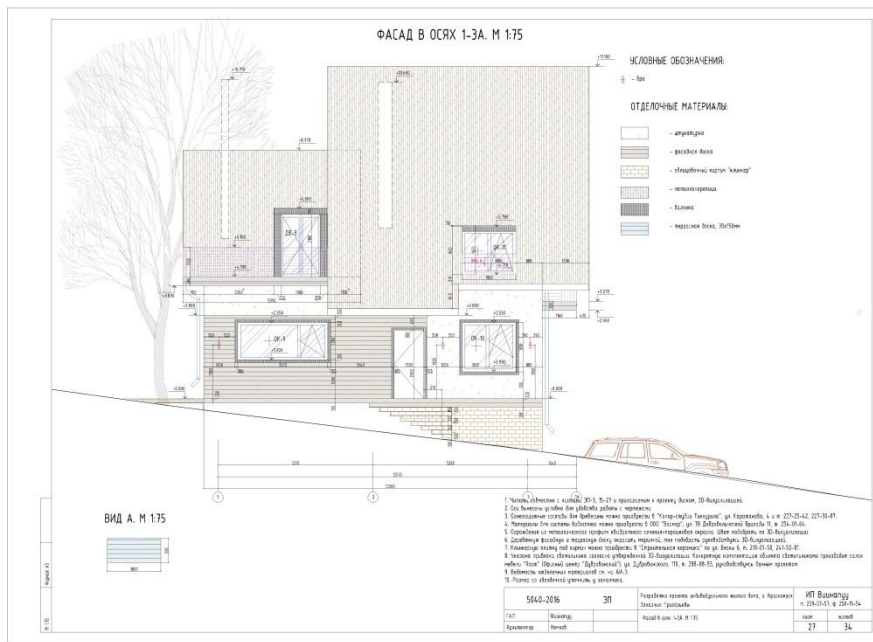

- Elaboration of drawings album of the interior design of the cottage in Krasnoyarsk.
- 34 sheets
- Chief architect: Viinapuu
- Architectural designer: Nemkov

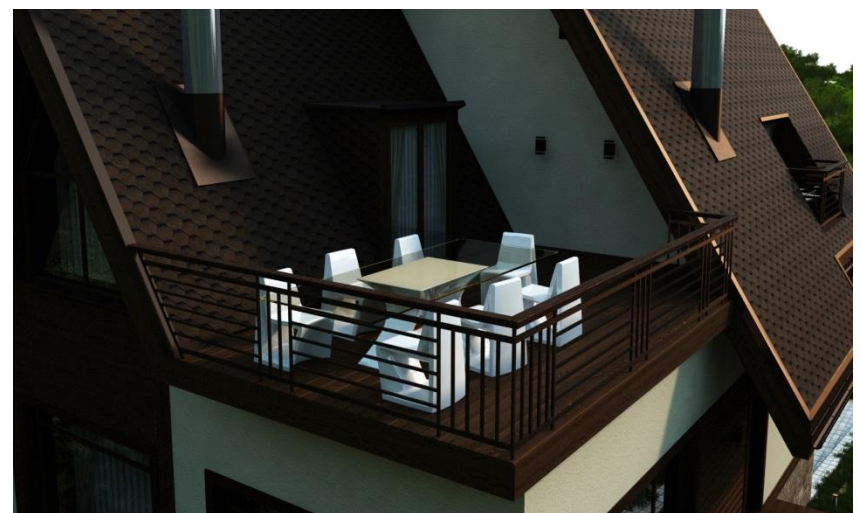
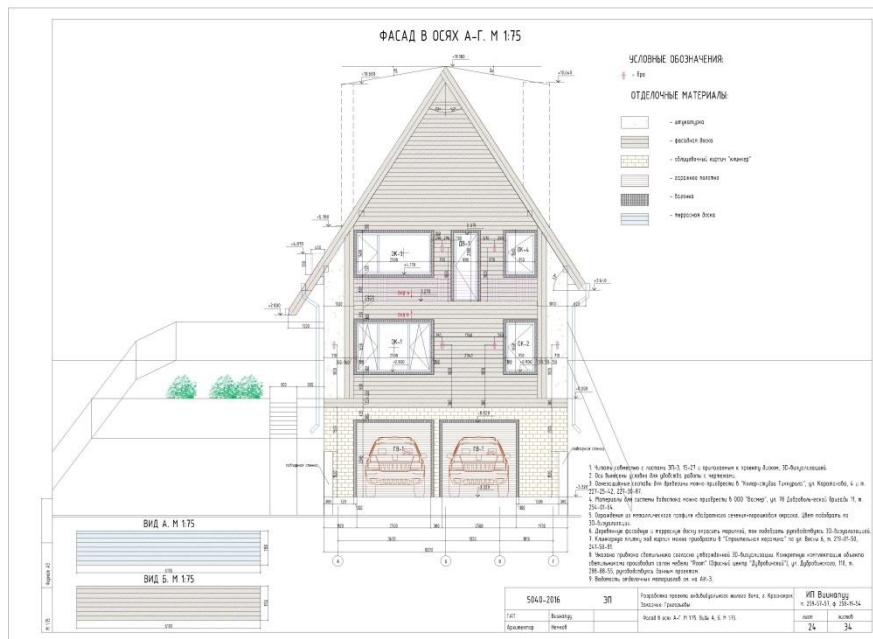
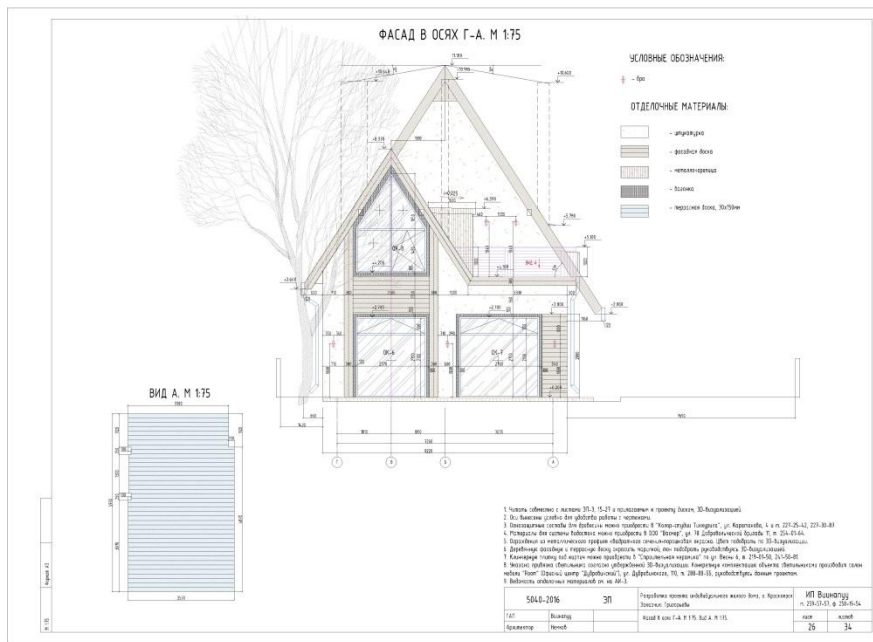

- Elaboration of drawings album of the interior design of the cottage in Krasnoyarsk.
- 34 sheets
- Chief architect: Viinapuu
- Architectural designer: Nemkov