



J. Lukas, Covers (Stalin and Gottwald Died), 1953

B. Iofan, Palace of the Soviets, Moscow, 1931-41





Soviet prefab housing estates

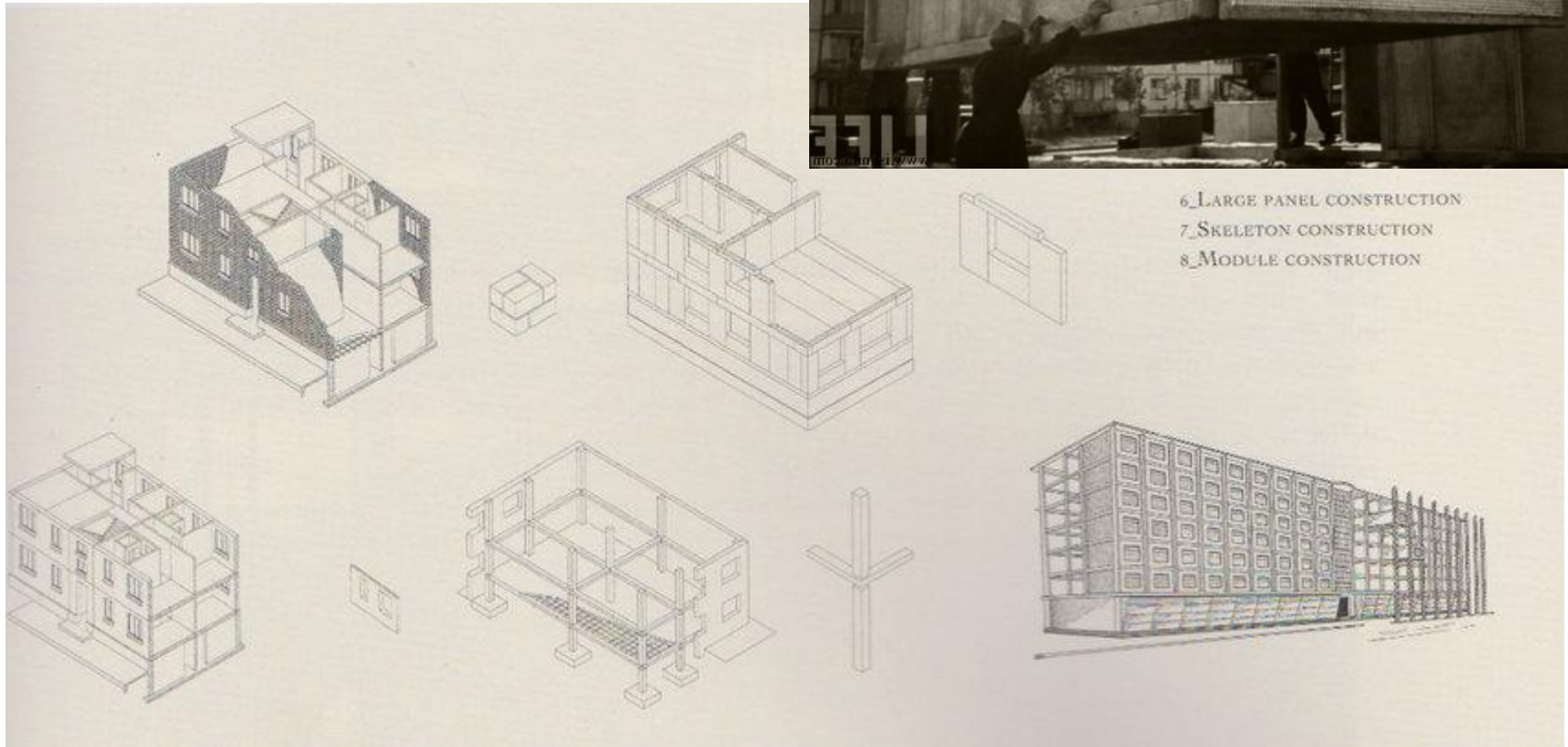
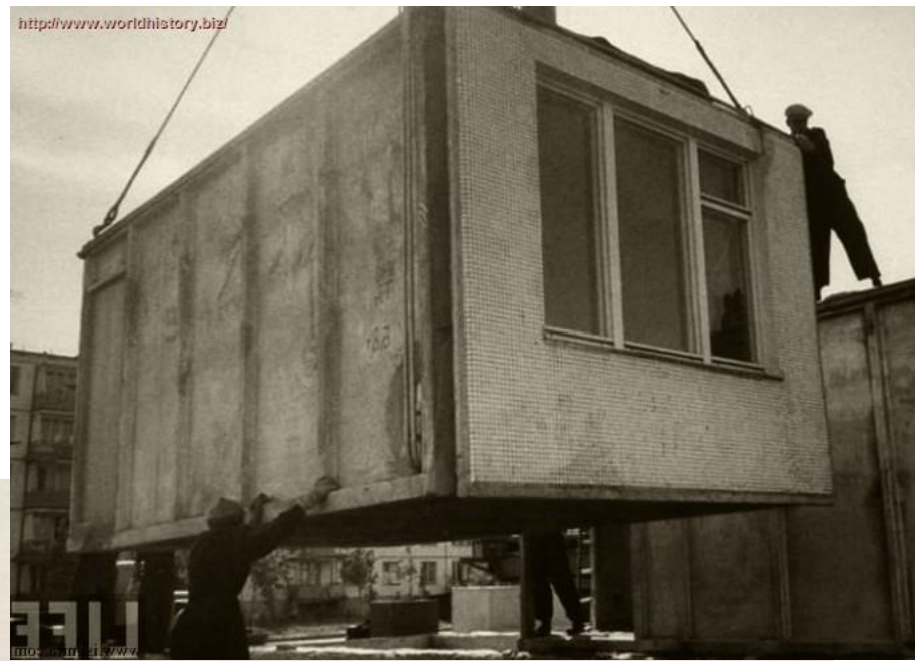

"Khrushchyovka"

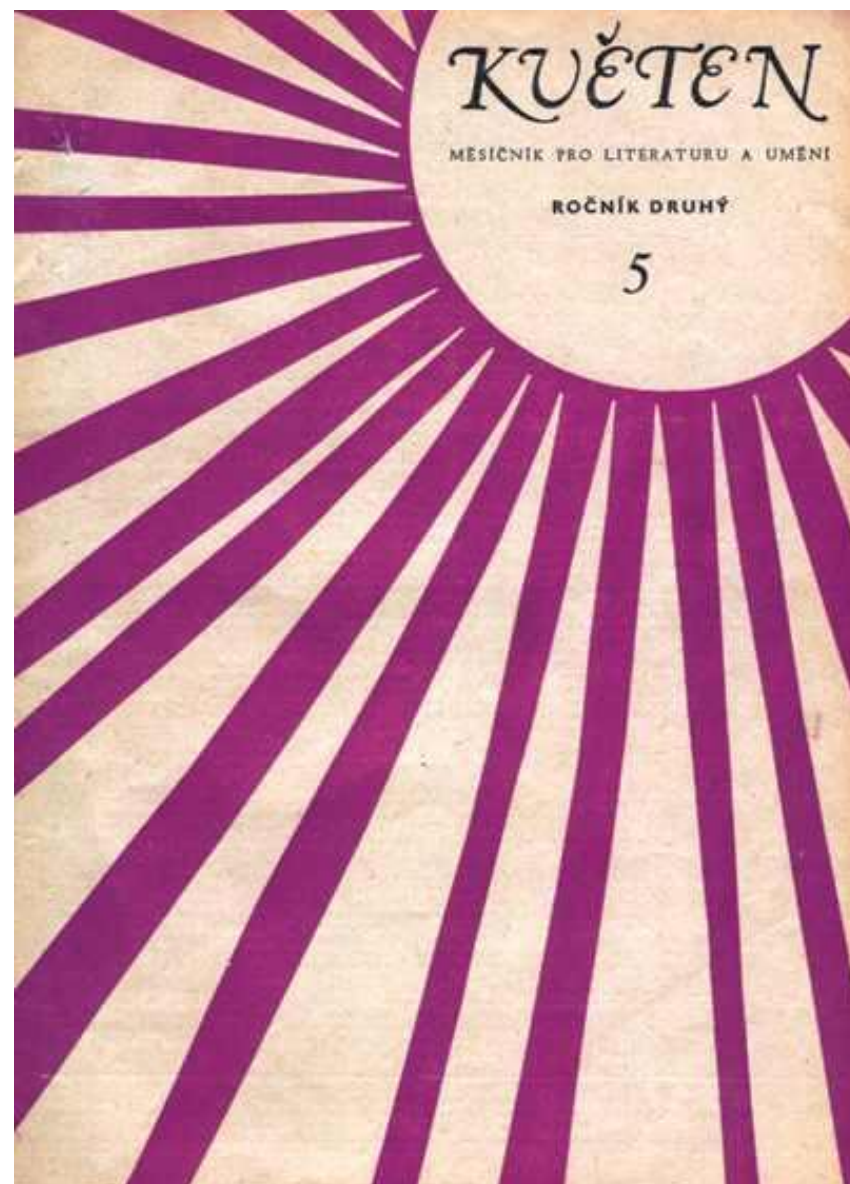



J. Martin, Laundress, 1952 – E. Kmentová, Washing off, 1957



J. Balcar, Painting, 1957

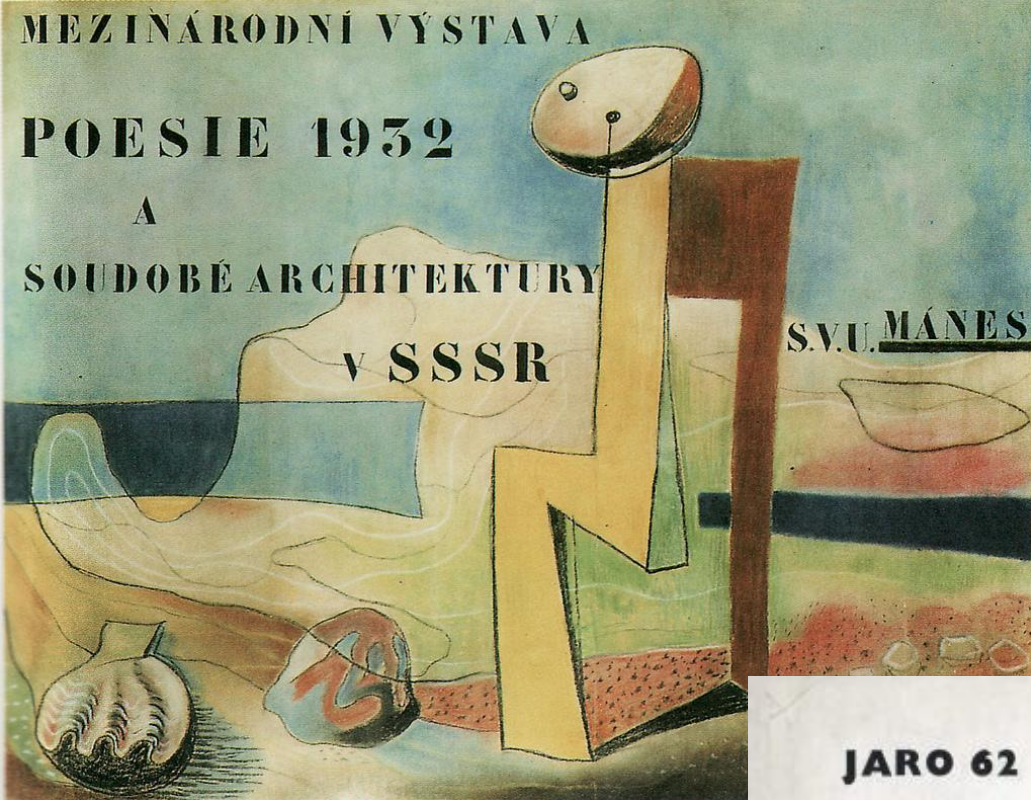



J. John – V. Boštík, Memorial to the Jewish Victims of the Holocaust, Pinkas Synagogue, 1954-59,

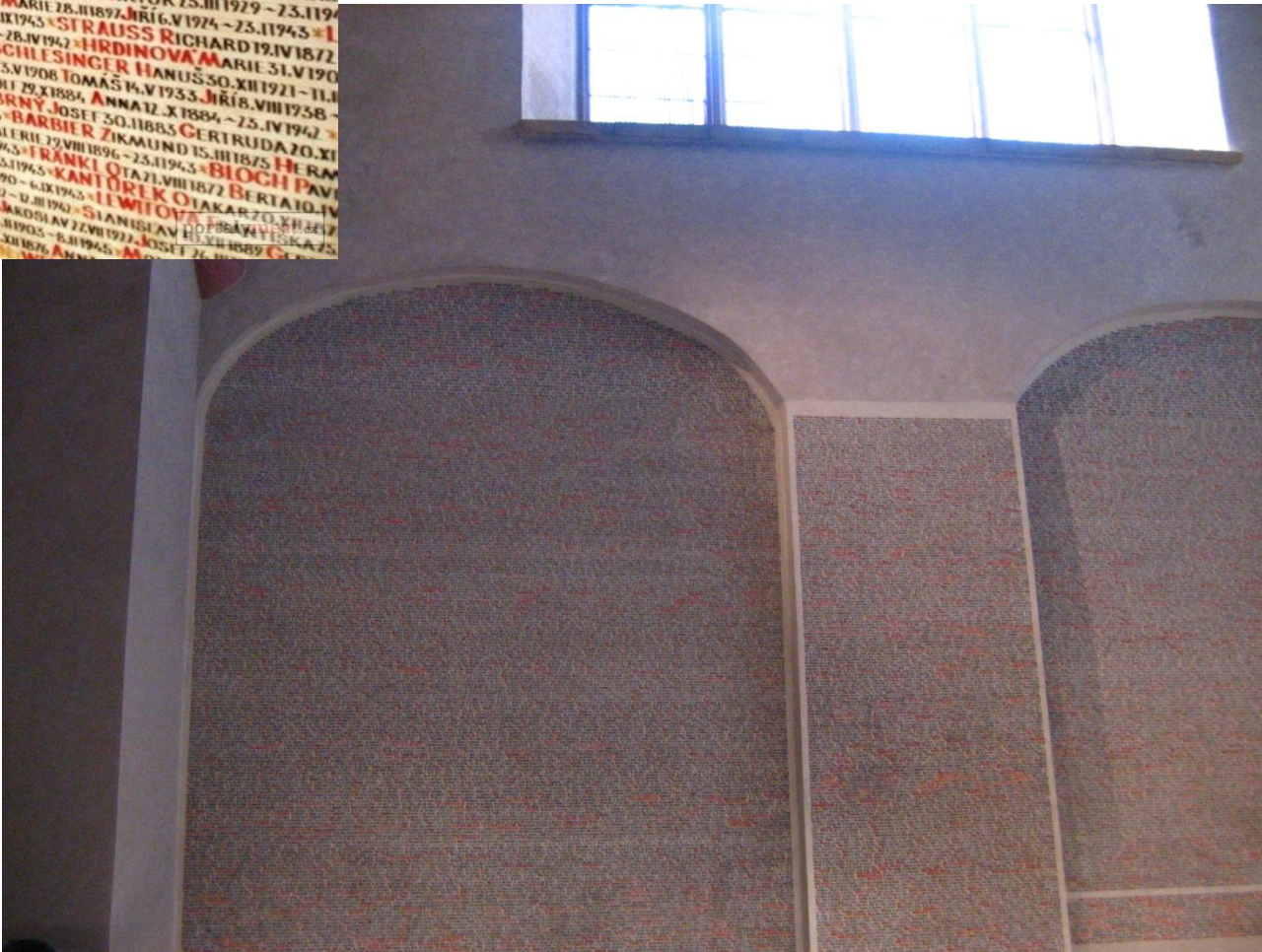



A. Waterkeyn, Atomium, Brussels, 1958



Cubr – Hrubý – Pokorný, Czechoslovak pavilion for Expo 58, 1957

## PŘÍZEMÍ

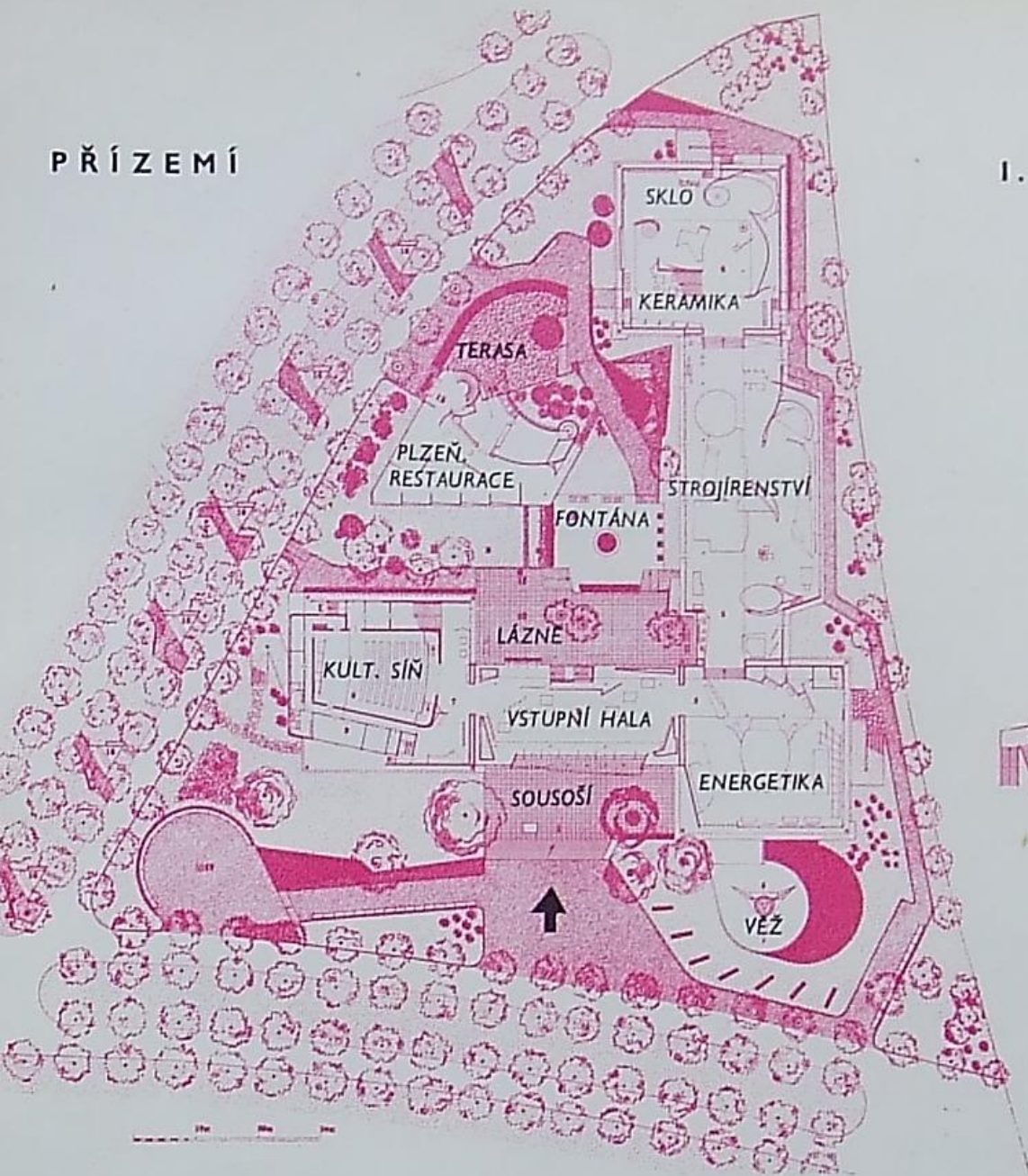

## I. PATRO

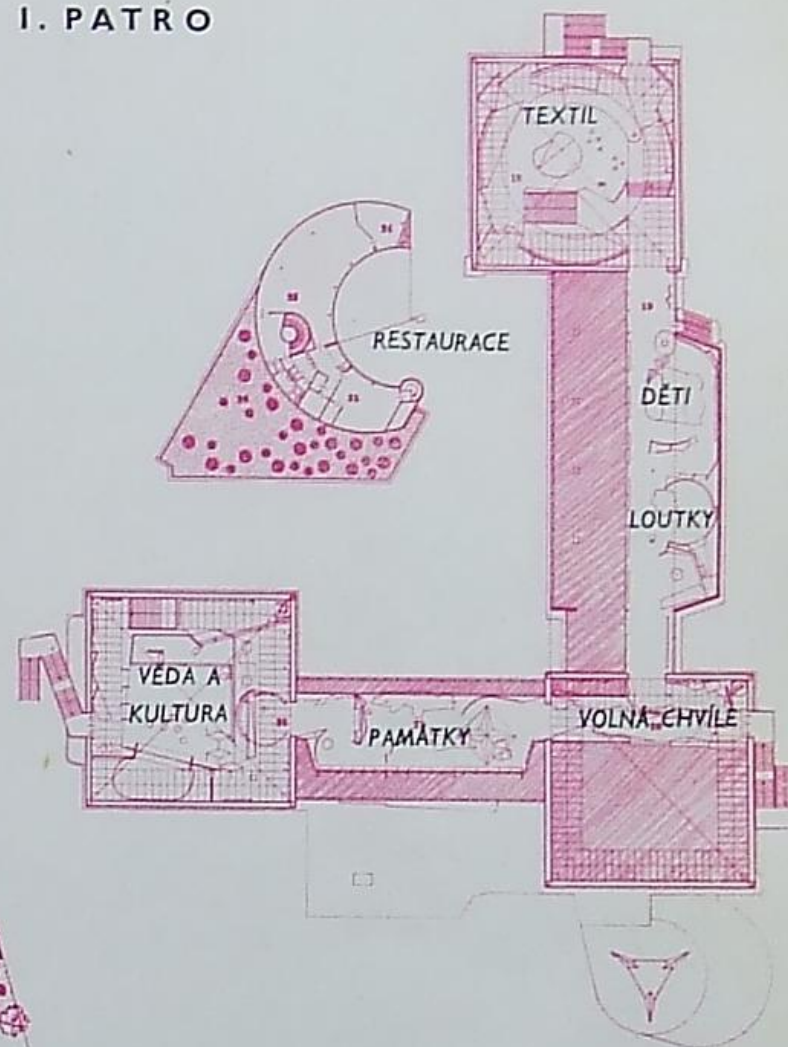











R. Roubíček, Glass Sculpture, 1958



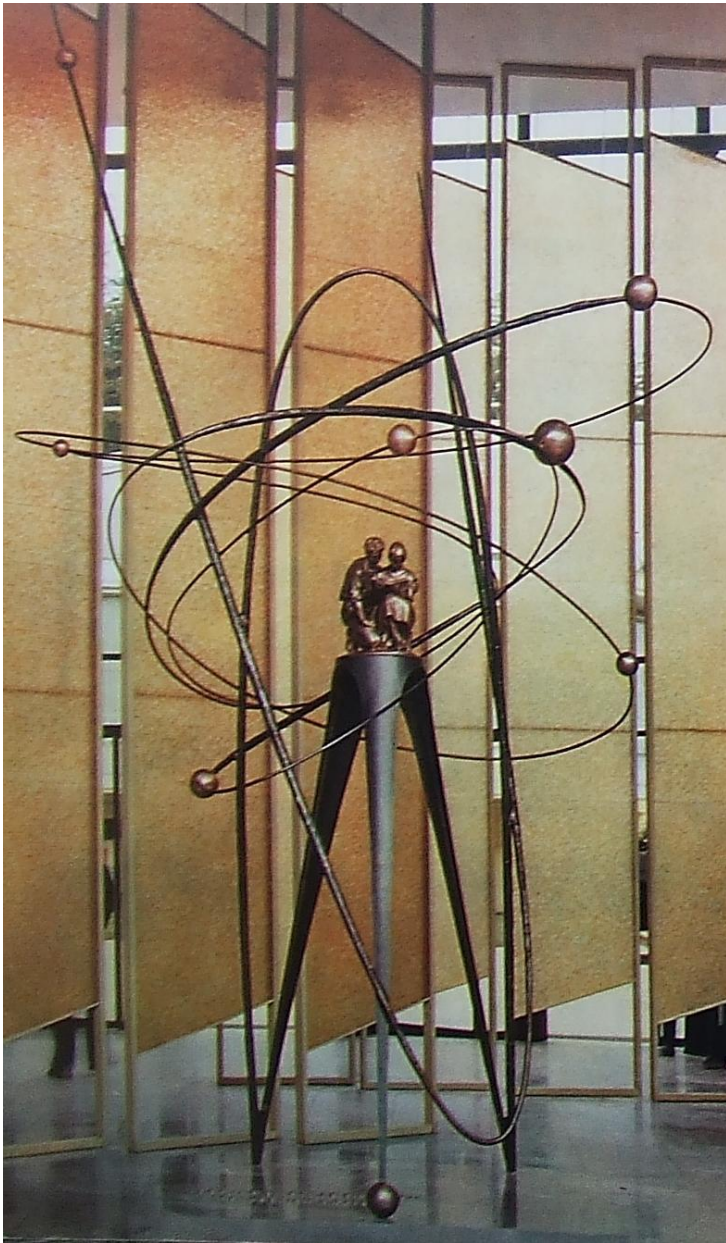

J. Klimeš, Everyone Has Right for Education, 1957-58

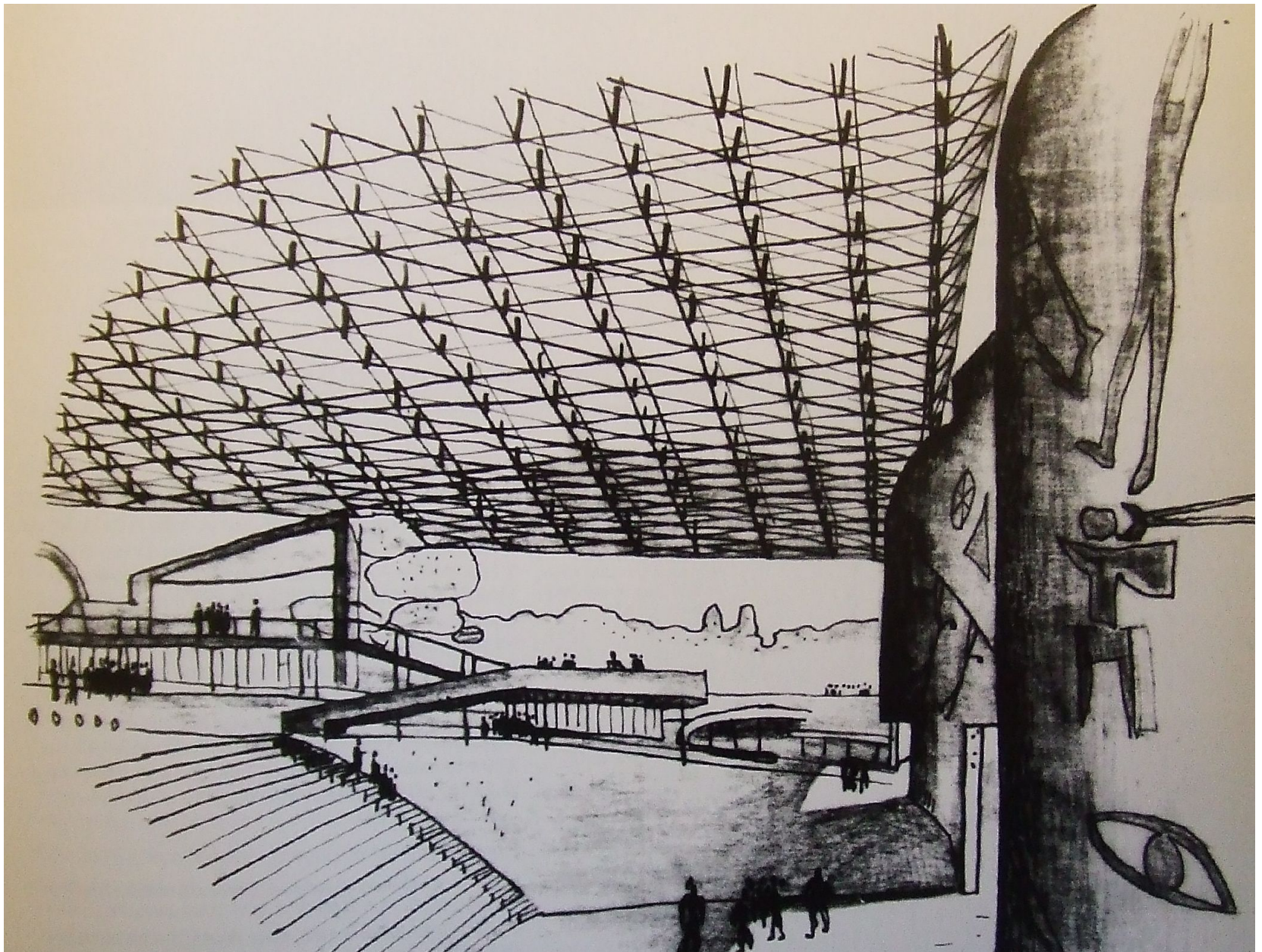

J. Soltan, Polish pavilion for Expo 58, 1956





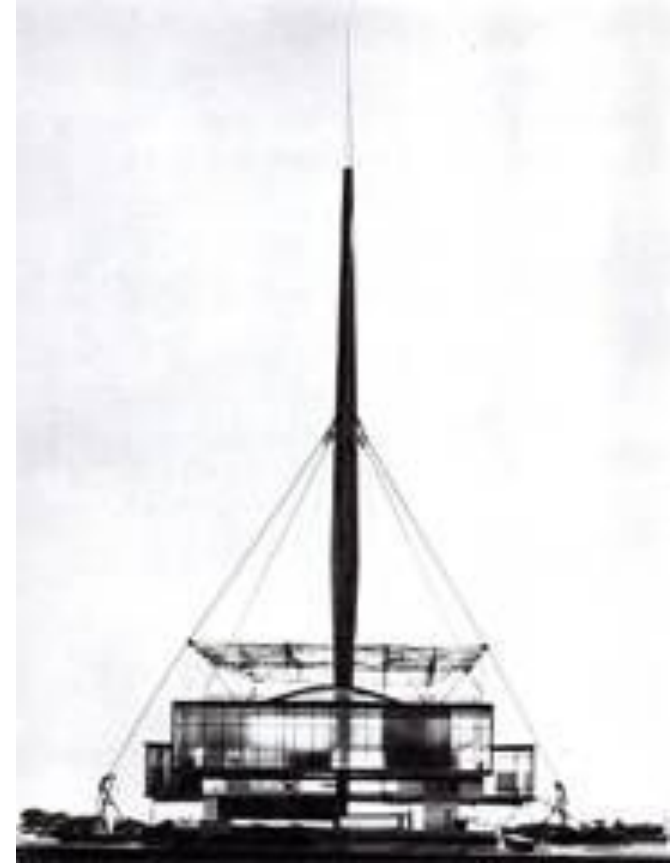

V. Richter, Yugoslavian pavilion for Expo 58



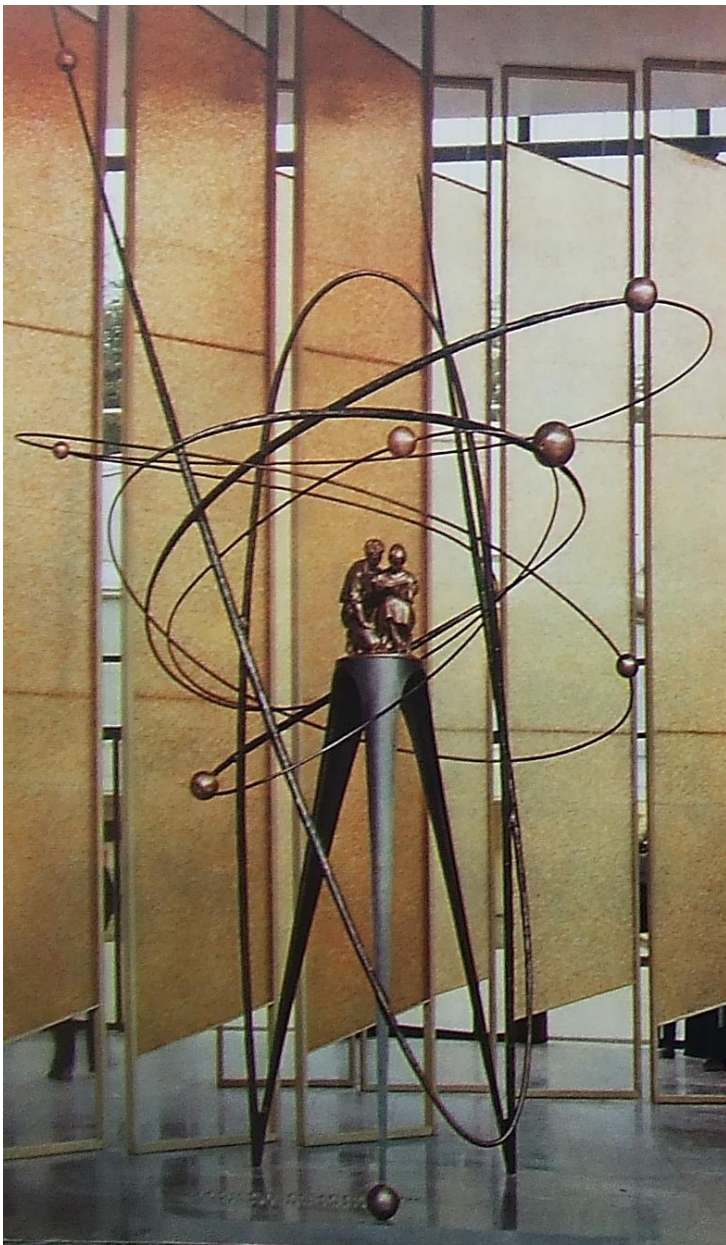

J. Klimeš, Everyone Has Right for Education, 1957-58

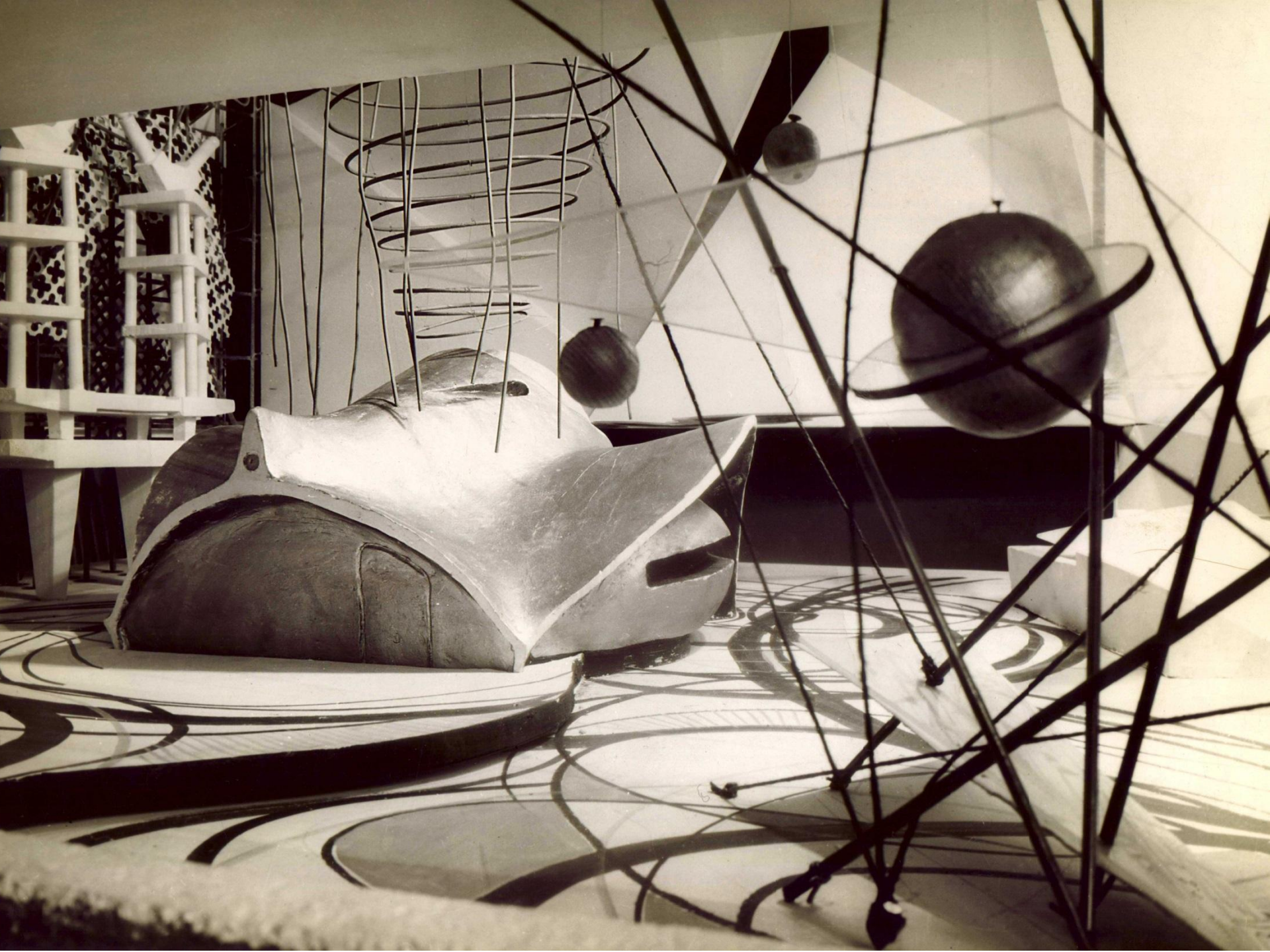





0

Přirodovědecký časopis  
Československé akademie věd  
ročník 37      prosinec 1958

# vesmír



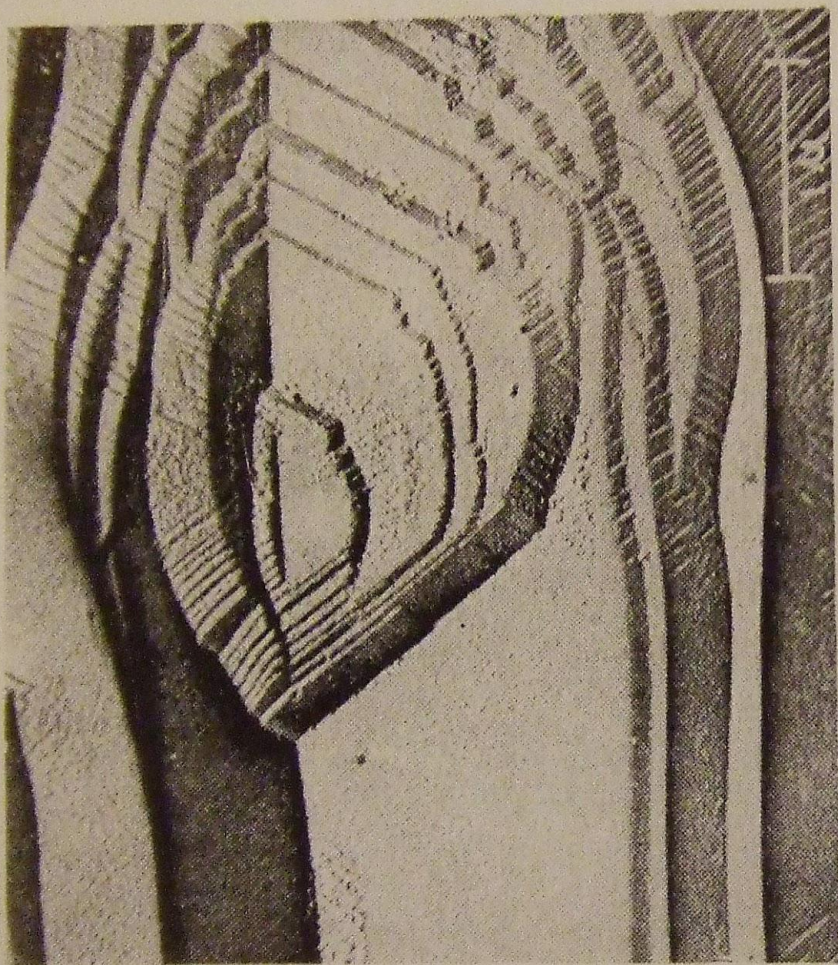

Struktura krystalu bariem titanátu v elektrovém mikroskopu

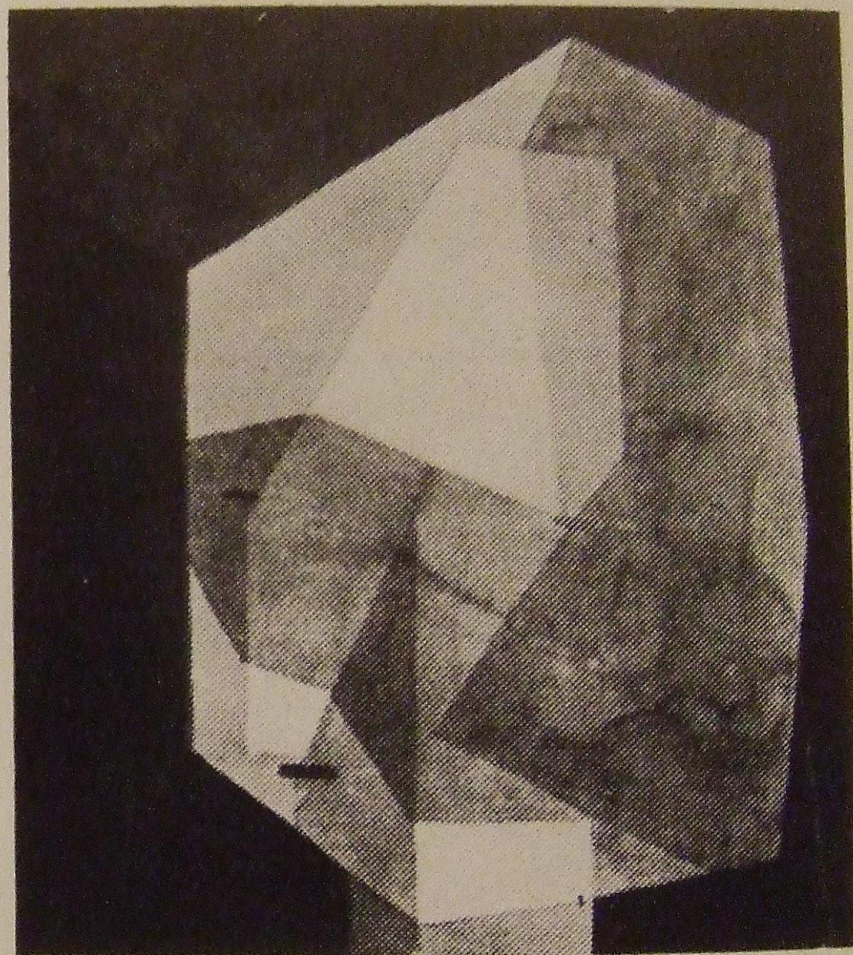

Paul Klee: Hrubě tesaná hlava. 1935

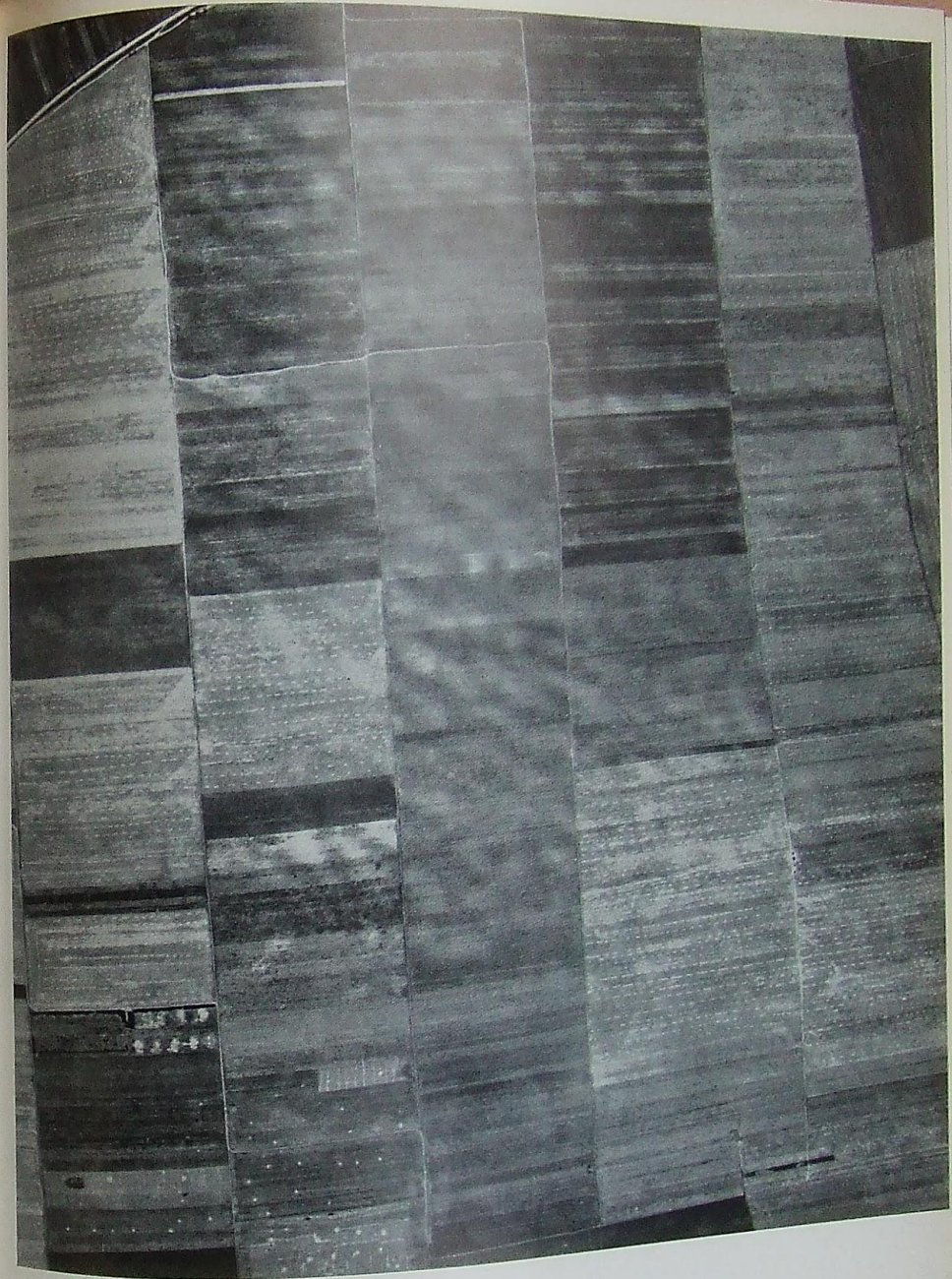
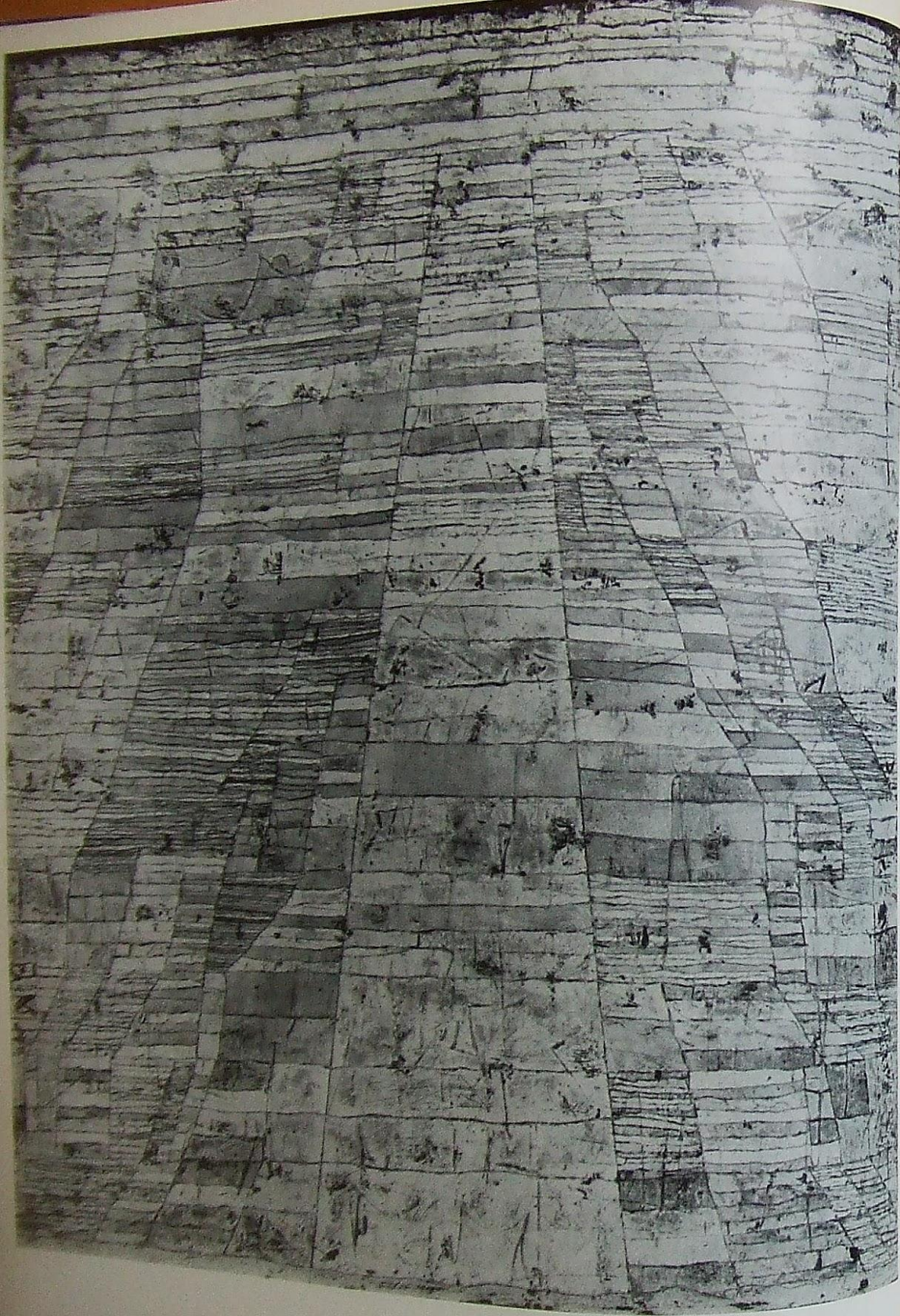

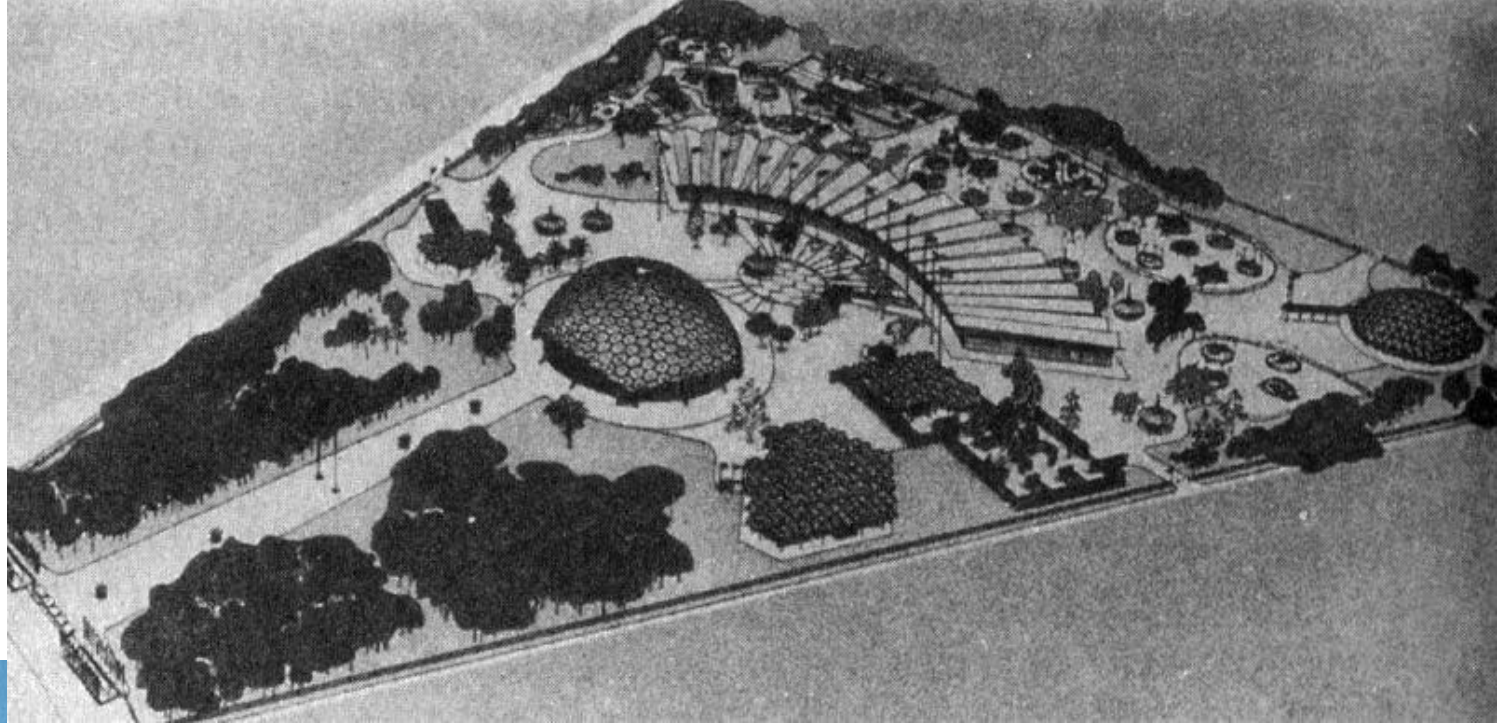

American National Exhibition,  
Moscow, 1959



E. Ervitt, Nikita Khrushchev and Richard Nixon, Moscow, 1959



“Kitchen Debate”, 1959

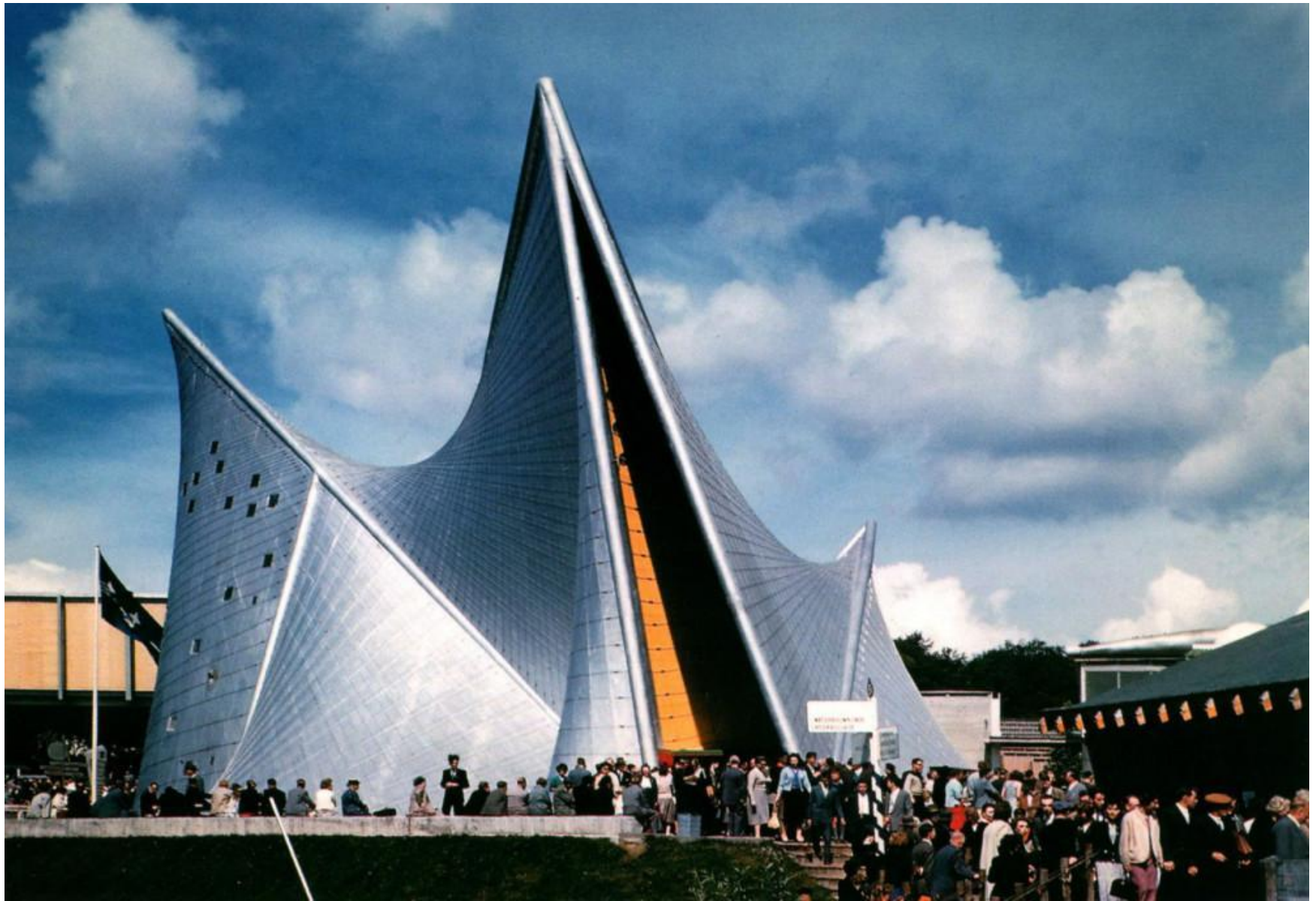

Le Corbusier – E. Varese, Philips Pavilion, Expo 58



Laterna Magika (Magic Lantern), Czechoslovak pavilion, Expo 58



Polyekran, Czechoslovak pavilion, Expo 58

R. Chory, Thaw, 1963

