



alcoframe | pro

NON-CONTACT BREATHALYZER FOR MONITORING
ALCOHOL INTOXICATION IN PERSONNEL

alcoramca.ru



Laser Systems company

The leading manufacturer of laser equipment



Over 20 years of advancement

Established in 1998 in St. Petersburg of Russia, the Laser Systems company, after more than 20 years of development, has by now taken rank as a leading Russian manufacturer of laser and optoelectronic equipment for industrial applications.

In 2014, Laser Systems launched serial production of its flagship product, Alcoframe, at its own 6,000 m² production plant.

Alcoframe devices have proven to be excellent at sites belonging to various industries, confirmed their efficiency in improving the labor discipline of employees and enhancing the work process safety.

alcoframe|pro

Breath Ethanol Vapor Analyzer

Designed for non-contact testing of personnel for alcohol intoxication. Indispensable wherever a drunk employee endangers the safety of human life and accident-free production process.

No special personal hygiene products, mouthpieces, or extension pieces are required to take the breathalyzer test. No need to remove one's medical mask.

One exhalation towards alcoframe|pro is enough: in a single second the device will analyze the air exhaled for the presence of ethanol vapor, with the result reported by means of color and sound indication.

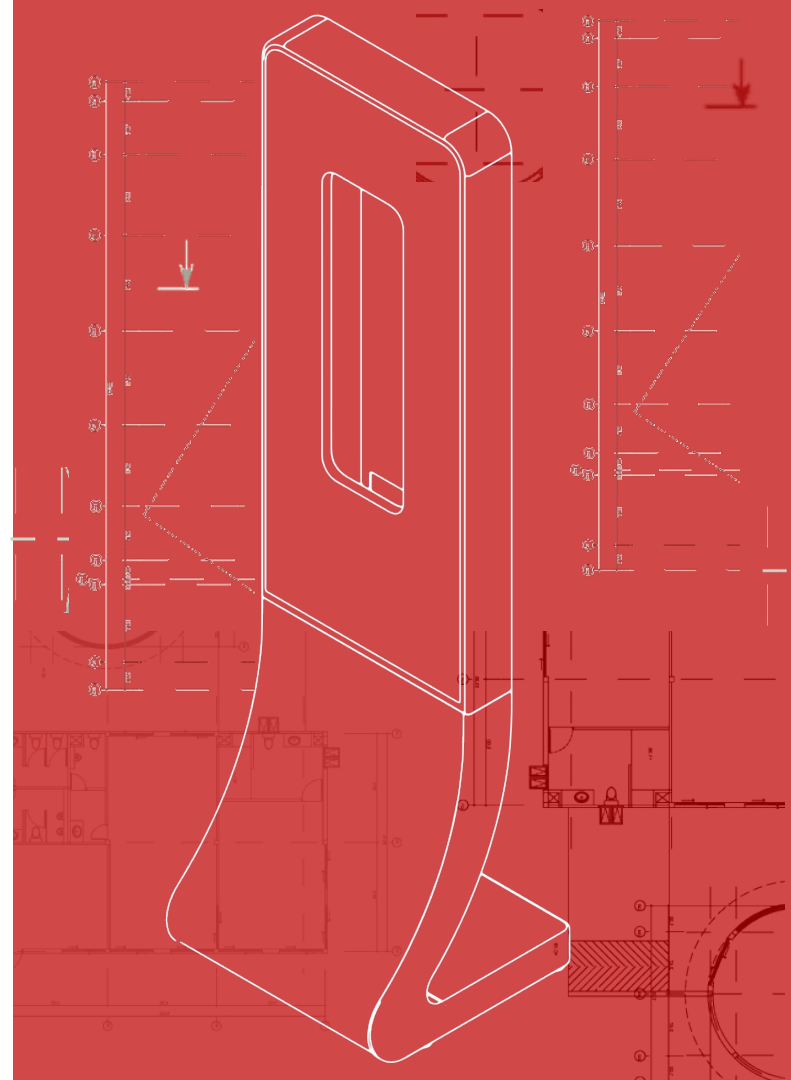

Install this at the entrance checkpoint(s) of your enterprise

Innovative Express Breathalyzer

The updated line of alcoframe|pro is a new generation of advanced alcoframe devices adapted for use in pandemic conditions, with modern styling and extended functionality.



Safe work process

By means of alcoframes, our customers ensure high safety performance of all employees, and reduce the risk of workplace injuries.

This cost-effective solution will reliably protect your personnel from incidents, increase employee efficiency, and help you save your money and reputation.



Accident-free production

Alcoframes are designed for a broad consumer market.

The equipment is widely in demand at industrial sites, fleet depots, transport companies, fuel and energy enterprises, companies operating hazardous production processes and everywhere else where a drunk employee endangers human life, safety and financial stability of the company.

According to ROSSTAT

Incident Rate at Work

25,400

Incidents

At work; average number recorded in Russia each year

1,100

Fatal cases

Injuries and severe bodily harm

45%

Alcohol-related

Violation of labor discipline while intoxicated

16 m.₽

Fine/penalty amount

Charged by a Russian steel company to its contractors for having their personnel present drunk at the site

According to the HEADHUNTER Research Center

71 % of Russians have consumed alcohol at work at least once

Question 1

Do you consume alcohol at work?

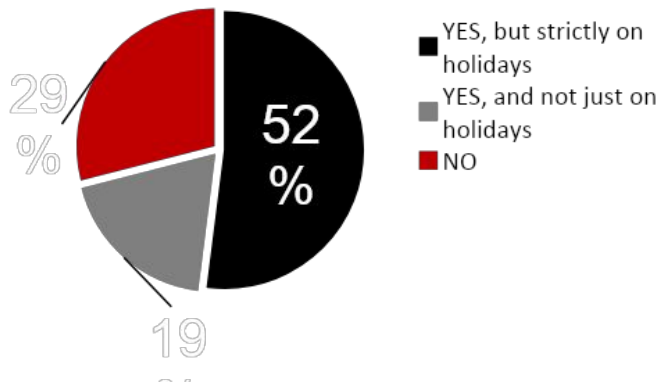

Question 2

How often do you consume alcohol at work?

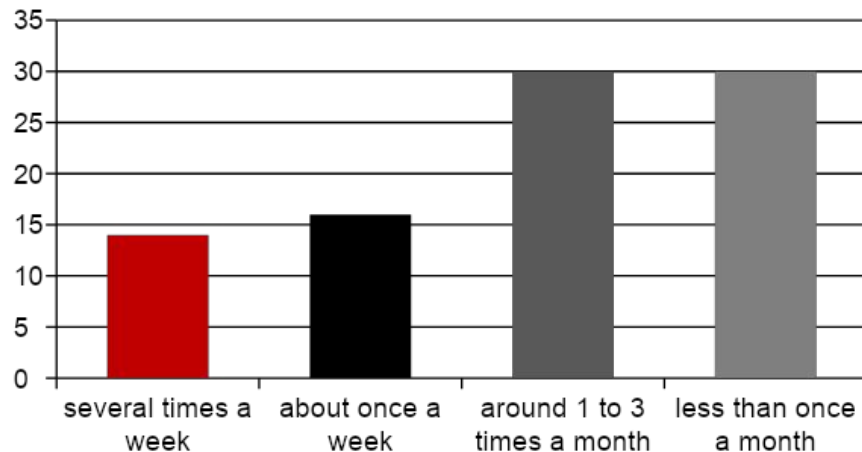



алкорамка|про

An efficient solution to keep your
personnel and business secure

Ensures

Identification of drunk employees and the ability to prevent accidents and incidents at work.

Monitors

Industrial facilities, motor depots, transport companies, enterprises operating hazardous production processes, and any urban infrastructure facilities.

Solves

The task of daily collection, processing and analysis of information followed by the formation of statistics for each employee and database storage.

Drunk employee at the workplace:

Expensive, Dangerous, and Inefficient

1

Work-related injuries

While intoxicated, employees may injure themselves in a variety of ways, including falling from heights, electric shock, and physical injuries. What is important is that such an employee endangers not only his own life, but also the lives of others.

2

Accident Events

Breakdown of expensive equipment is another common consequence of drinking alcohol at work. As a rule, this leads to an emergency shutdown of production and a chain reaction of further detrimental consequences.

3

Financial Losses

Article 5.27 of the Russian Code of Administrative Offences states that a fine for violation of labor safety requirements shall be imposed only on the employer or on the responsible officials.

4

Reputation risks

Usually information about incidents spreads quickly and goes beyond the corporate space. Drunk employees tarnish the company's image, both internally and in the outside business community.

5

Legal Liability

Pursuant to Article 76 of the Russian Labor Code, employer must suspend from work any employee having appeared under the influence of alcohol, drugs or other intoxication.

6

Moral Damage

Accidents, incidents and other emergencies at work inevitably entail a violation of morale in the team, as well as stress and disturbances to the employer.

Use alcoframe|pro

Reduce the risks, increase the productivity

Do not keep at work any disruptive employees, who pose a threat to others



Labor Code of the Russian Federation, Article 81. Termination of a Labor Agreement on Employer's Initiative, states: "A labor agreement can be terminated by an employer in the following cases: appearing at working place (at the workplace or on the premises of the employer organization or the facility where the employee has to perform a job function on behalf of the employer) in a state of alcoholic, narcotic or other intoxication".

CHOOSE SAFETY

Stop a drunk person at the entrance checkpoint

- At the checkpoints, have absolutely all your workers checked, including those from contractors and any employees working at fields on a rotational basis.
- If there is an access monitoring and control system (AMCS) installed at the entrance checkpoint, the test results will be automatically compared with the employee data.
- The results of breathalyzing for each employee will be recorded and stored in the AMCS database, so the statistics will be accumulated.

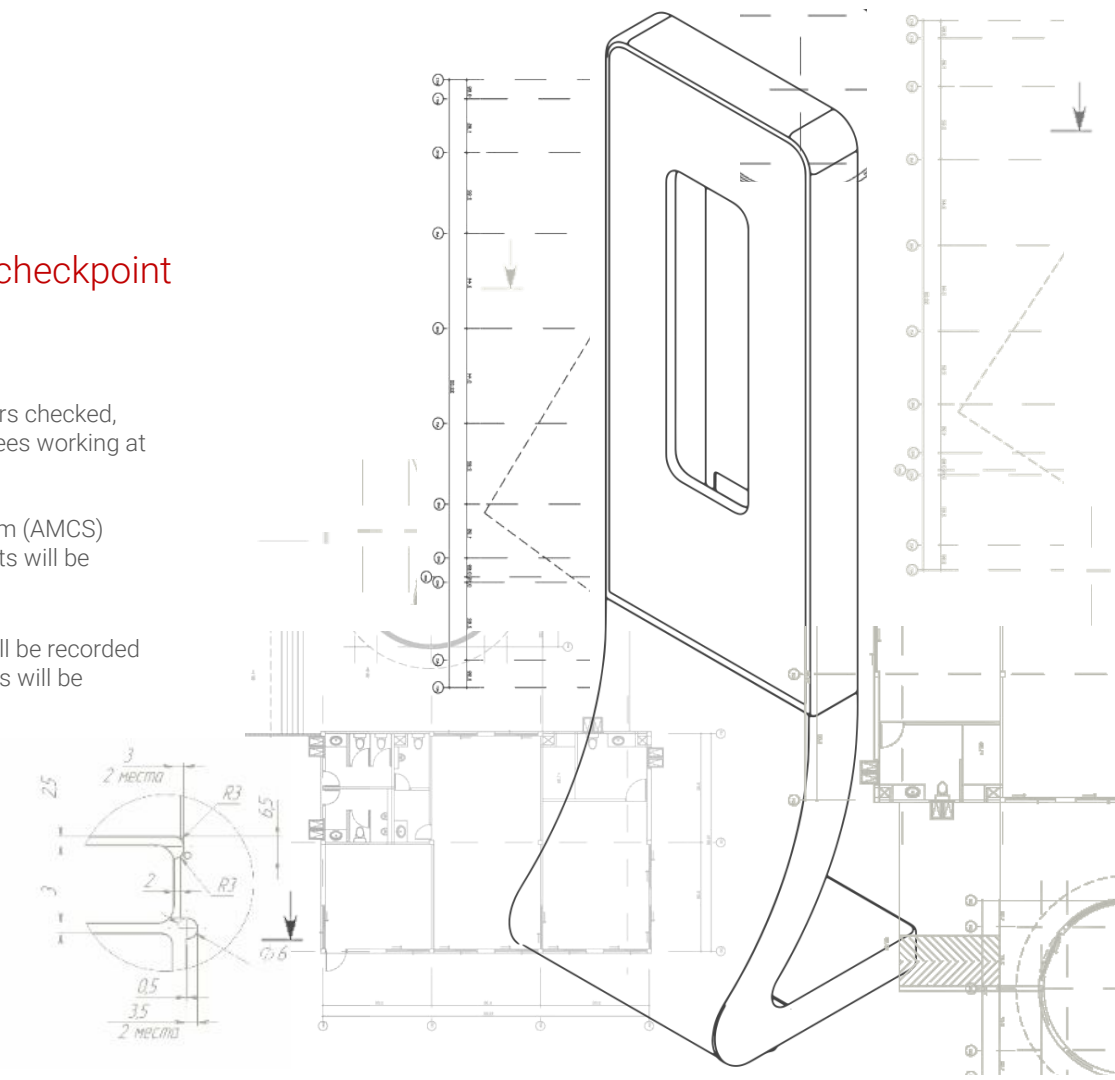

алкорамка|про

ЛАЗЕРНЫЕ
СИСТЕМЫ

ALCOFRAME



SAVE YOUR MONEY AND REPUTATION

Being intoxicated at work is dangerous and illegal. This can lead to irreparable consequences. The number of risks for the employer is enormous indeed. These include the ones associated with the company's prestige, protection of personal data, possible environmental damage, loss of profits, and payment of fines and penalties.

alcoframe|pro provides one hundred percent protection against the above factors, ensuring that any drunk employee is identified.

Appreciate all the benefits offered by alcoram|pro

Understandable, convenient and as easy to use as possible



Minimal maintenance

The device requires only infrequent cleaning of mirrors, and is equipped with a self-diagnostic system



Ultra-precise measurement performance

Powered by unique technology, it measures ultra accurately and error-free



Integratable with a new and/or existing AMCS

Easy to integrate into any infrastructure, adaptable to the existing security system



Measurements even if a person is wearing a medical mask

No need to remove the mask when taking a breathalyzer test



Creation of a single database of all tests

Special software to compile a database from several devices, conduct analysis, and generate reports



Flexible customization

Adjustable according to the customer's wishes as to the alarm threshold and other parameters



Long service life

Runs non-stop for 7 years, with an extended two-year warranty



No operation expenses

Does not require any purchase of consumables, calibration, or sensor replacement



Detailed report, analytics and statistics

Saves the test results daily when integrated into an AMCS

Apply the best solutions to protect your business

Conduct measurements around the clock, quickly and continuously



All-day autonomous operation

Operates autonomously in 24/7 mode and automatically triggers on exhalation, processes measurements and reacts to the presence of ethanol vapor



Record high pass-through capacity

Conducting measurements in real-time mode, the device has a maximum pass-through capacity of 25 people per minute.



One second for one testing

Needs only 1 second to test a person for alcohol intoxication, and in another second the device is ready for the next test.



Continuous measurement mode

The service life is over 50,000 hours, which makes up over 5 years of continuous operation.

Test the simple algorithm of the device operation

Alcohol at Work: Identify and Defuse



Use alcoframe|pro

Combined with a thermal control device

We offer a comprehensive solution providing for simultaneous operation of two devices: alcoframe|pro and a thermal control device.

This allows for parallel concurrent testing on two parameters at once, namely sobriety and body temperature of a person.

- ✓ Sobriety monitoring
- ✓ Temperature monitoring

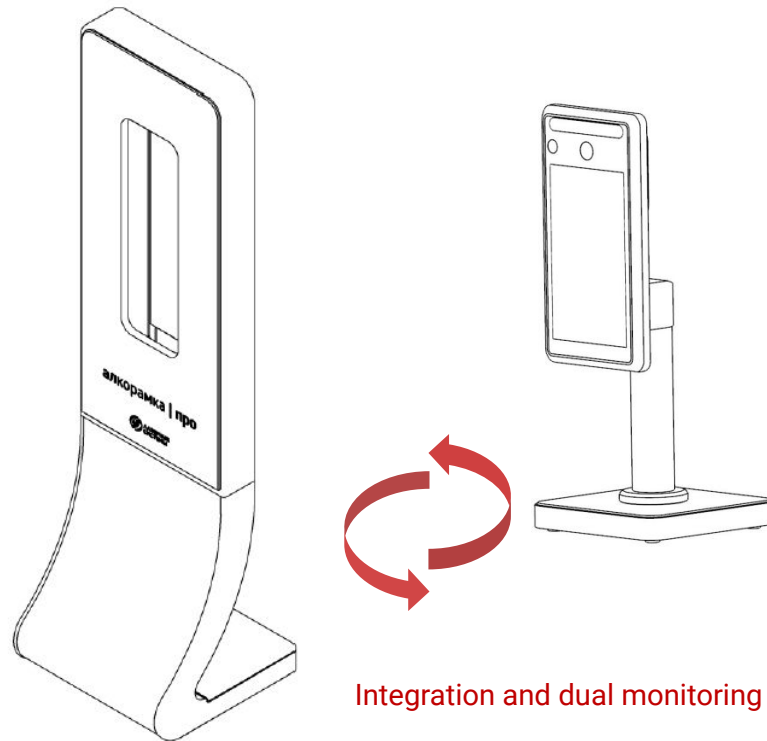

Call or write us right now!

Enjoy the best deals



1

Expert Advice

We supply alcoframepro solutions for facilities belonging to any industry. We will be delighted to answer all your questions as to individualizing the equipment to your task.

2

We are ready to offer you a handout sample

We will install a handout sample to provide you with the opportunity to see in practice all the benefits of using alcoframepro.

3

Extended Warranty

Each of our customers is provided with warranty service and full information support throughout the project.

During a worsening epidemiological situation

A mathematic simulation of exhalation propagation for a person having a face mask on:

- 1 demonstrates the same patterns of movement of the air exhaled, with:
no alcoframe (Figures 1 and 2)
alcoframe in place (Figures 3 and 4)
- 2 shows that the alcoframe is safe to use under epidemiological conditions.

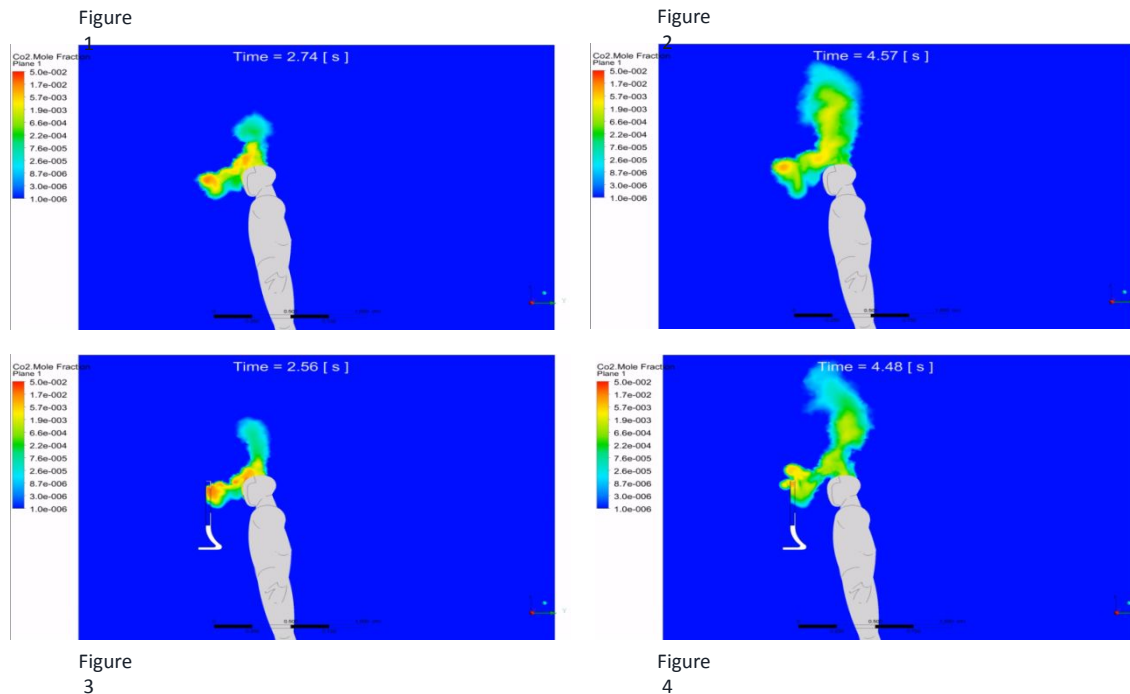

* "Co2 mole fraction" – concentration of carbon dioxide (CO₂), ratio of the amount of a substance to the total amount of all substances

Over 200 customers in and beyond Russia

Core customers, by industry



Gas Production



НОРНИКЕЛЬ

Mining



ДОМОДЕДОВО
МОСКОВСКИЙ АЭРОПОРТ

Airports



РОСНЕФТЬ

Oil Production



РОСАТОМ

Nuclear

МИРАТОРГ

Food

ЕВРАЗ

Iron & Steel



СУЭК
СИБИРСКАЯ УГОЛЬНАЯ
ЭНЕРГЕТИЧЕСКАЯ КОМПАНИЯ

Coal

Over 1,000 entrance checkpoints across Russia

Geographic Footprint

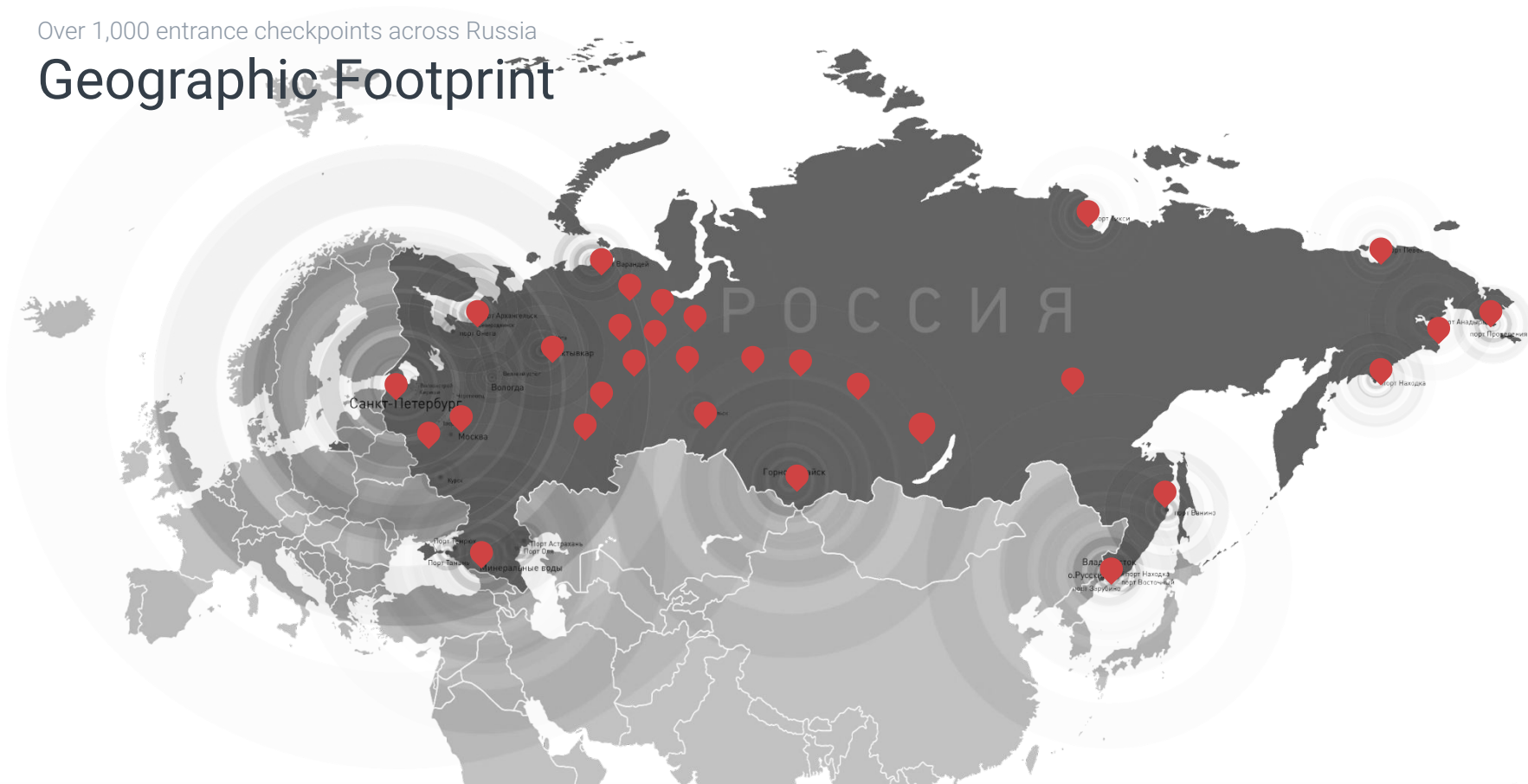

Positive Customer Feedback



Moscow Domodedovo Airport

"The company's representative office would like to express its gratitude to Laser Systems Company for successful cooperation in ensuring the security of the Russia's largest aviation gateway – Moscow Domodedovo Airport. The device for non-contact remote express testing, Alcoframe, developed by the specialists of your company, is considered to be a part of a comprehensive project aimed at ensuring security of a strategic facility of the transport industry. We look forward to a further efficient joint work with you."



JSC OEMK n.a. A. A. Ugarov

"May 18 to 30, in JSC OEMK n.a. A. A. Ugarov, a device for non-contact remote express testing for alcohol intoxication, Alcoframe, was tested. The average passage rate of workers through the Alcoframe, subject to 'correct exhalations,' was 12 to 15 people per minute. No malfunctions, incorrect operation of Alcoframe, or any other complaints were detected during the tests."



LLC SUEK-KHAKASIA

"During the tests, we appreciated all the features of breathalyzing with the Alcoframe device: high pass-through capacity; fast analysis of exhalation and delivery of the result in 1 second; the ability to store the results data. The Alcoframe device was installed in the medical office, where certain personnel are required to undergo testing for alcohol intoxication. Consequently, the time required to conduct 600 tests was reduced by 2 to 3 times, with human mistake factor completely eliminated."



JSC Razrez Stepnoy Coal Company

"The use of the equipment has greatly increased employee discipline. The equipment has proven to be highly reliable. No equipment failures have been recorded. The equipment does not require the operating personnel to master any additional knowledge or skills. Following the tests, it has been decided to have the AMCS-integrated Alcoframe system of non-contact express testing for alcohol intoxication introduced at the enterprise and implemented as part of checkpoint equipment."

Learn more about our product!
Visit us at alcoramca.ru

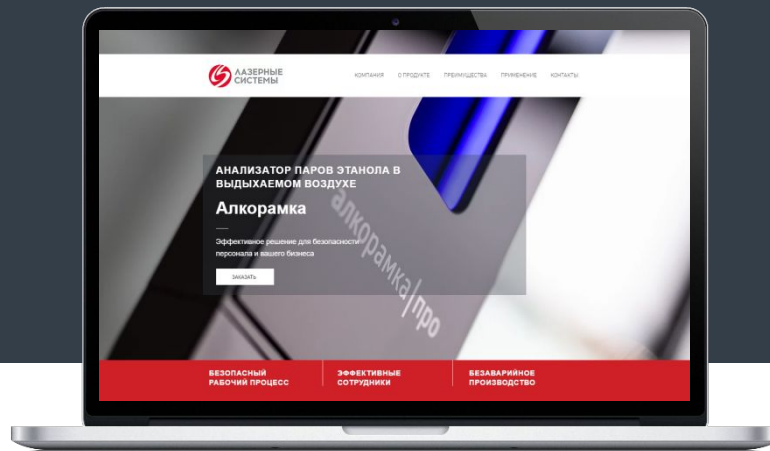

TRADE-IN

LET'S **SWAP** IT FOR A NEW ONE

alcoframe|pro is a participant of the trade-in program for the exchange of the preceding model of equipment for a new one with an upgraded styling, extended functionality, that can be used in pandemic conditions without removing the face mask. We offer comprehensive service support to our customers: we install handout samples at their enterprises and provide them with an extended warranty.



Contact Us

28/2, Svyazi str., bldg. 1, Strelna
settlement, 198515, St. Petersburg, Russia



Tel. +7 (812) 612-02-88
Fax +7 (812) 612-02-89



sales@lsystems.ru



lsystems.ru