

The Empire State Building



The Empire State Building is a 102-story skyscraper located on Fifth Avenue between West 33rd and 34th Streets in Midtown, Manhattan, New York City. It has a roof height of 1,250 feet (381 m), and with its antenna spire included, it stands a total of 1,454 feet (443 m) high. Its name is derived from the nickname for New York, the Empire State. The Empire State Building is currently the fifth-tallest completed skyscraper in the United States and the 29th-tallest in the world. It is also the fifth-tallest freestanding structure in the Americas. When measured by pinnacle height, it is the fourth-tallest building in the United States.



The Empire State Building is an American cultural icon. It is designed in the distinctive Art Deco style and has been named as one of the Seven Wonders of the Modern World by the American Society of Civil Engineers. The building and its street floor interior are designated landmarks of the New York City Landmarks Preservation Commission, and confirmed by the New York City Board of Estimate. It was designated as a National Historic Landmark in 1986. In 2007, it was ranked number one on the AIA's List of America's Favorite Architecture

History

The site of the Empire State Building was first developed as the John Thompson Farm in the late 18th century. At the time, a stream ran across the site, emptying into Sunfish Pond, located a block away. Beginning in the late 19th century, the block was occupied by the Waldorf-Astoria Hotel, frequented by The Four Hundred, the social elite of New York.

The limestone for the Empire State Building came from the Empire Mill in Sanders, Indiana which is an unincorporated town adjacent to Bloomington, Indiana. The Empire Mill Land office is near State Road 37 and Old State Road 37 just south of Bloomington. The Bloomington, Bedford, and Oolitic area is known locally as the limestone capital of the world.

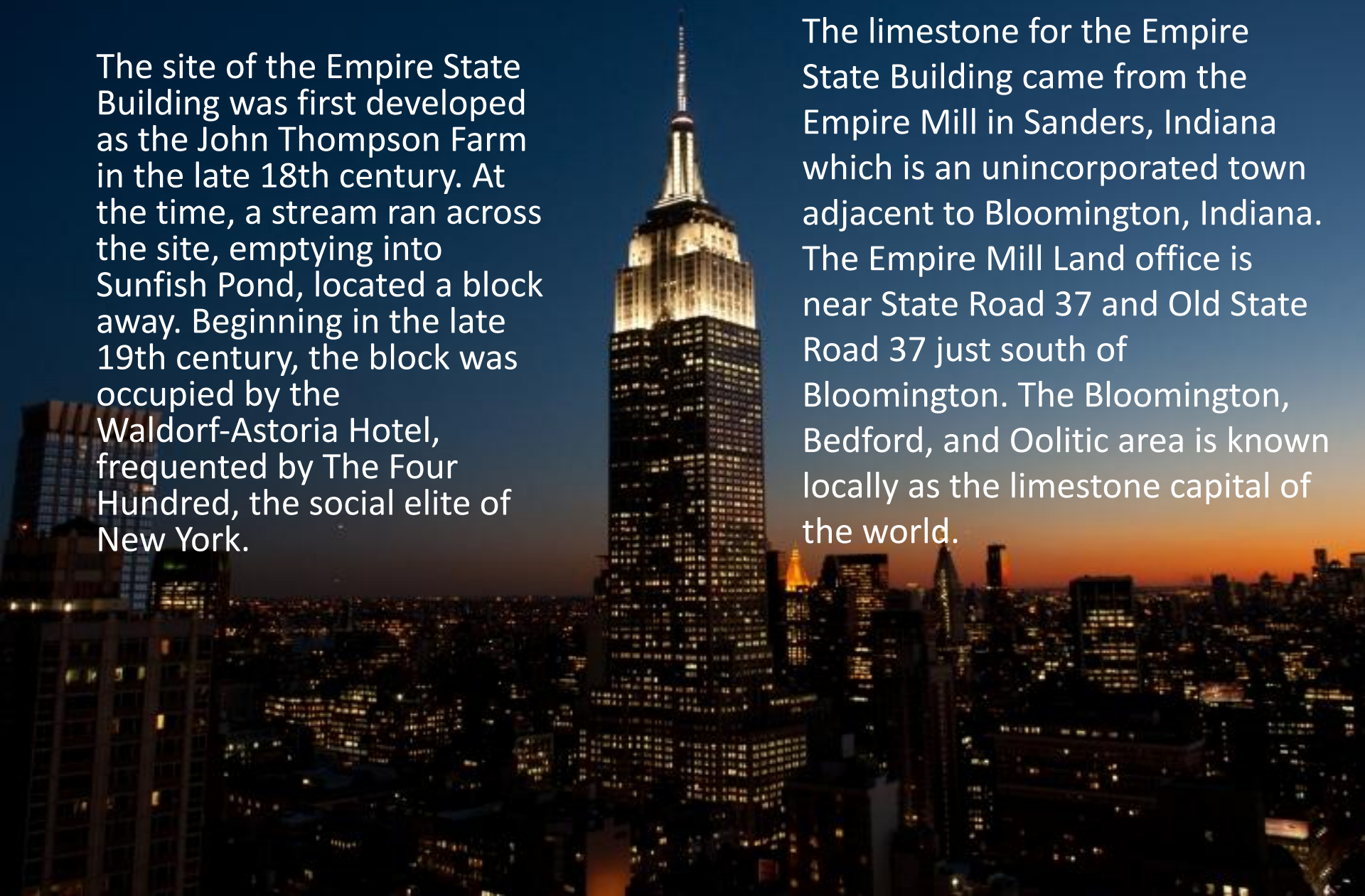

Design and construction

The construction was part of an intense competition in New York for the title of "world's tallest building". Two other projects fighting for the title, 40 Wall Street and the Chrysler Building, were still under construction when work began on the Empire State Building. Each held the title for less than a year, as the Empire State Building surpassed them upon its completion, on April 11, 1931, 12 days ahead of schedule, just 410 days after construction commenced.

The building was officially opened on May 1, 1931 in dramatic fashion, when United States President Herbert Hoover turned on the building's lights with the push of a button from Washington, D.C. Ironically, the first use of tower lights atop the Empire State Building, the following year, was for the purpose of signaling the victory of Franklin D. Roosevelt over Hoover in the presidential election of November 1932.



Interior

The building has 85 stories of commercial and office space representing 2,158,000 sq ft (200,500 m²) of rentable space. It has an indoor and outdoor observation deck on the 86th floor. The remaining 16 stories represent the Art Deco tower, which is capped by a 102nd-floor observatory.

The Empire State Building was the first building to have more than 100 floors. It has 6,500 windows and 73 elevators, and there are 1,860 steps from street level to the 102nd floor.



Lights

In 1964, floodlights were added to illuminate the top of the building at night. Since 1976 the spire has been lit in colors chosen to match seasonal and other events, such as St. Patrick's Day, Christmas, Independence Day and Bastille Day.

Floor plan

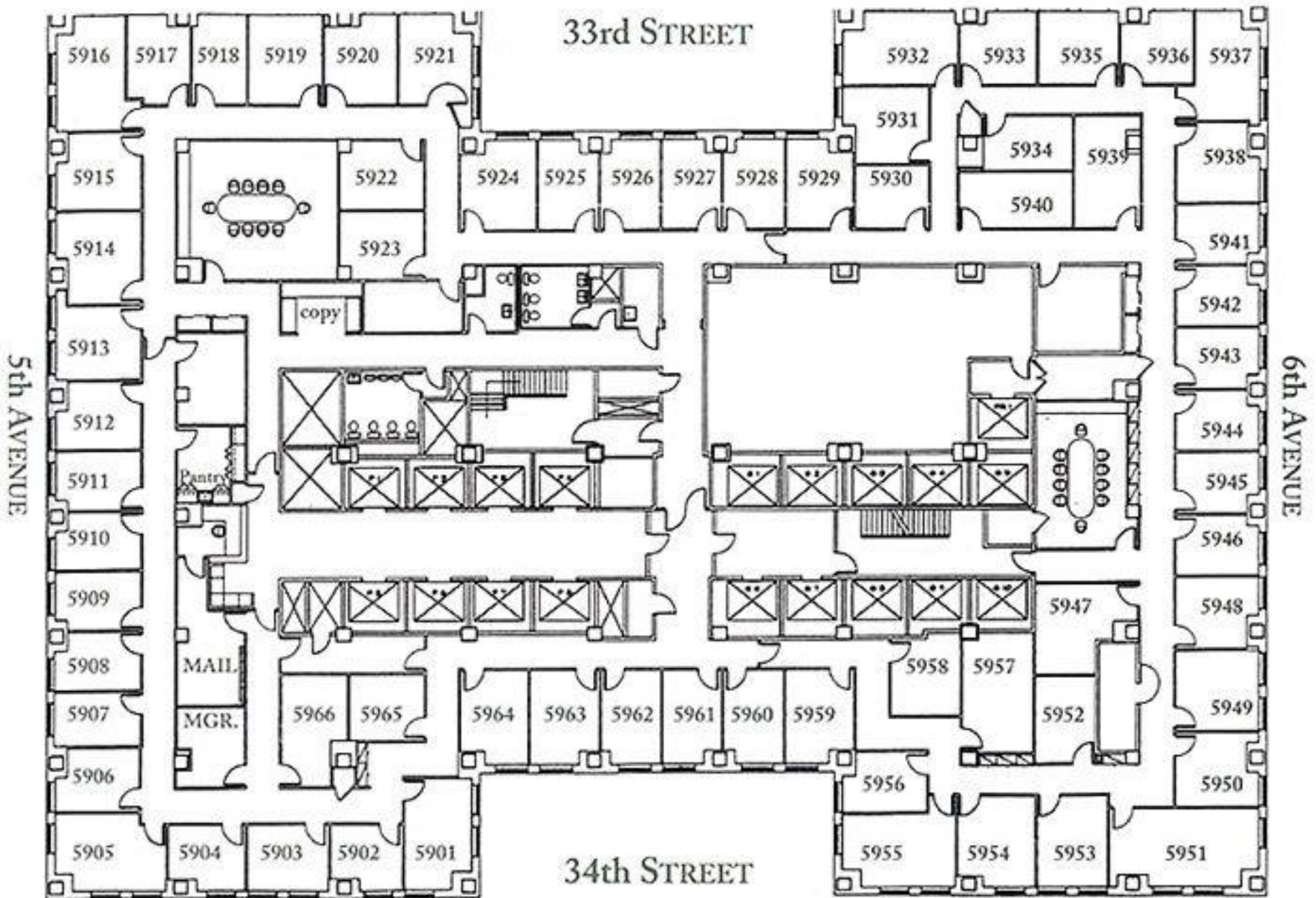



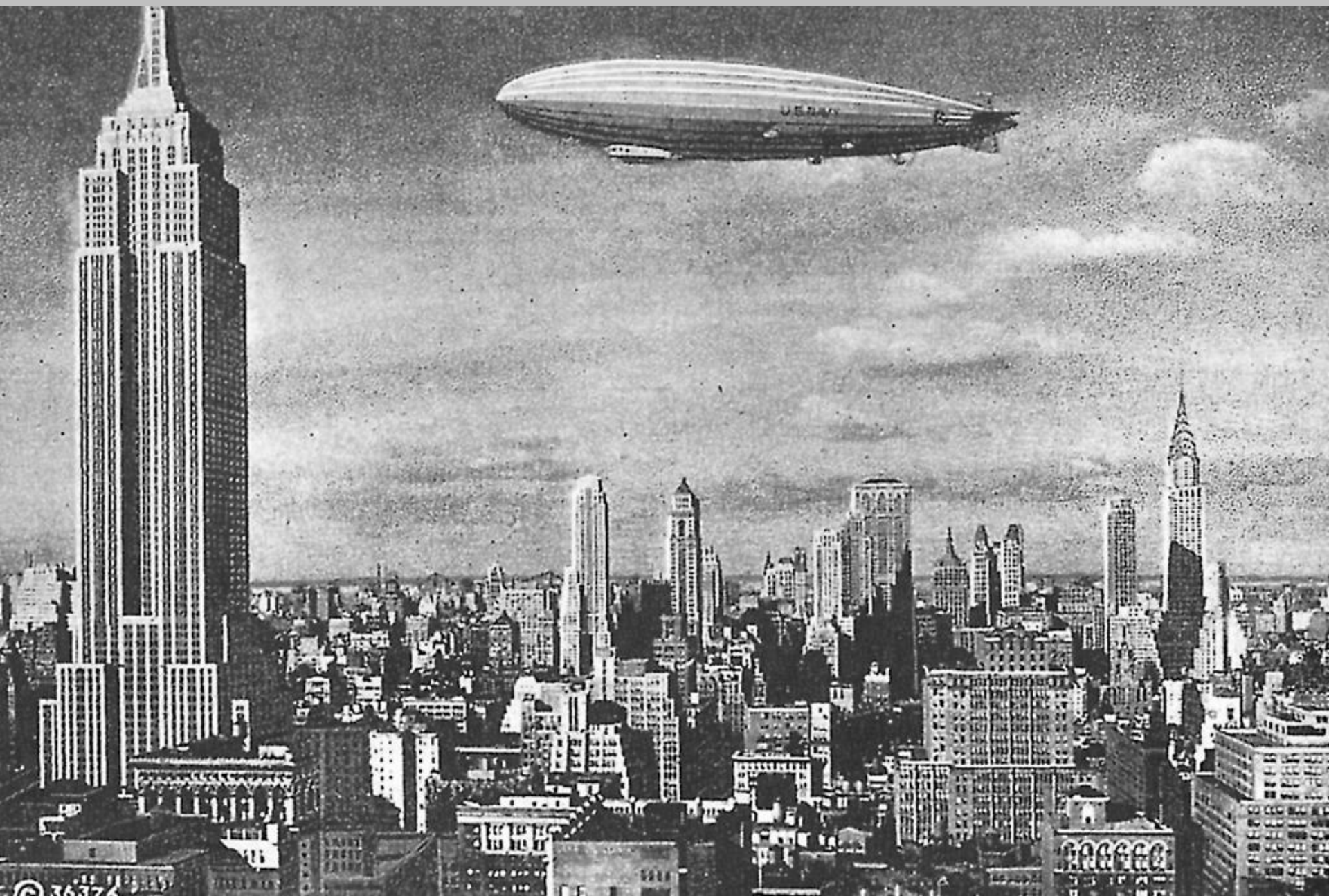

Thank you for attention

