



Why is it a good idea to learn how to read a map?



Holidays and travel

- Reading maps skill
- Places in a town
- Prepositions of place
- Ask and give directions to find a place
- Practice new vocabulary in the role plays

Think of 3 places/buildings/things you see in town on your journey from home to school

ASKING FOR DIRECTIONS

- How do I get to...?
- How can I get to...?
- Can you tell me the way to.....?
- Excuse me where is.....?
- Is there anear here?



ON



IN



OVER



UNDER



IN FRONT OF



BEHIND



BETWEEN



**ACROSS FROM
(OPPOSITE)**



THROUGH



**NEXT TO
(BESIDE)**

GIVING DIRECTIONS

. GIVING DIRECTIONS

- Go straight on
- Turn left/right (into ... street).
- Go along /up / down ... street
- Go across
- Take the first/second road on the left/right
- It's on the left/right.

. GIVING DIRECTIONS

- opposite
- near
- next to
- between
- at the end (of)
- on/at/ around the corner
- behind
- in front of

How do you say these words in your language?

Giving Directions

VERBS



turn left



turn right



go straight
ahead

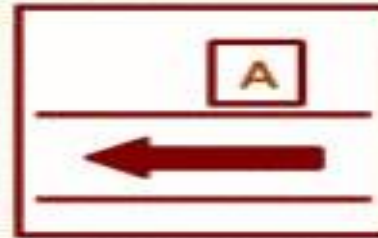

go past ...



cross

PREPOSITIONS OF PLACE



at the
corner of ...



next to



opposite



between

WHAT WORDS ARE MISSING?



GO _____
THE STREET



GO _____
ON _____



GO _____ THE
STREET



TURN _____
THE CORNER



TAKE THE
FIRST ROAD
ON THE



TAKE THE
FIRST ROAD
ON THE



TURN _____



TURN _____

WHAT WORDS ARE MISSING? Check your answers



GO along
THE STREET



GO straight
ON



GO up
THE STREET



TURN
around THE
CORNER



TAKE THE
FIRST ROAD
ON THE
left



TAKE THE
FIRST ROAD
ON THE
right



TURN right



TURN
left

DIALOGUE

Fill in the gaps:

-Excuse me, Can you _____ me the way to the post office?

- Sure, go _____ this street and _____ left at the crossroads. The post office is _____ the left.

-Thank you!

-You're welcome!

DIALOGUE Check!

Fill in the gaps:

-Excuse me, Can you ____tell____ me the way to the post office?

- Sure, go ____along____ this street and ____turn____ left at the crossroads. The post office is ____on____ the left.

-Thank you!

-You're welcome!

MY TOWN

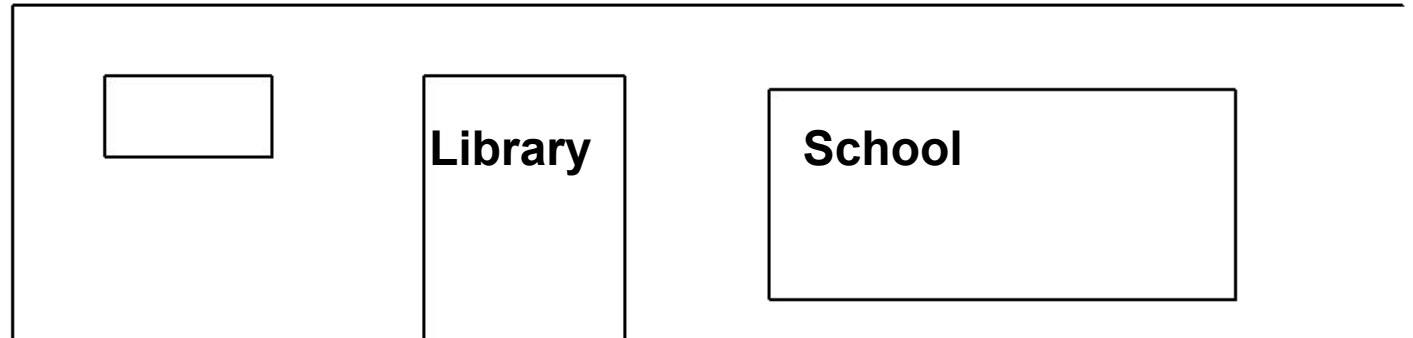
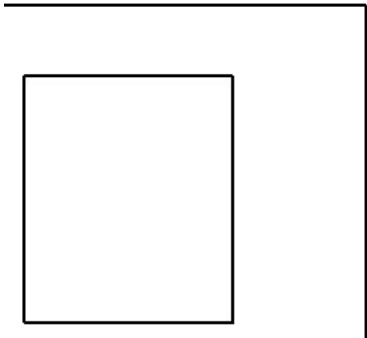
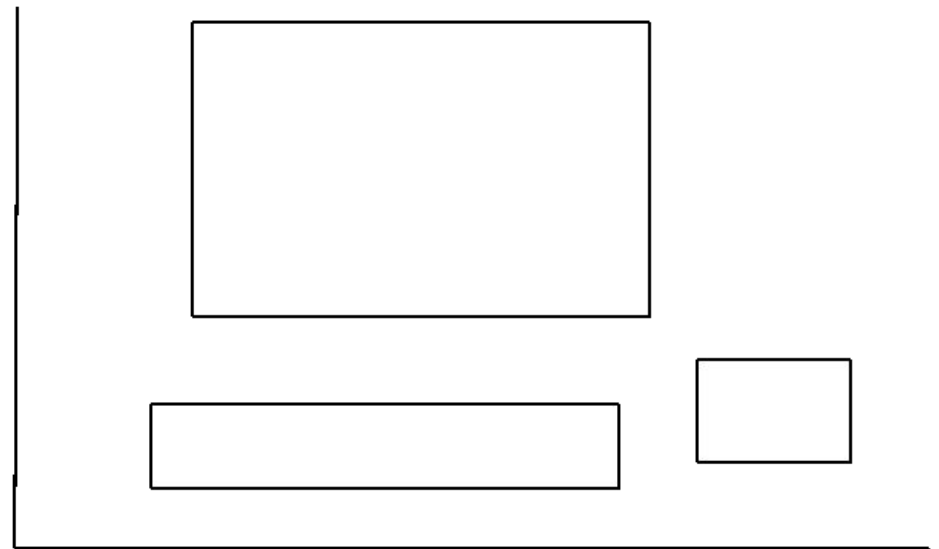
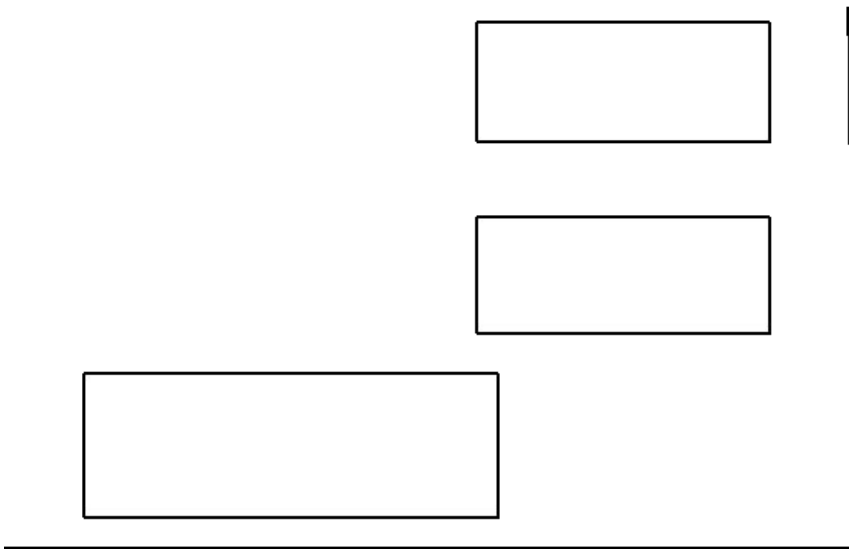

There is a library next to the school.

GIVING DIRECTIONS

- "Excuse me. How do I get to the library?"
- "OK. Go straight on. You will see a shop on the right. Go past that and it's on the right next to the shop.
You can't miss it!"
- "Thanks!"
- "You're welcome."

PLENARY

5- new words from the
lesson

5- prepositions

1-activity from the
lesson you like the
best